



Mercedes-Benz Dashcam

© 2019, Mercedes-Benz Customer Solutions GmbH,
Stuttgart · A Daimler AG Company.

Reprinting, translating and reproduction, in whole or in part, are not permitted
without our prior written consent.

2019/04



Mercedes-Benz

Key to symbols

WARNING

A warning notice informs you of possible risks to your health or life.

Environmental note

Daimler AG has committed itself to comprehensive protection of the environment.

The objectives are for the natural resources which form the basis of our existence on this planet to be used sparingly and in a manner which takes the requirements of both nature and humanity into account.

 Text marked in this way alerts you to the risk of possible material damage or malfunctions.

 Notes marked in this way contain useful tips and additional information.

▶ These items explain individual operating steps.

• Bullet lists present you with possible selections.

Congratulations on your new Mercedes-Benz Dashcam.

These Operating Instructions are valid for vehicles equipped with a Mercedes-Benz Dashcam. They provide important information and explain how to operate it.

The dashcam has been specially developed for use in road traffic and records the traffic situation during a journey.

Before you drive off for the first time, read these Operating Instructions carefully and familiarise yourself with the dashcam. For your own safety and for a longer service life of the device, please follow the instructions and warning notices in these Operating Instructions. Failing to do so may lead to damage to the vehicle and the dashcam as well as personal injury.

Mercedes-Benz is continuously updating its dashcam to the state of the art and therefore reserves the right to introduce changes in design, equipment and technical features. For this reason, you cannot base any claims on the illustrations or descriptions in these instructions.

Always keep this document in the vehicle. All documents should be passed on to the new owner if you sell the vehicle.

Should you have any further questions, please contact a Mercedes-Benz Service Centre.

Mercedes-Benz Customer Solutions GmbH
A Daimler Company

Safety	16	What should I do if	24
Safety notes	16	... the dashcam doesn't react?	24
Safety LED.....	16	Technical data	25
General notes.....	16	Length of recording	25
Overview	17	Monitoring times (parked mode)	25
Scope of delivery.....	17		
Details	17		
Accessories	18		
Preparing the cameras	18		
Removing/installing the camera	18		
Inserting/removing the micro SD card..	19		
Aligning the camera.....	19		
Control buttons for the front camera	20		
Deleting recordings	21		
Driving mode	21		
Recordings in infinite loop.....	21		
Event recordings	21		
Settings	21		
Parking mode	22		
Monitoring range of the sensors.....	22		
Recordings when movement is detected	22		
Event recordings	22		
Settings	22		
Establishing a Wi-Fi connection between an end device and the dashcam	23		
Encrypting Wi-Fi (initial installation)	23		
Authorising an end device and connecting to the dashcam	23		
Activating/deactivating spoken messages	24		
Web app	24		
Smartphone app „Mercedes-Benz Dashcam“	24		
Playing back recordings	24		
Playback on an end device	24		

Safety

Safety notes

WARNING

Your attention must always be focused on the traffic conditions.

As a driver, do not change settings on the dashcam while driving.

Stop the vehicle safely in accordance with traffic regulations if you wish to make changes to the settings of the dashcam. You may otherwise be distracted by the traffic conditions, cause an accident and injure yourself and others.



WARNING

Have the dashcam installed at a qualified specialist workshop.

Modifications to electronic components, their software or wiring could impair their function and/or the function of other networked components. In particular, systems relevant to safety could also be affected. As a result, these may no longer function properly and/or may jeopardise the operating safety of the vehicle. There is an increased risk of accident and injury. Please observe the relevant instructions in your vehicle Owner's Manual.

Never tamper with the wiring or electronic components or their software.

-  In some countries, operation of a dashcam or use of recordings may be restricted or may not be permitted at all. Therefore, please find out about the applicable regulations on video surveillance and data protection in the country concerned before using the cameras. If necessary, you can remove the cameras from the brackets. Stow them safely.



-  Do not use the live preview of the app as an aid whilst parking or during the journey.
-  Do not connect an electricity supply or end devices to the dashcam via the USB port. Otherwise, the dashcam and/or the connected end device could be damaged.

Safety LED

A white LED on the front and rear camera indicates that a recording is being made. The LED is visible from outside of the vehicle.

-  Observe the legal regulations of the country in which you wish to operate the dashcam. In some cases, the white safety LED may not be permissible. Please contact a qualified specialist workshop in such cases. Mercedes-Benz recommends that you use a Mercedes-Benz Service Centre.

General notes

-  Different sources of radiation, e.g. mobile phones may interfere with the dashcam. Keep the number of sources of radiation in the vehicle as low as possible.
-  If the dashcam and/or the vehicle interior become very hot or in extremely cold conditions, a safety mechanism switches the dashcam off.

Overview

Scope of delivery

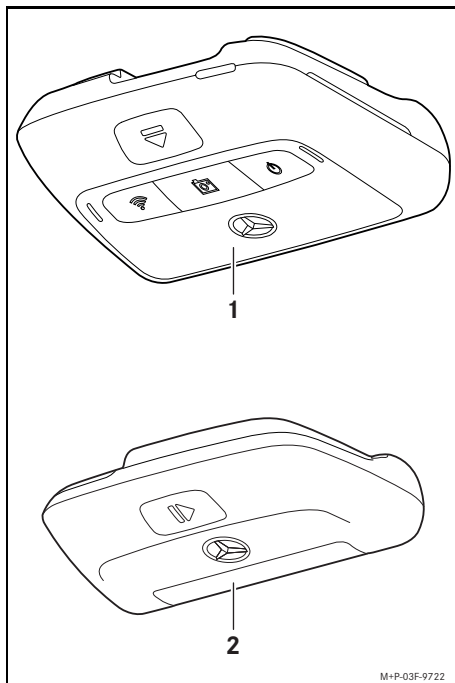

- (1) Front camera
- (2) Rear camera (optional; can only be operated in conjunction with the front camera)

- i** In as far as the rear camera is not included in your scope of delivery, you can purchase this from your Mercedes-Benz Service Centre at a later date.
- i** Have the rear camera retrofitted at a qualified specialist workshop. Mercedes-Benz recommends that you use a Mercedes-Benz Service Centre for this purpose.

Details

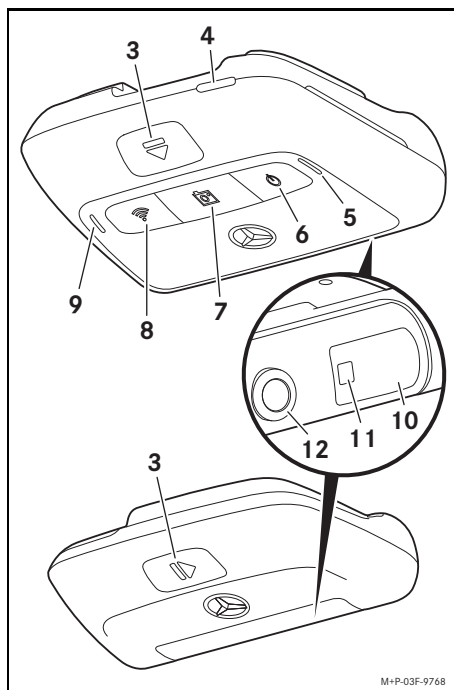

- (3) Button for unlocking and removing the camera from the bracket
- (4) Micro SD card slot
- (5) Speaker
- (6) On/off
- (7) Event recording
- (8) Wi-Fi
- (9) Microphone
- (10) Radar sensor system
- (11) Safety LED
- (12) Camera lens

Accessories

Micro SD card

A micro SD card is essential to operating the dashcam. This can be obtained from a Mercedes-Benz Service Centre or specialist store.

- i** Mercedes-Benz recommends that you use a Mercedes-Benz micro SD card.

Technical requirements:

- Storage capacity: 16 to 128 GB
- Speed rating: at least 10
- Write cycles: at least 10.000

Wi-Fi-capable end device

The dashcam is set via the web app or a smartphone; see page 24. You require a Wi-Fi-capable end device in order to be able to use this app.

- i** The apps also provide further additional functions.

Technical requirements:

- Wi-Fi standard in accordance with IEEE 802.11 b/g/n/ac
- Support for WPA2 encoding
- Apple® iOS or Android™ operating system¹

¹ Pre-requisite for the use of the smartphone app „Mercedes-Benz Dashcam“

Preparing the cameras

Removing/installing the camera

⚠ WARNING

Check that the cameras are securely attached before every journey. Re-install the cameras again if necessary. Do not use damaged cameras.

Incorrectly installed or damaged cameras can, for example, come loose in the event of hard braking or acceleration, a sudden change of direction or an accident and be thrown around, thereby injuring vehicle occupants.

- !** Once removed, store the camera in a clean location and secure it against being thrown around.

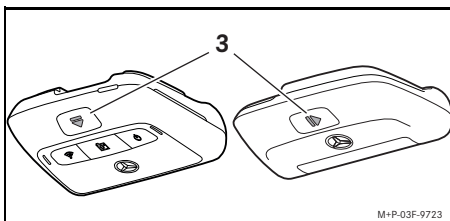

- **To remove:** Press button (3) and remove the camera from the bracket in the direction of the arrow.
- **To install:** slide the camera onto the bracket until it audibly engages.

Inserting/removing the micro SD card

DANGER

Micro SD cards are small parts. They can be swallowed and cause asphyxiation. This poses a risk of serious or even fatal injury. Store micro SD cards where children cannot reach them. If a micro SD card is swallowed, seek medical attention immediately.

Inserting a micro SD card

- ▶ Remove the front camera from the bracket; see page 18.

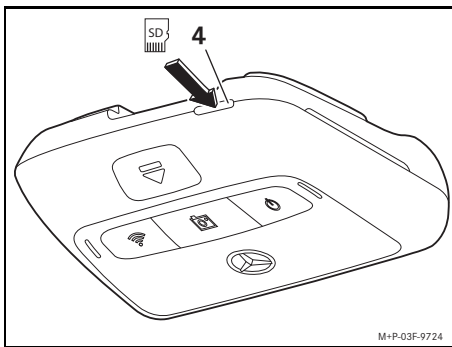

M+P-03F-9724

- ▶ Insert the micro SD card in to micro SD card slot (4) as illustrated until the micro SD card engages.

- ❗ The micro SD card may first have to be formatted before it can be used with the dashcam. In such a case, the status LED lights up red; see page 20.

Removing a micro SD card

- ❗ After removing the front camera, wait approximately 5 seconds so that the data can be stored on the micro SD card.
- ▶ Remove the front camera from the bracket; see page 18.
- ▶ Press the micro SD card. The micro SD card is ejected.
- ▶ Remove the micro SD card.

Aligning the camera



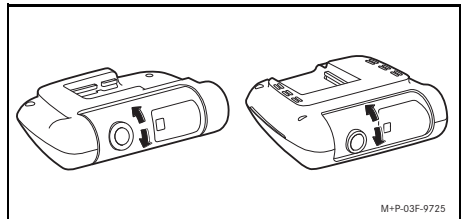





- ❗ Make sure that you do not touch the camera lens while aligning the camera. A dirty lens can affect the image quality.
- ▶ Authorise the end device and connect it with the dashcam; see page 23.
- ▶ Open the web app or the smartphone app; see page 24.
- ▶ Check the vertical alignment of the front camera using the live preview in the app.



M+P-03F-9725

- ▶ If required, correct the alignment of the front camera.
- ▶ If installed, also check the vertical alignment of the rear camera using the live preview in the app and adjust if necessary.
- i** Clean the camera lenses regularly with a soft, lint-free cloth and make sure you have a clean windscreen and rear window. Check the alignment of the cameras at regular intervals.

Control buttons for the front camera

	Function	Status LED
On/off 	<ul style="list-style-type: none"> ▶ <i>Press briefly</i>: switches the audio recording in the vehicle interior on/off Note: the selected setting will be retained the next time the engine is started. ▶ <i>Press for longer than 3 seconds</i>: switches the dashcam on/off Note: the dashcam is switched on automatically when the ignition is switched on. 	<p><i>Green (lights up)</i>: dashcam is switched on; recording is active (including audio recording)</p> <p><i>Orange (lights up)</i>: dashcam is switched on; recording is active (without audio recording)</p> <p><i>Green (flashing)/orange (flashing)</i>: recording has been temporarily interrupted due to a present configuration of the web app/ smartphone app</p> <p><i>Red (lights up)</i>: micro SD card requires formatting</p> <p><i>Red (flashing)</i>: error state</p> <p>Note: make sure that a suitable micro SD card is installed in the dashcam. If the system continues to show an error, please contact a Mercedes-Benz Service Centre to have the error resolved.</p>
Event 	<ul style="list-style-type: none"> ▶ <i>Press briefly</i>: triggers the event video ▶ <i>Press for longer than 3 seconds</i>: triggers an event photo 	<p><i>Orange (flashing)</i>: recording of an event video is active</p>
Wi-Fi 	<ul style="list-style-type: none"> ▶ <i>Press</i>: switches Wi-Fi on/off Note: Wi-Fi is only available in driving mode (ignition switched on) and is switched off automatically after 10 minutes. 	<p><i>Orange (lights up)</i>: Wi-Fi on</p> <p><i>Green (lights up)</i>: end device connected</p>
 +  + 	<ul style="list-style-type: none"> ▶ <i>Press all three buttons simultaneously for longer than 3 seconds</i>: formats the micro SD card Note: save all the data from your micro SD card before formatting in order to prevent data loss! 	
 + 	<ul style="list-style-type: none"> ▶ <i>Press both buttons simultaneously for longer than 6 seconds</i>: resets the dashcam to factory settings 	

Deleting recordings

- ❗ Save event recordings at regular intervals, particularly after an accident, parking bump or similar.

All recordings are saved on the micro SD card in the designated area. A difference is made between driving and parked mode and between automatic recordings and event recordings.

As soon as the relevant area is full, the oldest recording is overwritten by the most recent recording.

To manually delete recordings, the micro SD card must be formatted; see page 20. Then all areas of the micro SD card are deleted.

Driving mode

Recordings in infinite loop



As soon as the vehicle's ignition is switched on, the dashcam starts the video recording (front and rear camera) and the audio recording in the vehicle interior.

Furthermore, depending on the setting, the following data are recorded and saved using the sensor system installed in the dashcam:

- Speed/acceleration
- Date/time
- Location

- ❗ The save options are set via the web app or the smartphone app.

Event recordings

- ▶ **Automatically triggered event video:** if the sensor system in the dashcam detects a vibration
- ▶ **To manually trigger the event video:** Briefly press the  button.
- ▶ **To manually trigger the event photo:** press the  button for longer than 3 seconds.

Settings

⚠ WARNING

Sporty driving (car racing in particular) is only permitted on circuits intended for this purpose.

You could otherwise endanger yourself or other road users.

- ▶ Authorise the end device and connect it with the dashcam; see page 23.
- ▶ Open the web app or the smartphone app; see page 24.
- ▶ Open the settings menu.
- ▶ Select the setting and confirm:
 - recordings from the front and rear camera in infinite loop and recordings when vibrations are detected

Note: if no rear camera is installed, the front camera records at double the frame rate
 - Event recordings by the front and rear camera, only when vibrations are detected
 - Recordings by the front camera for sporty driving (with double the frame rate)

Note: rear camera and vibration sensor (automatic event recordings) are deactivated
- ❗ Manual event recordings are always possible regardless of the selected setting in driving mode.

Parking mode

! In order to maintain the vehicle's functionality and to protect the vehicle battery, radar monitoring and video analysis are initially switched off if necessary. If vibrations are detected, event recordings are continued, however this function may also be switched off at a later point in time in order to ensure the starting ability of your vehicle amongst other things.

Monitoring range of the sensors

If radar monitoring or video analysis is active, the area (several metres) in front of and to the rear of the vehicle is monitored. Monitoring of the area to the rear of the vehicle is only possible if the rear camera is installed.

Recordings when movement is detected

If a vehicle is parked and the ignition switched off, the cameras only record if the radar sensors or the video analysis detect movement in the area surrounding the vehicle.

In such cases, the dashcam records video footage (front and rear camera).

Furthermore, depending on the setting, the following data are recorded and saved using the sensor system installed in the dashcam:

- Speed/acceleration
- Date/time
- Location

i The save options are set via the web app or the smartphone app.

With the help of the radar sensors/video analysis, the cameras are also able to record the time prior to the incident.

Event recordings

- ▶ **Automatically triggered event video:** if the sensor system in the dashcam detects a vibration

Settings

- !** **Vehicles with infrared glazing/heated windscreen:** activate the video analysis for parked vehicle monitoring. Radar monitoring is not possible due to the characteristics of the vehicle's glazing.
- !** If the vehicle battery charge level is low, it is recommended to deactivate parked vehicle monitoring.
 - ▶ Authorise the end device and connect it with the dashcam; see page 23.
 - ▶ Open the web app or the smartphone app; see page 24.
 - ▶ Open the settings menu.
 - ▶ Select the setting and confirm:
 - Radar monitoring and recordings when movement is detected and recordings by the front and rear camera when vibrations are detected
 - Video analysis and recordings when movement is detected and recordings by the front and rear camera when vibrations are detected (duration of monitoring extremely curtailed)
 - Event recordings by the front and rear camera, only when vibrations are detected (longest period of monitoring)
 - Parked vehicle monitoring deactivated

Establishing a Wi-Fi connection between an end device and the dashcam

If you wish to use the functionality of the web app or the smartphone app, you must first authorise a Wi-Fi-compatible end device on the dashcam.

- i** Only one end device can be connected to the dashcam. It is not possible to connect several end devices with the dashcam simultaneously.

Encrypting Wi-Fi (initial installation)

! During initial installation, the Wi-Fi frequency of the dashcam is changed to 5 GHz. For older end devices it may be necessary to prevent this change, so that the dashcam and the end device use the Wi-Fi frequency 2.4 GHz.

! If the Wi-Fi password is lost, the dashcam must be reset to factory settings (see page 20) and initial installation must be carried out again.

i During initial installation, the operating language for the web app must be selected. The selected language is then adopted for the spoken messages issued by the dashcam. In order to change the operating language, the dashcam must be reset to the factory settings (see page 20) and the initial installation must be carried out again.

- ▶ Switch on the vehicle's ignition.
- ▶ Press the  button.
- ▶ Switch on the Wi-Fi on the end device and search for available Wi-Fi devices; see the operating instructions for the relevant end device.

A list of available Wi-Fi devices appears.

- ▶ „MB Dashcam XXXXXX“ should be selected from the list.

An unsecured Wi-Fi connection between the dashcam and the end device is established.

- ▶ In the Internet browser on the end device, open the **http://dash.cam** page. The Wi-Fi password is shown.
- ▶ Take note of/copy the Wi-Fi password shown and determine the system language before confirming. The dashcam is restarted.

Authorising an end device and connecting to the dashcam

! First carry out the initial installation; see page 23.

- ▶ Switch on the vehicle's ignition.
- ▶ Press the  button.
- ▶ Search for available Wi-Fi devices on the end device.

A list of available Wi-Fi devices appears.

- ▶ „MB Dashcam XXXXXX“ should be selected from the list.
- ▶ Enter the Wi-Fi password and confirm.

A secured Wi-Fi connection between the dashcam and the end device is established.

- i** For the duration of an active Wi-Fi connection between the end device and the dashcam, an Internet connection may not be available on the end device. Depending on the end device, the mobile data connection may also be deactivated. If necessary, switch off Wi-Fi on the dashcam; see page 20.

Activating/deactivating spoken messages

- ❗ Safety and function-relevant spoken messages, e.g. that no micro SD card is inserted, cannot be deactivated.
- ▶ Authorise the end device and connect it with the dashcam; see page 23.
- ▶ Open the web app or the smartphone app; see page 24.
- ▶ Open the settings menu.
- ▶ **To deactivate spoken messages:** select the lowest volume.
- ▶ **To activate spoken messages:** select a volume.

Web app

- ▶ Authorise the end device and connect it with the dashcam; see page 23.
- ▶ In the Internet browser on the end device, open the <http://dash.cam> page.

Smartphone app „Mercedes-Benz Dashcam“

To use the free smartphone app, it must first be installed on your Wi-Fi-enabled end device.

- ❗ Downloading may incur additional costs depending on your mobile phone contract. For more detailed information contact your mobile network provider.
- ▶ Open Apple® App Store or Google Play™¹ on the end device.
- ▶ Search for the „Mercedes-Benz Dashcam“ smartphone app and install it on the end device.
- ▶ Authorise the end device and connect it with the dashcam; see page 23.
- ▶ Open the „Mercedes-Benz Dashcam“ smartphone app.

¹ Google Play is a trademark of Google Inc.

Playing back recordings

Various options are available for the playback: It is possible to play back recordings on an end device² and via the web app or the smartphone app.

Playback on an end device

- ▶ Remove the micro SD card from the dashcam; see page 19.
- ▶ Insert the micro SD card into the end device²; see the operating instructions of the relevant end device.
- ▶ Select the micro SD card and start playback.

What should I do if...

... the dashcam doesn't react?

- ▶ Remove the front camera from the bracket; see page 18.
- ❗ After removing the front camera, wait approximately 5 seconds so that the data can be stored on the micro SD card.

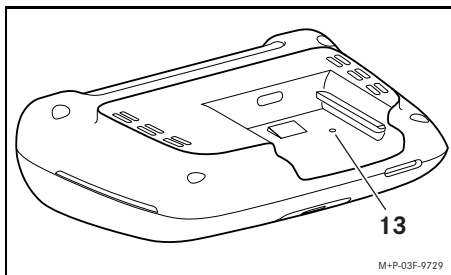

- ▶ Using a pointed object, press in indentation (13).
After sliding the front camera back onto the bracket, the camera is restarted.
- i Settings will not be lost.

² An adapter may be required in order that the micro SD card can be inserted into an end device.

Technical data

Resolution	Front: Full HD (1920 x 1080) Rear: Full HD (1920 x 1080)
Frame rate	30 fps (mode with front and rear camera) 60 fps (mode for sporty driving/mode without rear camera)
Aperture angle	Front: 131° (diagonal), 108° (horizontal), 69° (vertical) Rear: 153° (diagonal), 125° (horizontal), 65° (vertical)
Container	MPEG-4
Video codec	MPEG-4 AVC (H.264)
Audio codec	MPEG-4 AAC
Video length	Driving mode: approx. 1 minute, 150 MB Parked mode: approx. 20 seconds, 50 MB

Length of recording

Size of micro SD card	Driving mode (recordings in infinite loop)	Driving mode (event recordings)	Parked mode (recordings when movement is detected)	Parked mode (event recordings)
32 GB	approx. 132 minutes	approx. 44 minutes	approx. 22 minutes	approx. 11 minutes
64 GB	approx. 264 minutes	approx. 88 minutes	approx. 44 minutes	approx. 22 minutes

Monitoring times (parked mode)

Radar monitoring + event recordings in the event of vibrations	Video analysis + event recordings in the event of vibrations	Event recordings in the event of vibrations
<ul style="list-style-type: none"> • Radar monitoring up to 12 hours • After radar monitoring has been automatically deactivated up to 24 hours event recordings in the event of vibrations 	<ul style="list-style-type: none"> • Video analysis up to 30 minutes • After video analysis has been automatically deactivated up to 24 hours event recordings in the event of vibrations 	Up to 6 days of event recordings in the event of vibrations

i The monitoring time is shortened with every recording made.

i Notes on successive deactivation of monitoring; see page 22.

Key to symbols

WARNING

A warning notice informs you of possible risks to your health or life.

Environmental note

Daimler AG has committed itself to comprehensive protection of the environment.

The objectives are for the natural resources which form the basis of our existence on this planet to be used sparingly and in a manner which takes the requirements of both nature and humanity into account.

 Text marked in this way alerts you to the risk of possible material damage or malfunctions.

 Notes marked in this way contain useful tips and additional information.

- ▶ These items explain individual steps.
- Bullet lists present you with possible selections.

Congratulations on your new Mercedes-Benz Dashcam.

These Operating Instructions are valid for vehicles equipped with a Mercedes-Benz Dashcam. They provide important information and explain how to operate it.

The dashcam has been specially developed for use in road traffic and records the traffic situation during a journey.

Before you drive off for the first time, read these Operating Instructions carefully and familiarize yourself with the dashcam. For your own safety and for a longer service life of the device, please follow the instructions and warning notices in these Operating Instructions. Failing to do so may lead to damage to the vehicle and the dashcam as well as personal injury.

Mercedes-Benz is continuously updating its dashcam to the state of the art and therefore reserves the right to introduce changes in design, equipment and technical features. You cannot, therefore, base any claims on the illustrations or text content in these instructions.

Always keep this document in the vehicle. All documents should be passed on to the new owner if you sell the vehicle.

Should you have any further questions, please contact an authorized Mercedes-Benz Center.

Mercedes-Benz Customer Solutions GmbH
A Daimler Company

Safety	28	What should I do if...?	36
Safety notes	28	... the dashcam doesn't react?	36
Safety LED.....	28	Technical data	37
General notes.....	28	Length of recording	37
Overview	29	Monitoring times (parked mode)	37
Scope of delivery.....	29		
Details	29		
Accessories	30		
Preparing the cameras	30		
Removing/installing the camera	30		
Inserting/removing the micro SD card..	31		
Aligning the camera.....	31		
Control buttons for the front camera	32		
Deleting recordings	33		
Driving mode	33		
Recordings in infinite loop.....	33		
Event recordings	33		
Settings	33		
Parking mode	34		
Monitoring range of the sensors.....	34		
Recordings when movement is detected	34		
Event recordings	34		
Settings	34		
Establishing a Wi-Fi connection between an end device and the dashcam	35		
Encrypting Wi-Fi (initial installation)	35		
Authorizing an end device and connecting to the dashcam	35		
Activating/deactivating spoken messages	36		
Web app	36		
Smartphone app „Mercedes-Benz Dashcam“	36		
Playing back recordings	36		
Playback on an end device	36		

Safety

Safety notes

WARNING

Your attention must always be focused on the traffic conditions.

As a driver, do not change settings on the dashcam while driving.

Stop the vehicle safely in accordance with traffic regulations if you wish to make changes to the settings of the dashcam. You may otherwise be distracted from the traffic conditions, cause an accident and injure yourself and others.

WARNING

Have the dashcam installed at a qualified specialist workshop.

Modifications to electronic components, their software or wiring could impair their function and/or the function of other networked components. In particular, systems relevant to safety could also be affected. As a result, these may no longer function properly and/or may jeopardize the operating safety of the vehicle. There is an increased risk of accident and injury. Please observe the relevant instructions in your vehicle Owner's Manual.

Never tamper with the wiring or electronic components or their software.

! In some countries, operation of a dashcam or use of recordings may be restricted or may not be permitted at all. Therefore, please find out about the applicable regulations on video surveillance and data protection in the country concerned before using the cameras. If necessary, you can remove the cameras from the brackets. Stow them safely.

! Do not use the live preview of the app as an aid whilst parking or during the journey.

! Do not connect an electricity supply or end devices to the dashcam via the USB port. Otherwise, the dashcam and/or the connected end device could be damaged.

Safety LED

A white LED on the front and rear camera indicates that a recording is being made. The LED is visible from outside of the vehicle.

! Observe the legal regulations of the country in which you wish to operate the dashcam. In some cases, the white safety LED may not be permissible. Please contact a qualified specialist workshop in such cases. Mercedes-Benz recommends that you use an authorized Mercedes-Benz Center.

General notes

! Different sources of radiation, e.g. mobile phones may interfere with the dashcam. Keep the number of sources of radiation in the vehicle as low as possible.

! If the dashcam and/or the vehicle interior become very hot or in extremely cold conditions, a safety mechanism switches the dashcam off.

Overview

Scope of delivery

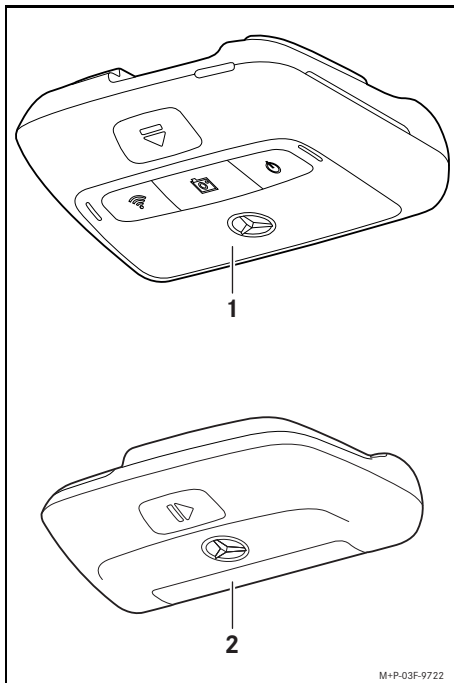

- (1) Front camera
- (2) Rear camera (optional; can only be operated in conjunction with the front camera)

- i** In as far as the rear camera is not included in your scope of delivery, you can purchase this from your authorized Mercedes-Benz Center at a later date.
- i** Have the rear camera retrofitted at a qualified specialist workshop. Mercedes-Benz recommends that you use an authorized Mercedes-Benz Center for this purpose.

Details

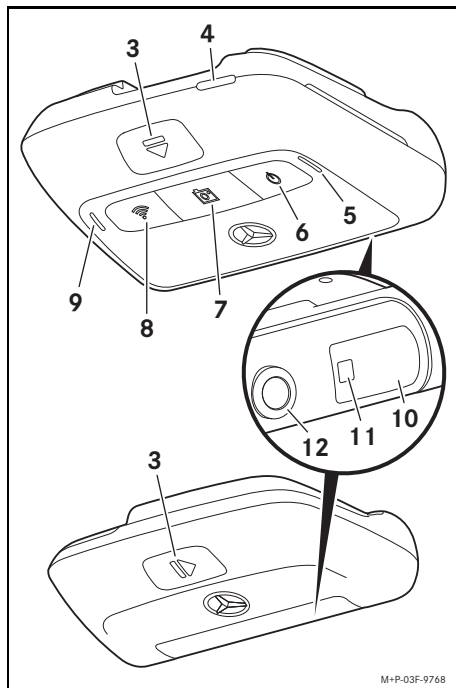

- (3) Button for unlocking and removing the camera from the bracket
- (4) Micro SD card slot
- (5) Speaker
- (6) On/off
- (7) Event recording
- (8) Wi-Fi
- (9) Microphone
- (10) Radar sensor system
- (11) Safety LED
- (12) Camera lens

Accessories

Micro SD card

A micro SD card is essential to operating the dashcam. This can be obtained from an authorized Mercedes-Benz Center or specialist store.

- i** Mercedes-Benz recommends that you use a Mercedes-Benz micro SD card.

Technical requirements:

- Storage capacity: 16 to 128 GB
- Speed rating: at least 10
- Write cycles: at least 10,000

Wi-Fi-capable end device

The dashcam is set via the web app or a smartphone; see page 36. You require a Wi-Fi-capable end device in order to be able to use this app.

- i** The apps also provide further additional functions.

Technical requirements:

- Wi-Fi standard in accordance with IEEE 802.11 b/g/n/ac
- Support for WPA2 encoding
- Apple® iOS or Android™ operating system¹

¹ Pre-requisite for the use of the smartphone app „Mercedes-Benz Dashcam“

Preparing the cameras

Removing/installing the camera

WARNING

Check that the cameras are securely attached before every journey. Re-install the cameras again if necessary. Do not use damaged cameras.

Incorrectly installed or damaged cameras can, for example, come loose in the event of hard braking or acceleration, a sudden change of direction or an accident and be thrown around, thereby injuring vehicle occupants.

- !** Once removed, store the camera in a clean location and secure it against being thrown around.

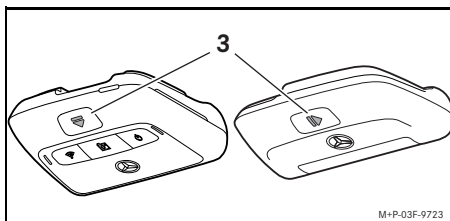

- ▶ **To remove:** press button (3) and remove the camera from the bracket in the direction of the arrow.
- ▶ **To install:** slide the camera onto the bracket until it audibly engages.

Inserting/removing the micro SD card

DANGER

Micro SD cards are small parts. They can be swallowed and cause asphyxiation. This poses a risk of serious or even fatal injury. Store micro SD cards where children cannot reach them. If a micro SD card is swallowed, seek medical attention immediately.

Inserting a micro SD card

- ▶ Remove the front camera from the bracket; see page 30.

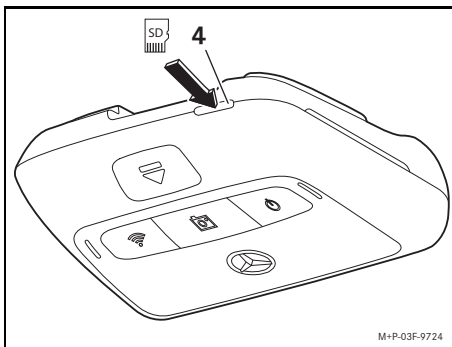

- ▶ Insert the micro SD card in to micro SD card slot (4) as illustrated until the micro SD card engages.

- ! The micro SD card may first have to be formatted before it can be used with the dashcam. In such a case, the status LED lights up red; see page 32.

Removing a micro SD card

- ! After removing the front camera, wait approximately 5 seconds so that the data can be stored on the micro SD card.
- ▶ Remove the front camera from the bracket; see page 30.
- ▶ Press the micro SD card. The micro SD card is ejected.
- ▶ Remove the micro SD card.





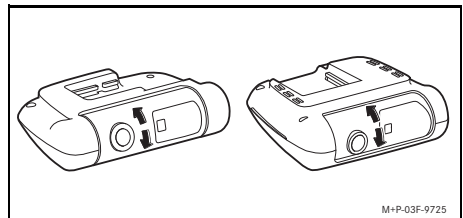



Aligning the camera

- ! Make sure that you do not touch the camera lens while aligning the camera. A dirty lens can affect the image quality.
- ▶ Authorize the end device and connect it with the dashcam; see page 35.
- ▶ Open the web app or the smartphone app; see page 36.
- ▶ Check the vertical alignment of the front camera using the live preview in the app.



- ▶ If required, correct the alignment of the front camera.
- ▶ If installed, also check the vertical alignment of the rear camera using the live preview in the app and adjust if necessary.
- i Clean the camera lenses regularly with a soft, lint-free cloth and make sure you have a clean windscreen and rear window. Check the alignment of the cameras at regular intervals.

Control buttons for the front camera

	Function	Status LED
On/off 	<ul style="list-style-type: none"> ▶ <i>Press briefly</i>: switches the audio recording in the vehicle interior on/off Note: the selected setting will be retained the next time the engine is started. ▶ <i>Press for longer than 3 seconds</i>: switches the dashcam on/off Note: the dashcam is switched on automatically when the ignition is switched on. 	<p><i>Green (lights up)</i>: dashcam is switched on; recording is active (including audio recording)</p> <p><i>Orange (lights up)</i>: dashcam is switched on; recording is active (without audio recording)</p> <p><i>Green (flashing)/orange (flashing)</i>: recording has been temporarily interrupted due to a present configuration of the web app/ smartphone app</p> <p><i>Red (lights up)</i>: micro SD card requires formatting</p> <p><i>Red (flashing)</i>: error state</p> <p>Note: make sure that a suitable micro SD card is installed in the dashcam. If the system continues to show an error, please contact an authorized Mercedes-Benz Center to have the error resolved.</p>
Event 	<ul style="list-style-type: none"> ▶ <i>Press briefly</i>: triggers the event video ▶ <i>Press for longer than 3 seconds</i>: triggers an event photo 	<p><i>Orange (flashing)</i>: recording of an event video is active</p>
Wi-Fi 	<ul style="list-style-type: none"> ▶ <i>Press</i>: switches Wi-Fi on/off Note: Wi-Fi is only available in driving mode (ignition switched on) and is switched off automatically after 10 minutes. 	<p><i>Orange (lights up)</i>: Wi-Fi on</p> <p><i>Green (lights up)</i>: end device connected</p>
 +  + 	<ul style="list-style-type: none"> ▶ <i>Press all three buttons simultaneously for longer than 3 seconds</i>: formats the micro SD card Note: save all the data from your micro SD card before formatting in order to prevent data loss! 	
 + 	<ul style="list-style-type: none"> ▶ <i>Press both buttons simultaneously for longer than 6 seconds</i>: resets the dashcam to factory settings 	

Deleting recordings

- ! Save event recordings at regular intervals, particularly after an accident, parking bump or similar.

All recordings are saved on the micro SD card in the designated area. A difference is made between driving and parked mode and between automatic recordings and event recordings.

As soon as the relevant area is full, the oldest recording is overwritten by the most recent recording.

To manually delete recordings, the micro SD card must be formatted; see page 32. Then all areas of the micro SD card are deleted.

Driving mode

Recordings in infinite loop



As soon as the vehicle's ignition is switched on, the dashcam starts the video recording (front and rear camera) and the audio recording in the vehicle interior.

Furthermore, depending on the setting, the following data are recorded and saved using the sensor system installed in the dashcam:

- Speed/acceleration
- Date/time
- Location

- i The save options are set via the web app or the smartphone app.

Event recordings

- ▶ **Automatically triggered event video:** if the sensor system in the dashcam detects a vibration
- ▶ **To manually trigger the event video:** Briefly press the  button.
- ▶ **To manually trigger the event photo:** press the  button for longer than 3 seconds.

Settings

WARNING

Sporty driving (car racing in particular) is only permitted on circuits intended for this purpose.

You could otherwise endanger yourself or other road users.

- ▶ Authorize the end device and connect it with the dashcam; see page 35.
- ▶ Open the web app or the smartphone app; see page 36.
- ▶ Open the settings menu.
- ▶ Select the setting and confirm:
 - recordings from the front and rear camera in infinite loop and recordings when vibrations are detected
 - Note:** if no rear camera is installed, the front camera records at double the frame rate
 - Event recordings by the front and rear camera, only when vibrations are detected
 - Recordings by the front camera for sporty driving (with double the frame rate)
 - Note:** rear camera and vibration sensor (automatic event recordings) are deactivated
- i Manual event recordings are always possible regardless of the selected setting in driving mode.

Parking mode

! In order to maintain the vehicle's functionality and to protect the vehicle battery, radar monitoring and video analysis are initially switched off if necessary. If vibrations are detected, event recordings are continued, however this function may also be switched off at a later point in time in order to ensure the starting ability of your vehicle amongst other things.

Monitoring range of the sensors

If radar monitoring or video analysis is active, the area (several meters) in front of and to the rear of the vehicle is monitored. Monitoring of the area to the rear of the vehicle is only possible if the rear camera is installed.

Recordings when movement is detected

If a vehicle is parked and the ignition switched off, the cameras only record if the radar sensors or the video analysis detect movement in the area surrounding the vehicle.

In such cases, the dashcam records video footage (front and rear camera).

Furthermore, depending on the setting, the following data are recorded and saved using the sensor system installed in the dashcam:

- Speed/acceleration
- Date/time
- Location

i The save options are set via the web app or the smartphone app.

With the help of the radar sensors/video analysis, the cameras are also able to record the time prior to the incident.

Event recordings

- ▶ **Automatically triggered event video:** if the sensor system in the dashcam detects a vibration

Settings

- !** **Vehicles with infrared glazing/heated windscreen:** activate the video analysis for parked vehicle monitoring. Radar monitoring is not possible due to the characteristics of the vehicle's glazing.
- !** If the vehicle battery charge level is low, it is recommended to deactivate parked vehicle monitoring.
 - ▶ Authorize the end device and connect it with the dashcam; see page 35.
 - ▶ Open the web app or the smartphone app; see page 36.
 - ▶ Open the settings menu.
 - ▶ Select the setting and confirm:
 - Radar monitoring and recordings when movement is detected and recordings by the front and rear camera when vibrations are detected
 - Video analysis and recordings when movement is detected and recordings by the front and rear camera when vibrations are detected (duration of monitoring extremely curtailed)
 - Event recordings by the front and rear camera, only when vibrations are detected (longest period of monitoring)
 - Parked vehicle monitoring deactivated

Establishing a Wi-Fi connection between an end device and the dashcam

If you wish to use the functionality of the web app or the smartphone app, you must first authorize a Wi-Fi-compatible end device on the dashcam.

- i** Only one end device can be connected to the dashcam. It is not possible to connect several end devices with the dashcam simultaneously.

Encrypting Wi-Fi (initial installation)

! During initial installation, the Wi-Fi frequency of the dashcam is changed to 5 GHz. For older end devices it may be necessary to prevent this change, so that the dashcam and the end device use the Wi-Fi frequency 2.4 GHz.

! If the Wi-Fi password is lost, the dashcam must be reset to factory settings (see page 32) and initial installation must be carried out again.

i During initial installation, the operating language for the web app must be selected. The selected language is then adopted for the spoken messages issued by the dashcam. In order to change the operating language, the dashcam must be reset to the factory settings (see page 32) and the initial installation must be carried out again.

- ▶ Switch on the vehicle's ignition.
- ▶ Press the  button.
- ▶ Switch on the Wi-Fi on the end device and search for available Wi-Fi devices; see the operating instructions for the relevant end device.

A list of available Wi-Fi devices appears.

- ▶ „MB Dashcam XXXXXX“ should be selected from the list.

An unsecured Wi-Fi connection between the dashcam and the end device is established.

- ▶ In the Internet browser on the end device, open the **http://dash.cam** page. The Wi-Fi password is shown.
- ▶ Take note of/copy the Wi-Fi password shown and determine the system language before confirming. The dashcam is restarted.

Authorizing an end device and connecting to the dashcam

! First carry out the initial installation; see page 35.

- ▶ Switch on the vehicle's ignition.
- ▶ Press the  button.
- ▶ Search for available Wi-Fi devices on the end device.

A list of available Wi-Fi devices appears.

- ▶ „MB Dashcam XXXXXX“ should be selected from the list.
- ▶ Enter the Wi-Fi password and confirm.

A secured Wi-Fi connection between the dashcam and the end device is established.

- i** For the duration of an active Wi-Fi connection between the end device and the dashcam, an Internet connection may not be available on the end device. Depending on the end device, the mobile data connection may also be deactivated. If necessary, switch off Wi-Fi on the dashcam; see page 32.

Activating/deactivating spoken messages

- ❗ Safety and function-relevant spoken messages, e.g. that no micro SD card is inserted, cannot be deactivated.
- ▶ Authorize the end device and connect it with the dashcam; see page 35.
- ▶ Open the web app or the smartphone app; see page 36.
- ▶ Open the settings menu.
- ▶ **To deactivate spoken messages:** select the lowest volume.
- ▶ **To activate spoken messages:** select a volume.

Web app

- ▶ Authorize the end device and connect it with the dashcam; see page 35.
- ▶ In the Internet browser on the end device, open the <http://dash.cam> page.

Smartphone app „Mercedes-Benz Dashcam“

To use the free smartphone app, it must first be installed on your Wi-Fi-enabled end device.

- ❗ Downloading may incur additional costs depending on your mobile phone contract. For more detailed information contact your mobile network provider.
- ▶ Open Apple® App Store or Google Play™¹ on the end device.
- ▶ Search for the „Mercedes-Benz Dashcam“ smartphone app and install it on the end device.
- ▶ Authorize the end device and connect it with the dashcam; see page 35.
- ▶ Open the „Mercedes-Benz Dashcam“ smartphone app.

¹ Google Play is a trademark of Google Inc.

Playing back recordings

Various options are available for the playback: It is possible to play back recordings on an end device² and via the web app or the smartphone app.

Playback on an end device

- ▶ Remove the micro SD card from the dashcam; see page 31.
- ▶ Insert the micro SD card into the end device²; see the operating instructions of the relevant end device.
- ▶ Select the micro SD card and start playback.

What should I do if...?

... the dashcam doesn't react?

- ▶ Remove the front camera from the bracket; see page 30.
- ❗ After removing the front camera, wait approximately 5 seconds so that the data can be stored on the micro SD card.

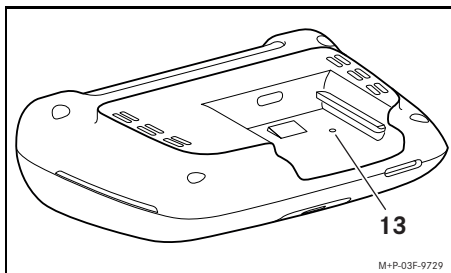

- ▶ Using a pointed object, press in indentation (13).
After sliding the front camera back onto the bracket, the camera is restarted.
- i Settings will not be lost.

² An adapter may be required in order that the micro SD card can be inserted into an end device.

Technical data

Resolution	Front: Full HD (1920 x 1080) Rear: Full HD (1920 x 1080)
Frame rate	30 fps (mode with front and rear camera) 60 fps (mode for sporty driving/mode without rear camera)
Aperture angle	Front: 131° (diagonal), 108° (horizontal), 69° (vertical) Rear: 153° (diagonal), 125° (horizontal), 65° (vertical)
Container	MPEG-4
Video codec	MPEG-4 AVC (H.264)
Audio codec	MPEG-4 AAC
Video length	Driving mode: approx. 1 minute, 150 MB Parked mode: approx. 20 seconds, 50 MB

Length of recording

Size of micro SD card	Driving mode (recordings in infinite loop)	Driving mode (event recordings)	Parked mode (recordings when movement is detected)	Parked mode (event recordings)
32 GB	approx. 132 minutes	approx. 44 minutes	approx. 22 minutes	approx. 11 minutes
64 GB	approx. 264 minutes	approx. 88 minutes	approx. 44 minutes	approx. 22 minutes

Monitoring times (parked mode)

Radar monitoring + event recordings in the event of vibrations	Video analysis + event recordings in the event of vibrations	Event recordings in the event of vibrations
<ul style="list-style-type: none"> • Radar monitoring up to 12 hours • After radar monitoring has been automatically deactivated up to 24 hours event recordings in the event of vibrations 	<ul style="list-style-type: none"> • Video analysis up to 30 minutes • After video analysis has been automatically deactivated up to 24 hours event recordings in the event of vibrations 	Up to 6 days of event recordings in the event of vibrations

i The monitoring time is shortened with every recording made.

i Notes on successive deactivation of monitoring; see page 34.