

P35.20-2057-09





Illustrated on left side

- 2 Camber strut
- 3 Torque strut
- 4 Tie rod
- 5 Thrust arm
- 6 Spring control arm
- 6k Torsion bar connecting rod
- 7 Wheel carrier
- 37 Rear axle shaft
- 40 Twelve-point collar nut
- 61 Brake disk
- 103 Brake shoes of parking brake
- L6/3 Left rear rpm sensor

Modification notes

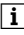
| | | | |
|--------|--|-----------|--|
| 2.5.07 | Self-locking nut, strut rod to wheel carrier, M12 | Model 209 | |
| 3.5.07 | Self-locking nut, tie rod to wheel carrier, silver or blue M10x1,5 | | |

| Icons | Remove/install | | |
|-------|---|--|--|
| | Danger! | Risk of death caused by vehicle slipping or toppling off the lifting platform. | Align vehicle between columns of vehicle lift and position four support plates at vehicle lift support points specified by vehicle manufacturer. |
| | | Notes on self-locking nuts and bolts | AS00.00-Z-0010-01A |
| | Installation | Only tighten nuts and bolts of chassis components when vehicle is in a ready-to-drive condition. | AH00.00-N-0001-01A |
| 1 | Detach twelve-point nut (40) of rear axle shaft | Nm | AR35.30-P-0115-01A *BA35.30-P-1001-01A |
| 2 | Secure vehicle on the lifting platform | | |
| 3 | Remove brake shoes of parking brake (103) | | AR42.20-P-0530A |
| 4 | Remove link rod (6k) of stabilizer bar | Nm Nm | AR32.30-P-0630-01P *BA32.20-P-1001-04C *BA32.20-P-1005-04C |
| 5 | Detach brake cable from wheel carrier (7) | Nm | *BA42.20-P-1002-01A |
| 6 | Detach rear rpm sensor from wheel carrier (7) | Nm | *BA42.30-P-1001-02A |
| 7 | Detach camber strut (2) from wheel carrier (7). | | AR35.20-P-0110P |
| 8 | Remove torque strut (3) from wheel carrier (7) | | Vehicles without code (P98) Black Series: AR35.20-P-0111P Vehicles with code (P98) Black Series: AR35.20-P-0111QBS |

| | | | |
|----|--|---|---|
| 9 | Detach tie rod (4) from wheel carrier (7) | Vehicles without code (P98) Black Series Vehicles with code (P98) Black Series | AR35.20-P-0112P AR35.20-P-0109QBS |
| 10 | Remove thrust arm (5) from wheel carrier (7) | | AR35.20-P-0113P |
| 11 | Press rear axle shaft (37) out of wheel carrier (7) | <p> Do not damage pulse ring for rpm sensor or sleeve.</p> <p> If the rear axle shaft (37) is difficult to remove:</p> <p style="text-align: center;">↓</p> <p>Press rear axle shaft (37) out of wheel carrier (7).</p> <p></p> <p></p> | AR35.30-P-0115-03BF *210589034300 *210589014000 |
| 12 | Remove bolt securing spring control arm (6) to wheel carrier (7) and pull wheel carrier (7) upward out of spring control arm (6) | Vehicles without code (P98) Black Series Vehicles with code (P98) Black Series  Installation: Do not damage the supporting joint boot when moving in the wheel carrier (7). | AR35.20-P-0111P AR35.20-P-0111QBS |
| 13 | Install in the reverse order | | |
| 14 | Adjust parking brake | | AR42.20-P-0540A |

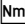
 **Rear axle shaft**

| Number | Designation | Model 203 | Model 209 except 209.377/477, model 209 without code P98 | Model 209.377/477, model 209 with code P98 |
|--------------------|---|------------------------|--|--|
| BA35.30-P-1001-01A | Collar nut, rear axle shaft to rear axle shaft flange | Stage 1 Nm | 220 | 320 |
| | | Stage 2 Δ° | - | - |

 **Parking brake**

| Number | Designation | Nm | Model 203 | Model 209 |
|--------------------|--|----|-----------|-----------|
| BA42.20-P-1002-01A | Self-locking bolt, brake cable at rear wheel carrier | Nm | 20 | 20 |

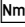
 **Rear axle stabilizer bar**

| Number | Designation | Nm | Model 203 | Model 209 |
|--------------------|---------------------------------|----|-----------|-----------|
| BA32.20-P-1001-04C | Nut, link rod to stabilizer bar | Nm | 40 | 40 |
| BA32.20-P-1005-04C | Bolt, link rod to wheel carrier | Nm | 40 | 50 |

 **Rear axle rpm sensor**

| Number | Designation | Model 203 | Model 209 |
|--------|-------------|-----------|-----------|
| | | | |

| | | | |
|--------------------|--|----|---|
| BA42.30-P-1001-02A | Self-locking bolt of rear axle rpm sensor to wheel carrier | Nm | 8 |
|--------------------|--|----|---|

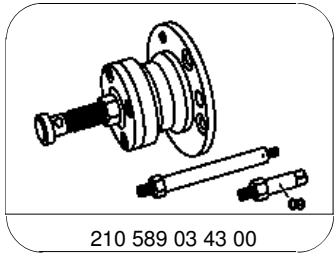

Extraction and insertion tool

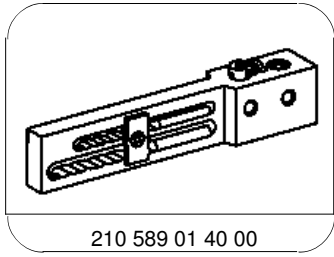

Bracket