

AR72.10-P-1000LW	Remove/install front door lining	03.08.2016
------------------	----------------------------------	------------

Model	205
Model	213
Model	253

P72.10-4436-09

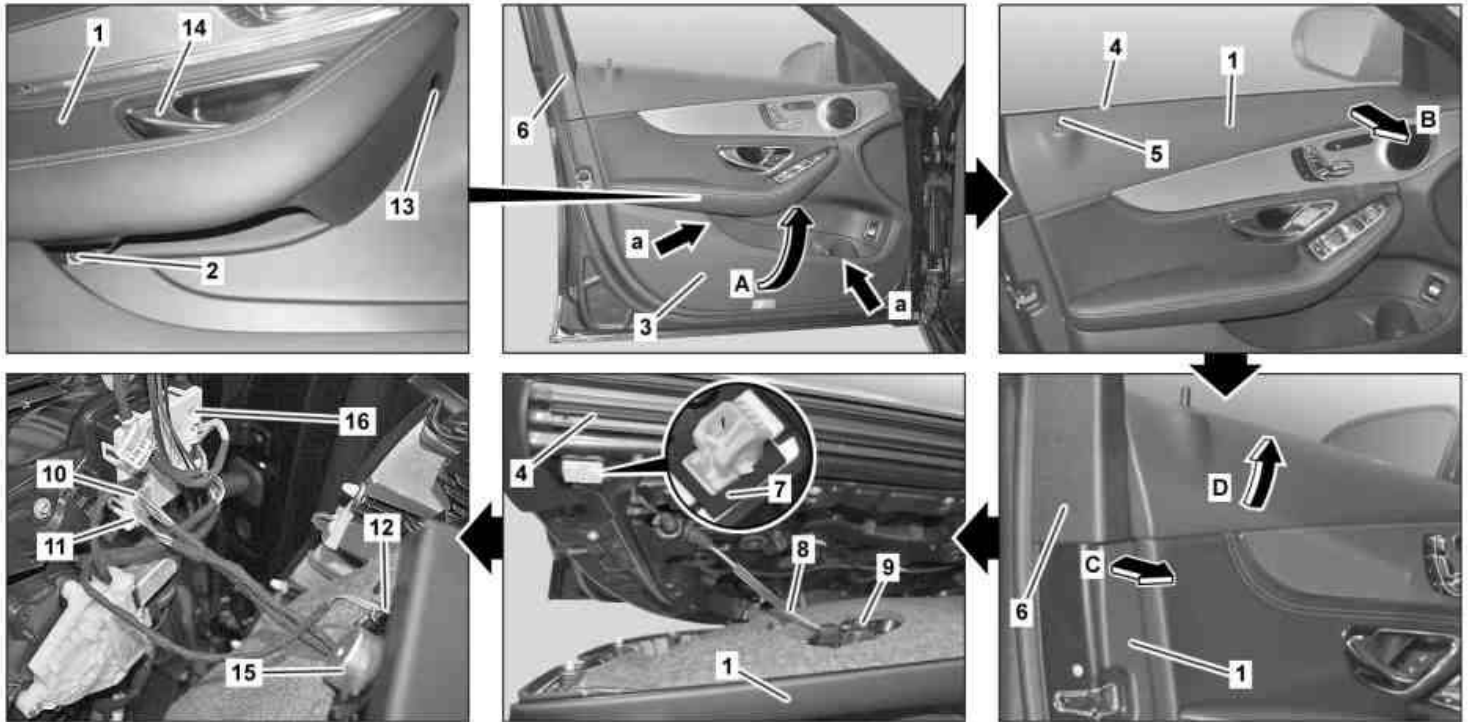

Shown on model 205.0

1	Door lining	7	Mounting clip	13	Bolt (model 205.0/1/2, 213, 253)
2	Screw	8	Inside door opener cable	14	Door handle
3	Door pocket	9	Support	15	Speaker
4	Inner sealing rail	10	Electrical connector	16	Front door control unit
5	Release button	11	Electrical connector		
6	Window frame paneling	12	Electrical connector		

Model 205.4

1	Door lining
20	Cover
21	Screw

P72.10-4550-04

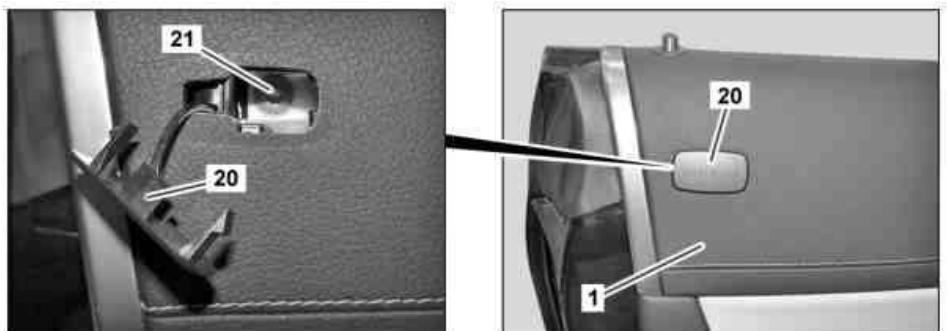

Model 213

1	Door lining
17	Cover
18	Adjusting unit
19	Cover

P72.10-4515-06

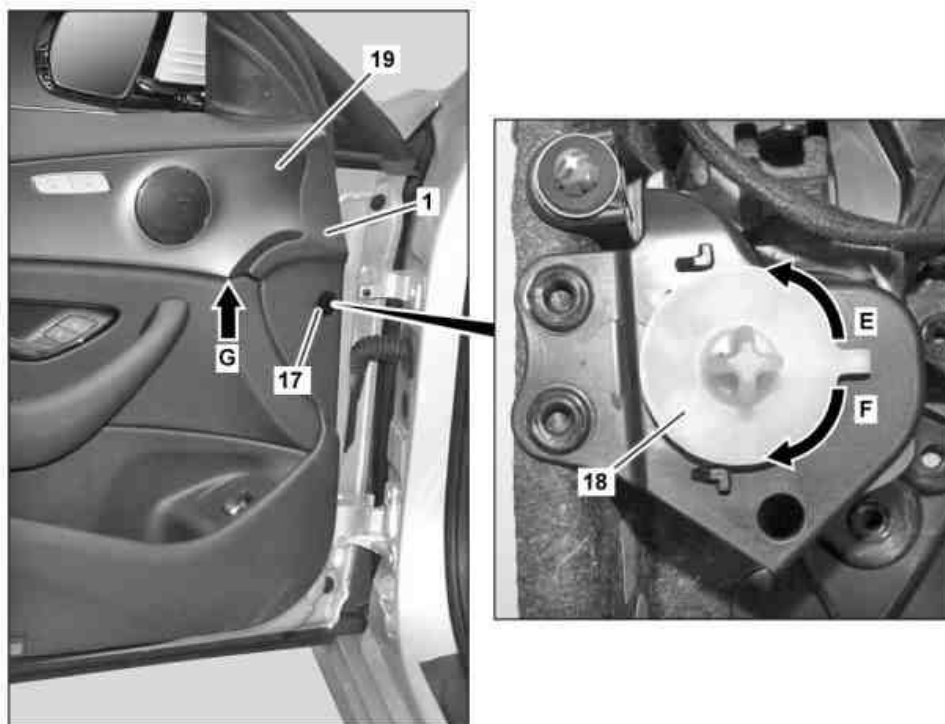

	<b>Danger</b> Risk of injury during testing and repair operations related to pyrotechnical components	Do not expose pyrotechnical components to temperatures above 100 °C or 212 °F. Disconnect current supply when working on such components. Model 205.4	Risk of injury during testing and repair operations related to pyrotechnical components
	<b>Danger</b> Risk of injury caused by fingers being jammed or pinched when removing, installing or aligning hoods, doors, trunk lid/rear-end door or sliding roof.	No parts of the body or limbs should be within the operating area when the components are moving.	Risk of injury caused by fingers being jammed or pinched when removing, installing or aligning hoods, doors, trunk lid/rear-end door or sliding roof.
	Information on preventing damage to electronic components due to electrostatic discharge		Information on preventing damage to electronic components due to electrostatic discharge
	Information, assessment and legal requirements when working with, handling and storing pyrotechnical components	Model 205.4	Information, assessment and legal requirements when working with, handling and storing pyrotechnical components
	Remove/install		
1	Completely open front door		
2	Move side window to lowest position		
3	Switch off ignition and store transmitter key outside of transmission range (min. 2 m)		
4	Unscrew bolt (2)		
5.1	Remove screw/bolt (13)	Model 205.0/1/2 Model 213 Model 253	
5.2	Remove cap in area of door handle (14) with a suitable tool and unscrew bolt below it	Model 205.3/4	
5.3	Remove cover (20) and unscrew bolt (21) below	Model 205.4	
		Mounting wedge	*110589035900

6	Reach into outer area (arrows a) of door pocket (3) on left and right and detach door lining (1) from front door by pulling with a jerk	⚠ Detach door lining (1) by hand. The door lining (1) can be damaged when using the assembly wedge.	
		ℹ Ensure that the front door is held in open position when pulling. Helper required.	
7	Unclip remaining retaining clips on door lining (1) up to inner sealing rail (4) (arrow A)		
8	Carefully remove door lining (1) from inner sealing rail (4) up to height of release button (5) (arrow B) starting at front		
9	Carefully lift door lining (1) off of front door (arrow C) in area of door lock in direction of arrow (arrow D) until it can be pushed upward over window frame paneling (6) and removed from retaining clip (7) or retaining clip (7) detaches from the inner front door panel		
10	Remove door lining (1) from front door until electrical connectors (10, 11) and inside door opener wire (8) are accessible		
11	Unhook wire of inside door opener (8) from mount (9)		
12	Release and disconnect electrical connectors (10, 11) from front door control unit (16)		
13	Release and disconnect electrical connection (12) from speaker (15)		
14	Remove door lining (1) and check retaining clip (7) for damage	ℹ Installation: If the retaining clip (7) remains in the front door when removing, remove retaining clip (7) and push into corresponding bracket of door lining (1). for damage	
		↓	
		Replace retaining clip (7)	
15	Install in the reverse order		
⚠	Check		
16	Check junction between lower edge (arrow G) of cover (19) and trim piece of instrument panel	Model 213	
		If complaint present	
		↓	
		Remove cover (17) and adjust junction by twisting (arrow E, F) adjusting unit (18)	

Mounting wedge

110 589 03 59 00

