

AR72.12-P-1010LW	Remove/install rear door lining	22.12.2016
------------------	---------------------------------	------------

Model	205.0/1/2
Model	213
Model	253

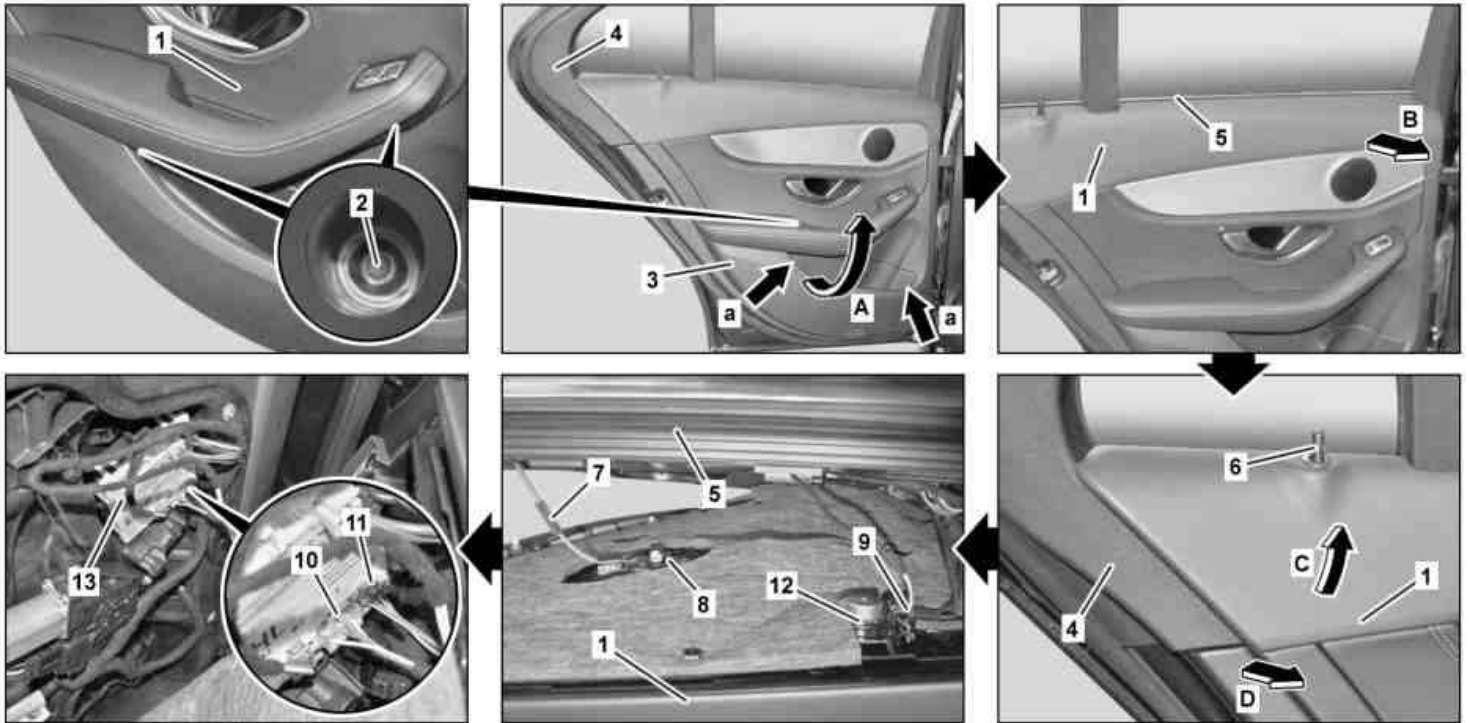



P72.12-3047-09



Shown on model 205.0 except code 810 (Sound-System)

1	Door trim	6	Release button	11	Electrical connector
2	Screw	7	Inside door opener cable	12	Speaker
3	Door pocket	8	Inner door handle	13	Rear door control unit
4	Window frame paneling	9	Electrical connector		
5	Inner sealing rail	10	Electrical connector		

⚠ Danger	Risk of injury caused by fingers being jammed or pinched when removing, installing or aligning hoods, doors, trunk lid/rear-end door or sliding roof.	No parts of the body or limbs should be within the operating area when the components are moving.	⚠ Risk of injury caused by fingers being jammed or pinched when removing, installing or aligning hoods, doors, trunk lid/rear-end door or sliding roof.
⚡	Information on preventing damage to electronic components due to electrostatic discharge		⚡ Information on preventing damage to electronic components due to electrostatic discharge
🚫🚫	Remove/install		
1	Completely open rear door		
2	Unscrew bolts (2)		
3	Reach into outer area (arrows a) of door pocket (3) on left and right and detach door lining (1) from rear door by pulling with a jerk	⚠ Detach door trim (1) by hand. The door trim (1) can be damaged when using a tool.	
		ⓘ Ensure that the rear door is held in open position when pulling. Helper required.	
4	Unclip retaining clips on door trim (1) up to inner sealing rail (5) (arrow A)		
5.1	Remove roller sun blind from drive	Model 213.1	

		with code 297 (Roller sun blinds in rear doors)
		 Detach/attach roller sun blind at drive
5.2	Move side window to lowest position	Model 205.0/1/2, 213 (except 213.1), 253 Model 213.1 except code 297 (Roller sun blinds in rear doors)
6	Switch off ignition	
7	Carefully remove door trim (1) from inner sealing rail (5) up to height of release button (6) (arrow B) starting at front	 Carefully pull out door trim (1). Otherwise the door trim (1) or the inner sealing rail (5) can be damaged.
8	Remove door trim (1) upward (arrow C) and remove from rear door until electrical connectors (10, 11) on rear door (13) and inside door opener wire (7) are accessible	 Carefully lift door trim (1) off of rear door (arrow D) in area of door lock until it can be moved upward over window frame paneling (4).
9	Unhook inside door opener cable (7) on inside door handle (8)	
10	Unlock electrical connector (9) on speaker (12) and disconnect	
11	Unlock electrical connector on tweeter and disconnect	Model 205.0/1/2, 213, 253 with code 810 (Sound system) Model 213 with code 811 (Advanced sound system)
12	Unlock electrical connectors (10, 11) on rear door control unit (13) and disconnect	 Model 213.1 with code 297 (Roller sun blinds in rear doors) Installation: Do not yet connect electrical connector of roller sun blind motor.
		 The number of electrical connectors varies depending on equipment installed.
13	Remove door trim (1)	
14	Install in the reverse order	