

MODEL 220

- 1 Front cover
- 2 Insert lugs
- 3 Knee guard
- 4 Screws
- 5 Hook

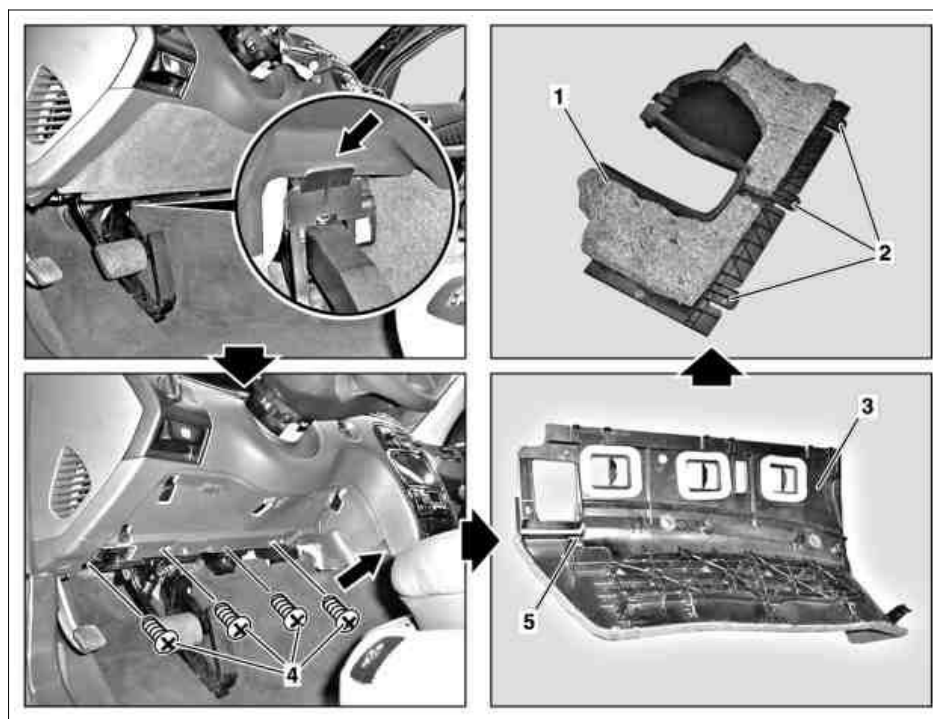

P68.10-2010-06

☒ ☒	Removal, installation		
1	Unscrew mounting nut for front cover (1)		
2	Slide front cover (1) with insert lugs (2) toward front out of knee guard (3) and remove downward out of guide (arrow) over accelerator pedal	i Installation: Insert cover (1) in guide (arrow) on accelerator pedal	
3	Unclip footwell lamp from knee guard (3) and disconnect connectors		
4	Unscrew screws (4), (4 each)		
5	Push knee guard (3) with hooks (5), (4 each) toward rear out of instrument panel and simultaneously out of center console	i Installation: Ensure that the side guide lug for the knee guard is inserted properly in the area of the center console (arrow)	
6	Install in opposite order		