

MODEL 204

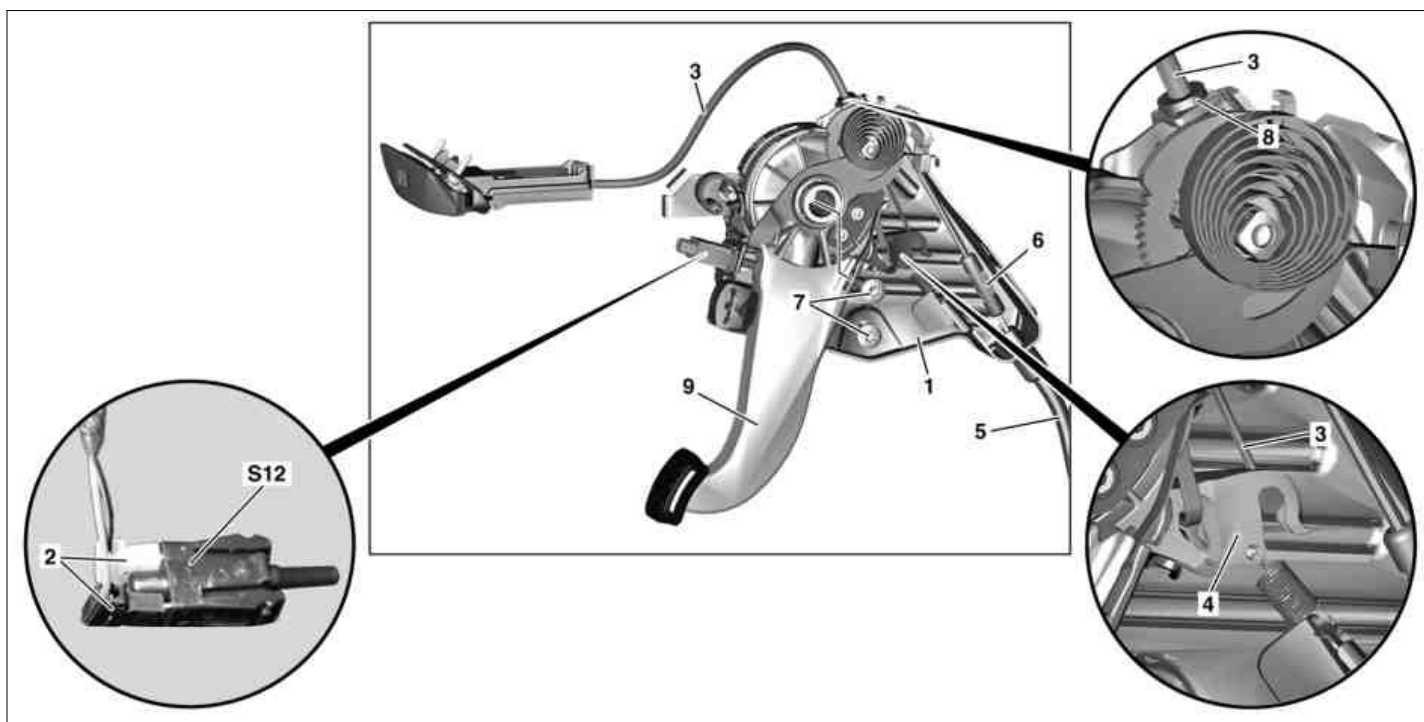

P42.20-2365-09

1 Parking brake pedal assembly

5 Front brake cable

9 Parking brake pedal

2 Electrical plug

6 Separation point

3 Release cable

7 Bolts

S12 Parking brake indicator switch

4 Support lug

8 Retaining clip

	Remove/install		
	Notes on self-locking nuts and bolts		AH00.00-N-0001-01A
1	Remove left cover below dashboard		
2	Remove cover from pedal assembly (1)		
3	Detach electrical plug (2) from indicator switch (S12)		
4	Unhook release cable (3) from support lug (4)		
5	Press separation point (6) on pedal assembly (1) downwards using assembly tool and unhook front brake cable (5)	Do not unhook front brake cable (5) with pliers as otherwise the rubber guard may be damaged.	*204589001600
6	Remove bolts (7)		*BA42.20-P-1001-01L
7	Unhook front brake cable (5) from tensioning shackle of pedal assembly (1)		*129589116300
8	Remove retaining clip (8) for release cable (3) and remove pedal assembly (1)		
9	Remove indicator switch (S12)	Only when replacing the pedal system (1)	
10	Install in the reverse order		
11	Operate parking brake pedal (9) several times in succession		
	Checking		
12	Check pedal travel on parking brake pedal (9)	If necessary: ↓ Adjusting parking brake.	AR42.20-P-0540CW

Parking brake

Number	Designation	Model 204

BA42.20-P-1001-01L	Bolt, foot-operated parking brake pedal assembly at front wall pillar	Nm	17
--------------------	---	----	----

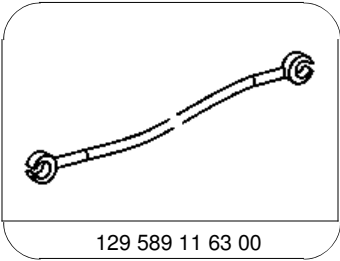

129 589 11 63 00

Snap-release tool

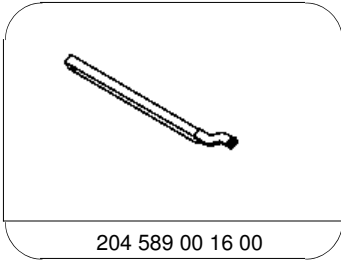

204 589 00 16 00

Assembly tool