

MODEL 218

Test and adjustment values for front door

Number	Designation	MODEL 218
BE72.10-P-1004-01E	Dimension "g" between window outer surface to B-pillar cover mm	0,0 (-0,5/+1,0)

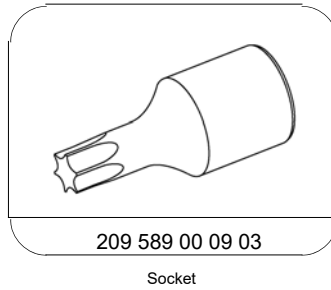
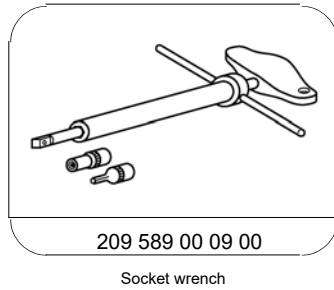
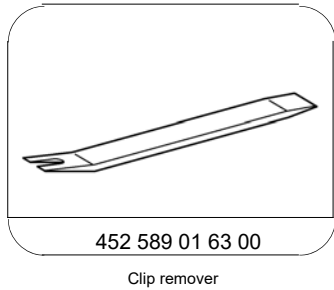

Check tension of crank window (1) on B-pillar cover seal (9)

- 1 Close crank window (1).
- 2 Move front door to first lock catch.
- 3 Check contact between window edge on crank window (1) and B-pillar cover seal (9), adjust if necessary.

i The edge of the crank window (1) should just make contact in the upper area (arrow) of the B-pillar cover seal (9).

Illustrated on model 218.3

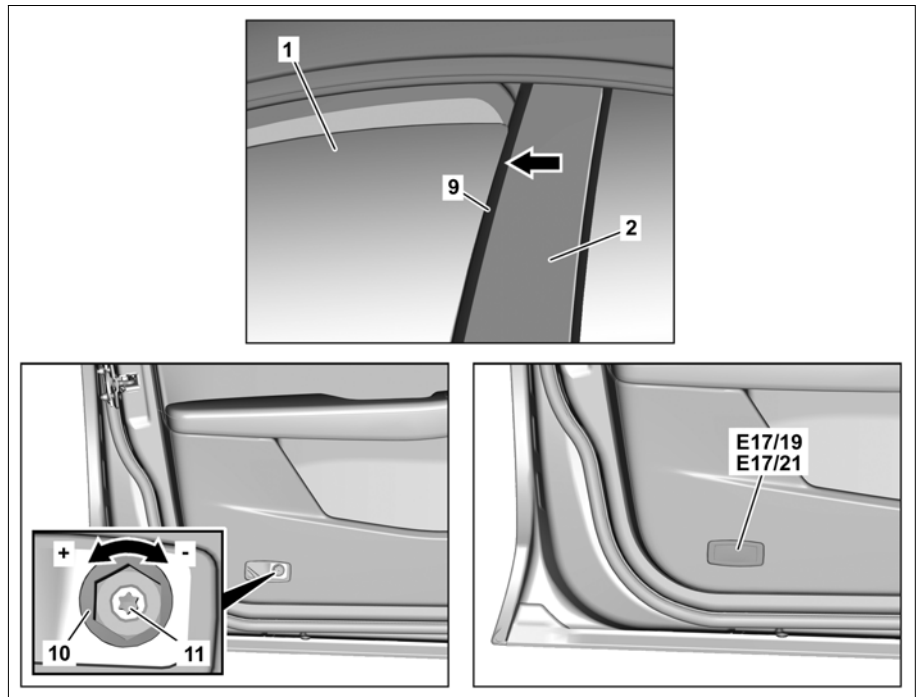



P72.10-3875-06

Adjust tension of crank window (1) on B-pillar cover seal (9)

- 4 Open front door.
- 5 Lift left front door warning lamp (E17/19) or right front door warning lamp (E17/21) with clip remover from door lining.
- 6 Disconnect electrical connector and remove left front door warning lamp (E17/19) or right front door warning lamp (E17/21).

i Procedure: Turning the adjustment screw (11) counterclockwise increases the crank window tension (1) ("+"). Turning the adjustment screw (11) clockwise decreases the crank window tension (1) ("-").

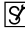
- 8 Move front door to first lock catch.
- 9 Check contact between window edge on crank window (1) and B-pillar cover seal (9), repeat adjustment if necessary.

- 7 Loosen nut (10) with  socket wrench and  TORX-Bit T25 and adjust tension of crank window (1) by turning adjustment screw (11).

 Adjust adjustment screw (11) only until the adjustment force increases perceptively. The maximum adjustment range is now reached and the adjustment screw (11) should not be turned further. Otherwise the thread can be damaged.

 Do not unscrew nut (10) from adjustment screw (11). Otherwise the adjustment screw (11) can be pressed behind the door module and can no longer be reached.

- 10 Open front door.

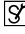
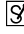
- 11 Tighten nut (10) with  socket wrench and  TORX-Bit T25.

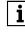
 When screwing on nut (10) ensure that adjustment screw (11) is not turned, otherwise it is necessary to readjust the initial crank window tension (1).

Check transition between crank window (1) and B-pillar cover (2)

- 12 Check dimension "g" at height of waistline, adjust if necessary.

Adjust transition between crank window (1) and B-pillar cover (2)

- 13 Unhook shaped part with B-pillar cover seal (9) at bottom of B-pillar cover (2).

- 14 Loosen bolt (12).

- 15 Adjust dimension "g" by turning sleeve (13).

 Turning the sleeve (13) counterclockwise increases ("+") dimension "g". Turning the sleeve (13) clockwise decreases ("-") dimension "g".

- 16 Tighten screw (12) .

- 17 Hook in shaped part with B-pillar cover seal (9) at bottom of B-pillar cover (2).

Illustrated on model 218.3

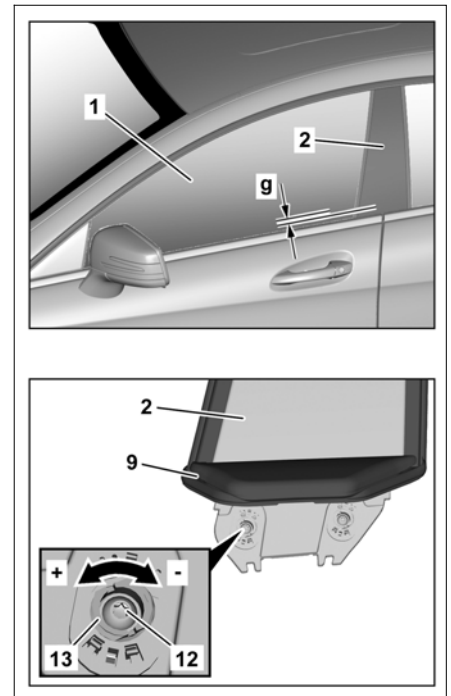

P72.10-3874-03