

Model 204.0 (except 204.077), 204.2 (except 204.277), 204.9

Model 212

Model 218

Shown with model 204.0

- 1 Seat backrest
- 2 Nuts
- 3 Sidebag unit
- 4 Electrical connector
- 5 Electrical connector
- 6 Cover

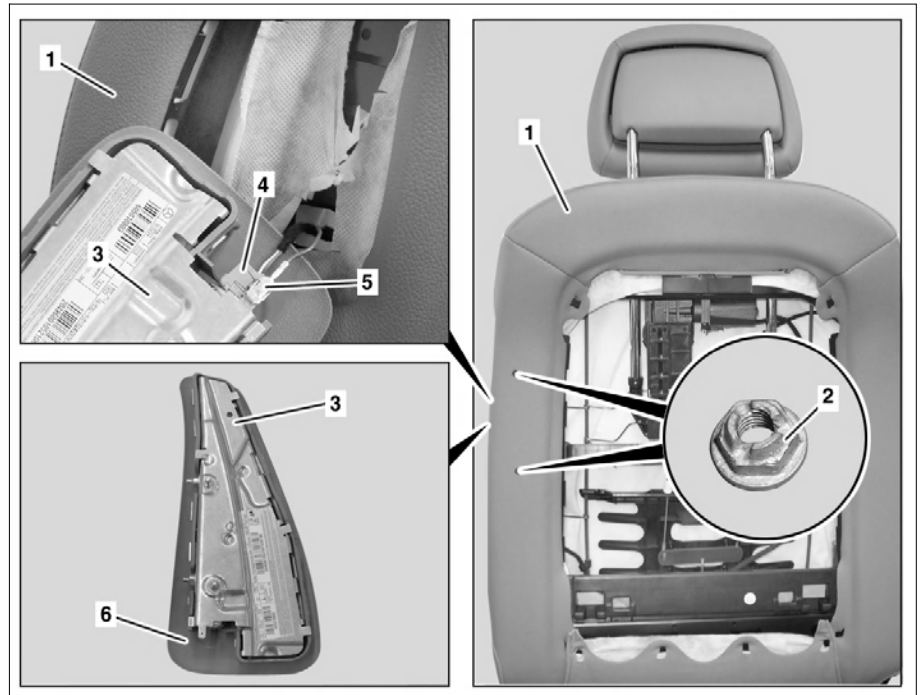

P91.60-3398-06

Warning	Risk of injury during testing and repair operations related to pyrotechnical components	Do not expose pyrotechnical component parts to temperatures above 100 °C or 212 °F. Disconnect current supply when working on such component parts.	AS91.00-Z-0008-01A
	Notes on self-locking nuts and bolts		AH00.00-N-0001-01A
	Information on preventing damage to electronic components due to electrostatic discharge		AH54.00-P-0001-01A
	Information, assessment and legal requirements when working with, handling and storing pyrotechnical components		AH91.00-Z-0000-10A
	Remove/install		
1	Move left or right front seat forwards		
2	Adjust backrest (1) toward front.		
3	Switch off ignition and store transmitter key outside of transmission range (min. 2 m)		
4	Disconnect battery ground line	Model 204.0 (except 204.077), 204.2 (except 204.277), 204.9 Model 212, 218	AR54.10-P-0003CW AR54.10-P-0003EW AR91.10-P-1910CW
5	Remove seat-back lining at backrest (1)		AR91.10-P-1910CW
6	Unscrew nuts (2)	Mount, sidebag unit to backrest frame	*BA91.60-P-1008-01M
7	Lift sidebag unit (3)		
8	Release and disconnect electrical connectors (4, 5)		
9	Remove sidebag unit (3)		
10	Install in the reverse order		
	Check		
11	Check and erase vehicle fault memory using the diagnostic system	When replacing sidebag unit (3).	AD00.00-P-2000-04A

Airbag

Number	Designation		Model 204.0/2/9	Model 212
BA91.60-P-1008-01M	Mount, sidebag unit to backrest frame	Nm	6	6

Nm Airbag

Number	Designation	Model 218
BA91.60-P-1008-01M	Mount, sidebag unit to backrest frame	Nm 6