

MODEL 172, 204, 207, 212, 218, 219, 231

1 Before removing the centering sleeve, measure and note dimension (a).

i Depending on the version of the joint disk thickness, the specified press-in dimension may deviate when installing.

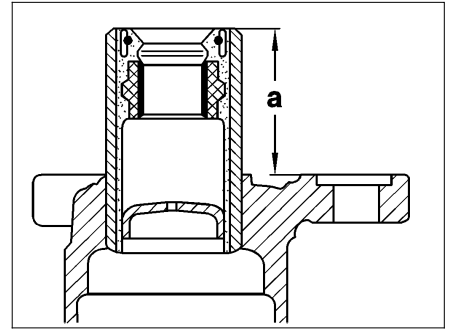

P41.10-0211-01

2 Knock centering sleeve out of propeller shaft using a suitable tool (arrow).

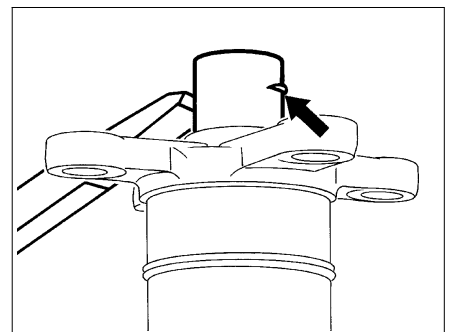

P41.10-0014-01

3 Drill a hole (10 mm dia.) at right angles through the centering sleeve (10) 15 mm from the end face of the centering sleeve (10).

Only if it is not possible to knock it out.

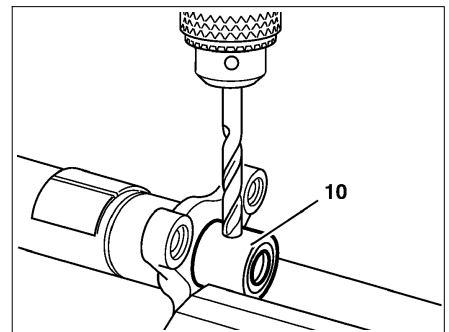

P41.10-0015-01

4 Insert a drift through the hole and lever the centering sleeve (10) out of the propeller shaft using two assembly levers.

Only if it was not possible to knock it out.

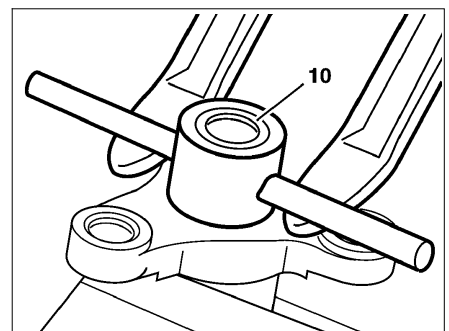

P41.10-0016-01