

Model 172, 204, 207, 212, 218, 231

Shown on front half of propeller shaft

- 1 Front half of propeller shaft
10 Centering sleeve
12 Flex disk

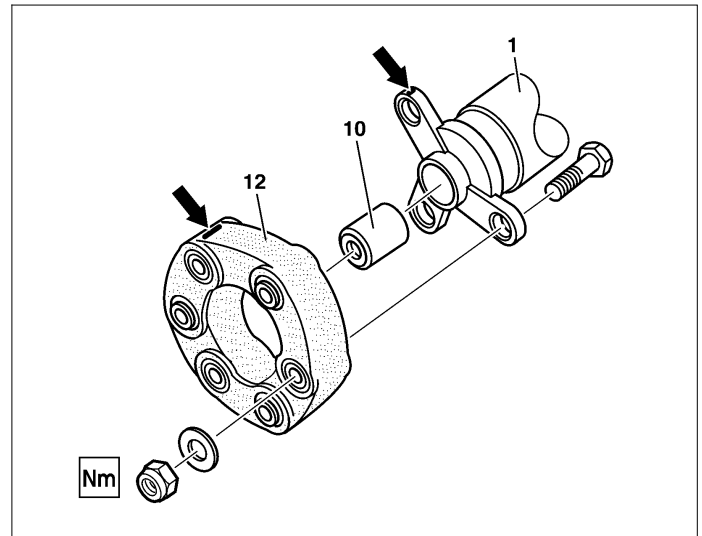

P41.10-2003-11

Remove/install			
1	Remove propeller shaft	Model 172 Model 204, 207 Model 212, 218 Model 231	AR41.10-P-0050V AR41.10-P-0050CW AR41.10-P-0050EW AR41.10-P-0050RK
2	Separate propeller shaft at the slide connection	i Installation: Coat splined profile with long-life grease and connect front half of propeller shaft (1) and rear half of propeller shaft. Long-life grease	AR41.10-P-0050-05TX *BR00.45-Z-1001-06A
3	Check centering sleeve (10) in front half of propeller shaft (1) and rear half of propeller shaft	If the sealing lip in the centering sleeve (10) is worn or damaged, the centering sleeve (10) must be replaced. ↓ Remove centering sleeve (10) Removal of centering sleeve ↓ Press in centering sleeve (10). Press in guide sleeve Model 172 Press in guide sleeve Model 204, 207, 212, 218, 231 MODEL 172 Press-in dimension "a" from face end of centering sleeve to joint flange MODEL 204, 207, 212, 218 Press-in dimension "a" from face end of centering sleeve to joint flange MODEL 231 Press-in dimension "a" from face end of pilot bushing to joint flange	AR41.10-P-0200-02TX AR41.10-P-0200-03W AR41.10-P-0200-03TX *BE41.10-P-1001-02E *BE41.10-P-1001-02M *BE41.10-P-1001-04A
4	Fill cavities of both centering sleeves (10) with grease	MB multipurpose grease, 400 g	*BR00.45-Z-1017-06A
5	Install in the reverse order		

Check values for propeller shaft centering sleeve

Number	Designation		Model 172.447/448	Model 172.403/457
BE41.10-P-1001-02E	Press-in dimension "a" from face end of centering sleeve to joint flange	Front propeller shaft	mm 23,3	24,8
		Rear propeller shaft	mm 26,8	28,3

	See	-	-
--	-----	---	---

Check values for propeller shaft centering sleeve

Number	Designation		Model 172.475
BE41.10-P-1001-02E	Press-in dimension "a" from face end of centering sleeve to joint flange	Front propeller shaft mm	22,4
		Rear propeller shaft mm	25,9
		See	-

Check values for propeller shaft centering sleeve

Number	Designation		Model 204.001/201	Model 204.000/002/200/202
BE41.10-P-1001-02M	Press-in dimension "a" from face end of centering sleeve to joint flange	Front propeller shaft mm	24,8	24,8
		Rear propeller shaft mm	36,2	36,3

Check values for propeller shaft centering sleeve

Number	Designation		Model 204.003 with autom. transmission	Model 204.006/007 /041/044/045 /046/048/049 /052/054/081 /082/085/087 /089/092/207 /241/245/246 /248/249/252 /254/282/289 /292/981/982 /983/984/987 /992
BE41.10-P-1001-02M	Press-in dimension "a" from face end of centering sleeve to joint flange	Front propeller shaft mm	24,8	23,3
		Rear propeller shaft mm	36,2	26,8

Check values for propeller shaft centering sleeve

Number	Designation		Model 204.008/047/056/065 /208/247/256/901/902/956	Model 204.022/025/222/225
BE41.10-P-1001-02M	Press-in dimension "a" from face end of centering sleeve to joint flange	Front propeller shaft mm	24,8	25,3
		Rear propeller shaft mm	28,3	28,8

Check values for propeller shaft centering sleeve

Number	Designation		Model 204.077/277	Model 204.003 with manual transmission Model 204.203
BE41.10-P-1001-02M	Press-in dimension "a" from face end of centering sleeve to joint flange	Front propeller shaft mm	28,8	25,3
		Rear propeller shaft mm	28,8	36,2

Check values for propeller shaft centering sleeve

Number	Designation		Model 207.302/402	Model 207.303/403
BE41.10-P-1001-02M	Press-in dimension "a" from face end of centering sleeve to joint flange	Front propeller shaft mm	24,8	25,3
		Rear propeller shaft mm	36,3	36,2

Check values for propeller shaft centering sleeve

Number	Designation		Model 207.322/372/422/472	Model 207.347/356/357/44 7/456/457
BE41.10-P-1001-02M	Press-in dimension "a" from face end of centering sleeve to joint flange	Front propeller shaft mm	25,3	24,8
		Rear propeller shaft mm	28,8	28,3

Check values for propeller shaft centering sleeve

Number	Designation		Model 207.348/448	Model 212.002/005/202/20 5
BE41.10-P-1001-02M	Press-in dimension "a" from face end of centering sleeve to joint flange	Front propeller shaft mm	23,3	24,8
		Rear propeller shaft mm	26,8	36,3

Check values for propeller shaft centering sleeve

Number	Designation		Model 212.003/020/074/077 /203/220/274/277 Model 212.024/025/224/225 with autom. transmission	Model 212.047/093/247/29 3
BE41.10-P-1001-02M	Press-in dimension "a" from face end of centering sleeve to joint flange	Front propeller shaft mm	25,3	24,8
		Rear propeller shaft mm	36,2	28,3

Check values for propeller shaft centering sleeve

Number	Designation		Model 212.041/048/054/082 /087/089/090/147/14 8/248/254/282/287/2 88/289	Model 212.053/056/057/25 6/257
BE41.10-P-1001-02M	Press-in dimension "a" from face end of centering sleeve to joint flange	Front propeller shaft mm	23,3	36,3
		Rear propeller shaft mm	26,8	28,3

Check values for propeller shaft centering sleeve

Number	Designation		Model 212.023/072/223/272 Model 212.024/025/224/225 with manual transmission	Model 212.154
BE41.10-P-1001-02M	Press-in dimension "a" from face end of centering sleeve to joint flange	Front propeller shaft mm	25,3	34,8
		Rear propeller shaft mm	28,8	26,8

Check values for propeller shaft centering sleeve

Number	Designation		Model 218.303/323/373	Model 218.359 except code 460 (Canada version) except code 494 (US version)
BE41.10-P-1001-02M	Press-in dimension "a" from face end of centering sleeve to joint flange	Front propeller shaft mm	25,3	36,3
		Rear propeller shaft mm	28,8	28,3

Check values for propeller shaft centering sleeve

Number	Designation		Model 218.359 with code 460 (Canada version) with code 494 (US version) Model 218.391	Model 218.374
BE41.10-P-1001-02M	Press-in dimension "a" from face end of centering sleeve to joint flange	Front propeller shaft mm	24,8	25,3
		Rear propeller shaft mm	28,3	36,2

Check values for propeller shaft pilot bushing

Number	Designation		Model 231.457	Model 231.473/479
BE41.10-P-1001-04A	Press-in dimension "a" from face end of pilot bushing to joint flange	Front propeller shaft mm	24,8	25,3
		Rear propeller shaft mm	28,3	28,8

Check values for propeller shaft pilot bushing

Number	Designation		Model 231.474
BE41.10-P-1001-04A	Press-in dimension "a" from face end of pilot bushing to joint flange	Front propeller shaft mm	25,3
		Rear propeller shaft mm	36,2

Repair materials

Number	Designation	Order number
BR00.45-Z-1001-06A	Long-life grease	A 000 989 63 51 11
BR00.45-Z-1017-06A	MB multipurpose grease, 400 g	A 001 989 34 51 11