

TRANSMISSION 722.9 in MODEL 219

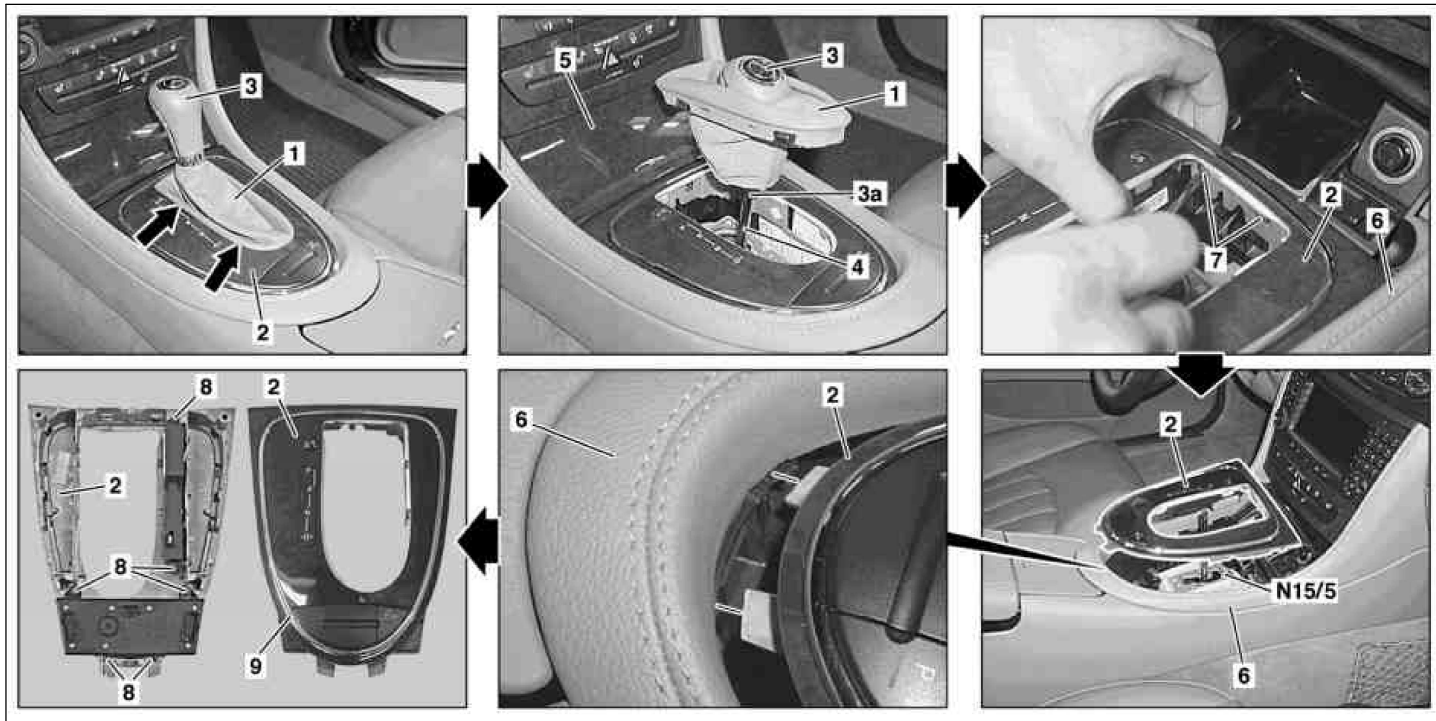

P27.60-2650-09

1 Bellows
2 Cover
3 Selector lever handle
3a Plastic nuts

4 Selector lever rod
5 Ashtray or stowage compartment
6 Center console
7 Snap-in lug

8 Screw
9 Chrome frame
N15/5 Electronic selector lever module control unit

	Remove/Install		
	Notes on avoiding damage to electronic components due to electrostatic discharge		AH54.00-P-0001-01A
1	Move selector lever into position "R"		
2	Turn key in ignition switch to position "0".		
3	Release bellows (1) from covering (2)	<p> If required carefully apply long wedge at the positions denoted by the arrows.</p> <p> Long wedge</p>	*115589035900
4	Slip bellows (1) over the selector lever handle (3) and release plastic nut (3a)	Turn plastic nut (3a) approx. 70° in counterclockwise direction.	
5	Detach selector lever handle (3) from selector lever rod (4).	To avoid damaging the bellows (1) pull on the selector lever handle (3) only.	
6	Cover the selector lever gate of the electronic selector lever module control unit (N15/5) with a cloth	If objects enter the electronic selector lever module control unit (N15/5), it may be damaged.	
7	Open ashtray or stowage compartment (5)		
8	Release covering (2) at front from the center console (6)	To do so raise covering (2) at front and tension, then release the locking lugs (7) using a screwdriver.	
9	Pull covering (2) at rear out of guides in the center console (6)		
10	Detach all electrical connectors at the switches mounted in the covering (2) and covering (2)	The number of electrical connectors varies depending on the model and special equipment.	
11	Place covering (2) onto a padded base	In order to avoid scratches and damage, the covering (2) must always be put down onto a padded base.	
12.1	Undo screws (8) of switch and remove switch from covering (2)	<p>If necessary</p> <p> The number and type of switches varies depending on the model and special equipment.</p>	

13.1	Unclip chrome frame (9) from covering (2) and remove	If necessary	
14	Install in the reverse order		
15.1	Read out fault memory and erase if necessary	After replacing switches.	
 AD	Connect STAR DIAGNOSIS and read out fault memory	Diagnosis system STAR DIAGNOSIS	AD00.00-P-2000-04A *WE58.40-Z-1013-06A

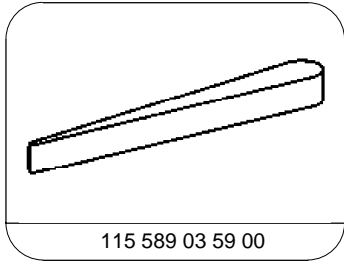

Longitudinal wedge

Workshop equipment/MB testers (see Workshop Equipment Manual)

WE58.40-Z-1013-06A	STAR DIAGNOSIS Compact diagnosis system for passenger cars, order number 6511 1801 00
--------------------	---