

MODEL 219 with ENGINE 113, 156, 272, 273

- 1 Center engine compartment paneling
 1a Bolts
 2 Front engine compartment paneling
 2a Bolts
 3 Rear engine compartment paneling
 3a Bolts

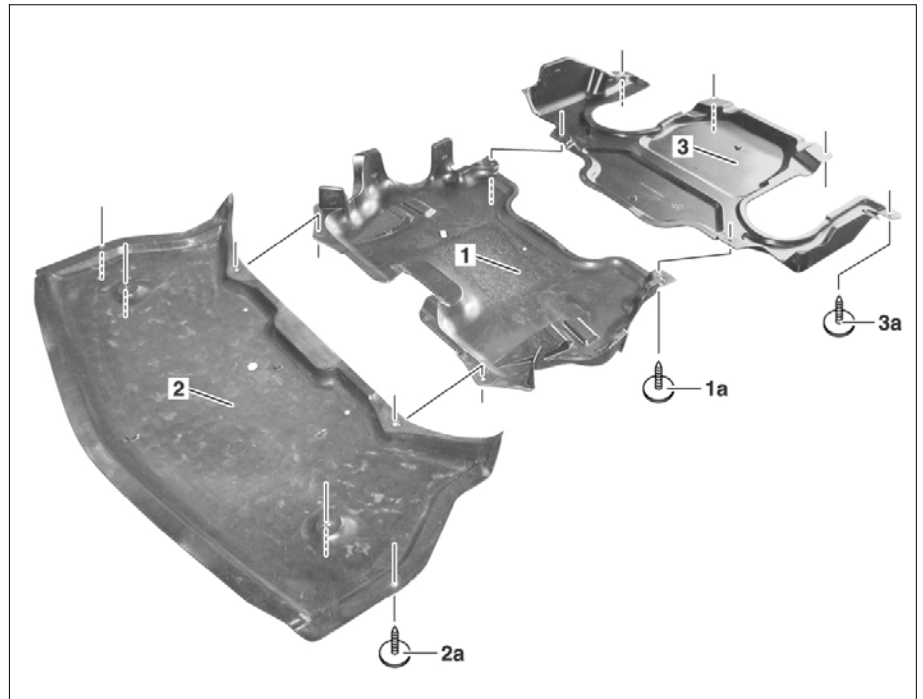

P61.20-2049-06

☒ ☒	Remove/install		
⚠ Danger!	Risk of death caused by vehicle slipping or toppling off of the lifting platform.	Align vehicle between the columns of the lifting platform and position the four support plates at the lifting platform support points specified by the vehicle manufacturer.	AS00.00-Z-0010-01A
1	Raise vehicle with lifting platform		AR00.60-P-1000TX
2	Remove bolts (1a)	☒	*WH58.30-Z-1007-20A
3	Take off middle engine compartment paneling (1)	i Can be removed separately.	
4	Remove bolts (2a)		
5	Take off front engine compartment paneling (2)	i Installation: Move front engine compartment paneling (2) into front bumper i Installation: On model 219.376 ensure that position of air ducting for additional oil cooler is correct.	
6	Remove bolts (3a)		
7	Take off rear engine compartment paneling (3)	i Can be removed separately.	
8	Install in the reverse order		

Commercially available tools

Number	Designation
WH58.30-Z-1007-20A	Cordless drill/driver