

MODEL 207.4

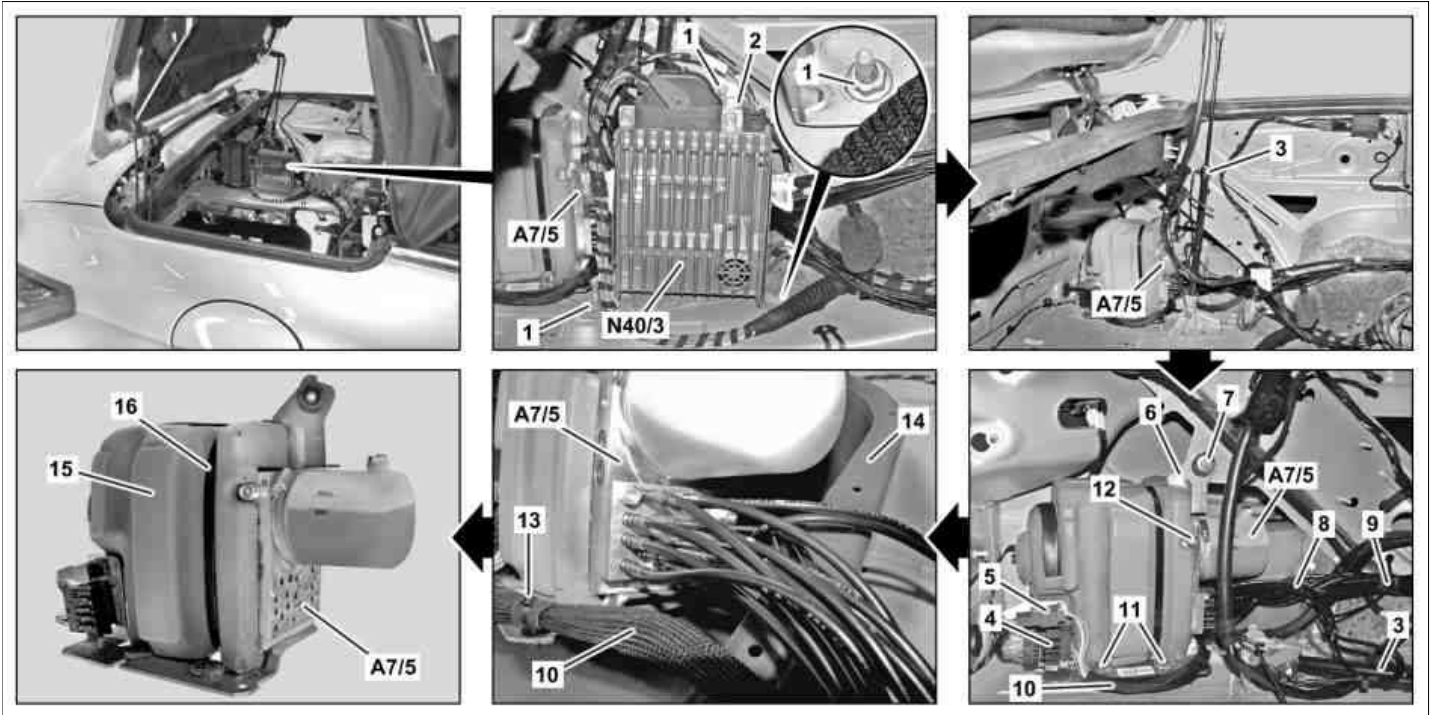

P77.37-2236-09

- 1 Nut (with code (810) Sound system)
- 2 Bracket (with code (810) Sound system)
- 3 Soft top compartment cover hydraulic cylinder
- 4 Electrical connector
- 5 Electrical connector
- 6 Bracket
- 7 Nut

- 8 Hydraulic lines
- 9 Cable tie
- 10 Wiring harness
- 11 Pin
- 12 Screw
- 13 Cable tie
- 14 Drip tray
- 15 Damping material

- 16 Cable tie
- A7/5 Soft top control hydraulic unit
- N40/3 Sound system amplifier control unit (with code (810) Sound system)

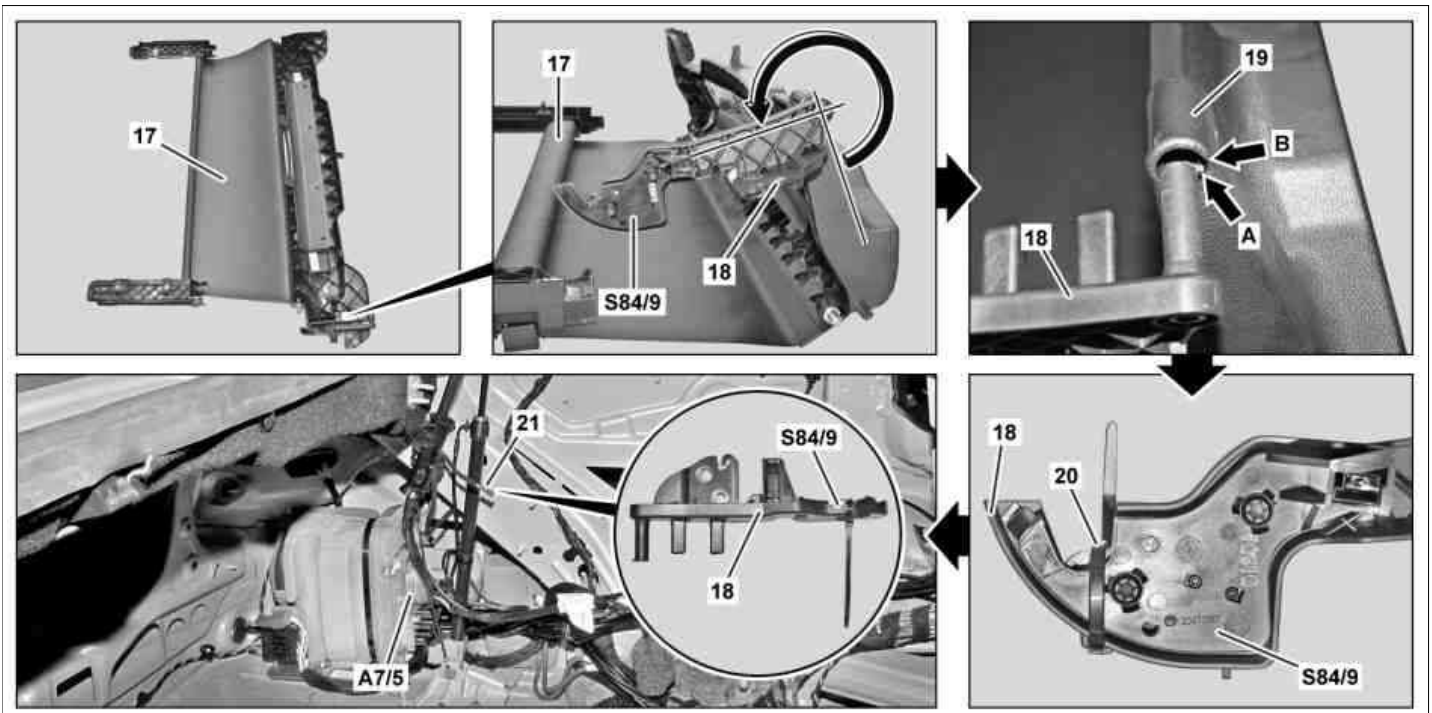

P77.37-2237-09

- 17 Retractable partition

- 20 Cable tie

- A7/5 Soft top control hydraulic unit

	Removing		
	Risk of injury when performing check and repair work in area of roll bar	Type 207.4 Before working in area of rollbar, completely extend rear head restraints Keep body parts out of the area where the roll bar extends.	AS91.00-Z-0003-01A
	Risk of injury caused by moving parts that can pinch, crush or, in extreme cases, even sever extremities	No parts of the body or limbs should be within the operating range of the mechanism when moving components.	AS00.00-Z-0009-01A
	Risk of injury to skin or eyes caused by hydraulic fluid spraying out under high pressure. Risk of poisoning caused by swallowing hydraulic fluid	Depressurize the hydraulic system completely before starting any work on the system. Wear protective clothing and safety glasses.	AS00.00-Z-0013-01A
	Risk of injury caused by scraping or cutting body parts on sharp vehicle parts	Always wear protective gloves when working on or near sharp and non-deburred vehicle parts. Deburr repair panels.	AS00.00-Z-0017-01A
1	Remove left side paneling in trunk		AR68.30-P-4800EC
2	Unscrew nuts (1)	With code (810) Sound system	
3	Remove bracket (2) with sound system amplifier control unit (N40/3) and lay down to side with electrical lines connected	With code (810) Sound system Do not kink optical fiber conductor or route over sharp edges or in radiuses smaller than 25 mm, otherwise they can be damaged and must be replaced.	
4	Remove left soft top compartment lid hydraulic cylinder (3) and lay down to side with hydraulic lines (8) connected		AR77.37-P-4175QA
5	Cut cable tie (9) from hydraulic lines (8)		
6	Unclip electrical connectors (4, 5) from bracket (6) on soft top control hydraulic unit (A7/5) and disconnect		
7	Loosen bolt (12) on soft top control hydraulic unit (A7/5)	Pressure is relieved from hydraulic system	
8	Unscrew nut (7) from bracket (6) on soft top control hydraulic unit (A7/5)		
9	Remove soft top control hydraulic unit (A7/5) and lay down on suitable collecting pan (14) with hydraulic lines (8) connected	Do not kink hydraulic lines (8) and do not route over sharp edges or in small rows smaller than 25 mm, otherwise they can be damaged and must be replaced.	
10	Cut cable tie (13) and lay electrical wiring harness (10) down to side		
11	Remove hydraulic lines (8) from soft top control hydraulic unit (A7/5)	Do not allow hydraulic oil to run out and soil insulation (15). 	AR77.37-P-1000-04KA *129589009100
12	Remove soft top control hydraulic unit (A7/5)		
13	Cut cable tie (16) and remove insulation (15) from soft top control hydraulic unit (A7/5)	Only when replacing soft top control hydraulic unit (A7/5).	
	Install		
14	Install insulation (15) on soft top control hydraulic unit (A7/5) and fasten with cable tie (16)	Only when replacing soft top control hydraulic unit (A7/5).	
15	Lay soft top control hydraulic unit (A7/5) down in area of hydraulic lines (8)		
16	Attach hydraulic lines (8) to soft top control hydraulic unit (A7/5)	Do not allow hydraulic oil to run out and soil insulation (15). Provide all hydraulic lines (8) pulled out with new retaining rings and new sealing rings. Moisten new sealing rings with hydraulic oil. Sheet 343.0 	AR77.37-P-1000-04KA BB00.40-P-0343-00A *BA77.37-P-1002-01C *BA77.37-P-1003-01C *129589009100
BB	Hydraulic fluids (Specification 343.0)		

			*208589012100
17	Insert soft top control hydraulic unit (A7/5) into pins (11) on longitudinal member		
18	Screw nut (7) into bracket (6) on soft top control hydraulic unit (A7/5)		
19	Tighten bolt (12) to soft top control hydraulic unit (A7/5)		
20	Connect electrical connectors (4, 5) and clip into bracket (6) on soft top control hydraulic unit (A7/5)		
21	Fasten hydraulic lines (8) with cable tie (9)		
22	Install left soft top compartment lid hydraulic cylinder (3)		AR77.37-P-4175QA
23	Position retractable partition (17) so that the bracket (18) can be removed together with the variable soft top compartment limit switch (S84/9)		
24	Turn bracket (18) 270° counterclockwise as shown.		
25	Carefully pull bracket (18) out of mount (19)	Danger of breaking guide pin (arrow A).	
26	Actuate bracket of variable soft top compartment limit switch (S84/9) and fasten with cable tie (20) as shown.		
27	Connect variable soft top compartment limit switch (S84/9) to electrical connector (21)		
28	Check oil level of hydraulic line, correct if necessary Hydraulic fluids (Specification 343.0)	Sheet 343.0 	BB00.40-P-0343-00A *BA77.37-P-1003-01C *230589016300
29	Check soft top control hydraulic unit (A7/5) for leakage and proper function		
30	Check oil level of hydraulic line, correct if necessary Hydraulic fluids (Specification 343.0)	Sheet 343.0 	BB00.40-P-0343-00A *BA77.37-P-1003-01C *230589016300
31	Disconnect electrical connector (21) from variable soft top compartment limit switch (S84/9)		
32	Separate cable tie (20)		
33	Carefully guide mount (18) with guide pin (arrow A) into groove (arrow B) of mount (19)	Danger of breaking guide pin (arrow A).	
34	Turn bracket (18) clockwise to end stop		
35	Install bracket (2) with sound system amplifier control unit (N40/3)	With code (810) Sound system Do not kink optical fiber conductor or route over sharp edges or in radiuses smaller than 25 mm, otherwise they can be damaged and must be replaced.	
36	Screw on nuts (1)	With code (810) Sound system	
37	Install left side paneling in trunk		AR68.30-P-4800EC

Soft top hydraulic components

Number	Designation	Model 207.4	
BA77.37-P-1002-01C	Bolt, terminal plate to hydraulic unit	Nm	10
BA77.37-P-1003-01C	Oil filler screw to hydraulic unit reservoir	Nm	2

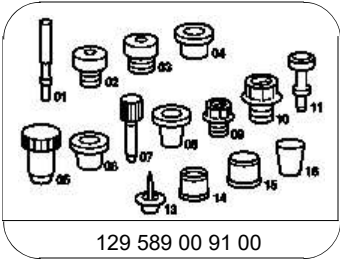

129 589 00 91 00

Set of stop plugs

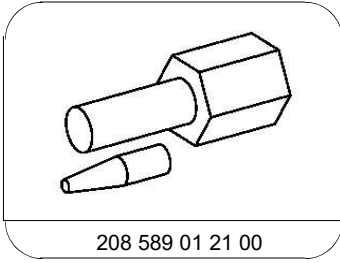

208 589 01 21 00

Assembly aid

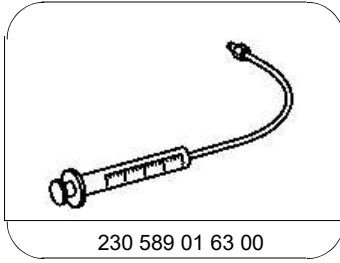

230 589 01 63 00

Filler syringe