

**MODEL 207**

**Modification notes**

26.2.13	Adjustment method completely modified	Work steps 1 through 15	
---------	---------------------------------------	-------------------------	--

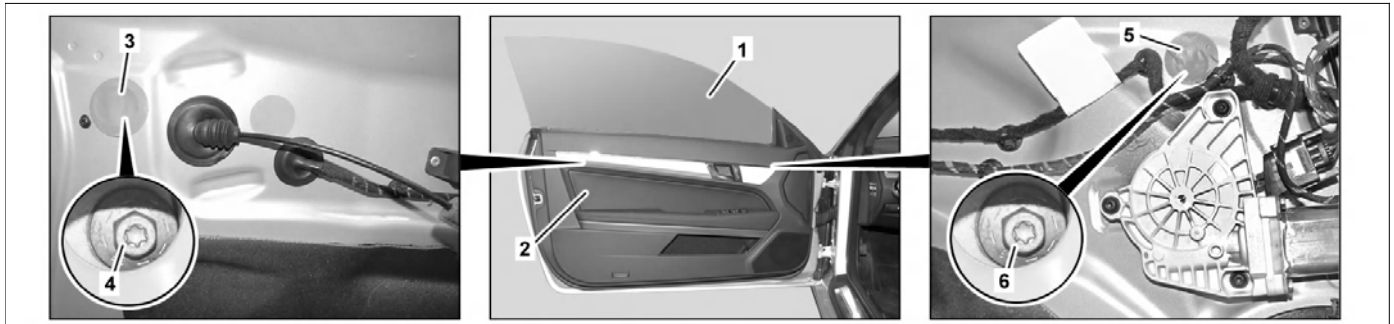

P72.10-3738-07

**Illustrated on model 207.3**

- 1 Remove adhesive pad (3, 5).
- 2 Position door lining (2) on left or right front door and connect electrical connectors on driver side power window and outside mirror adjustment switch group to left front door control unit or electrical connector passenger side power window switch to right front door control unit.
- 3 Switch on ignition.
- 4 Move window (1) down until bolts (4, 6) are visible.
- 5 Switch off ignition.
- 6 Remove sealing rail from inner beltline.
- 7 Measure inside dimension "a" between door carcass (8) in relation to rear edge of window (9) with vernier caliper.

**i** Inside dimension "a" should be 16.5 mm. If the measurement result deviates, adjust rear window (1). Adjust procedure is described in operation steps 8 and 10.

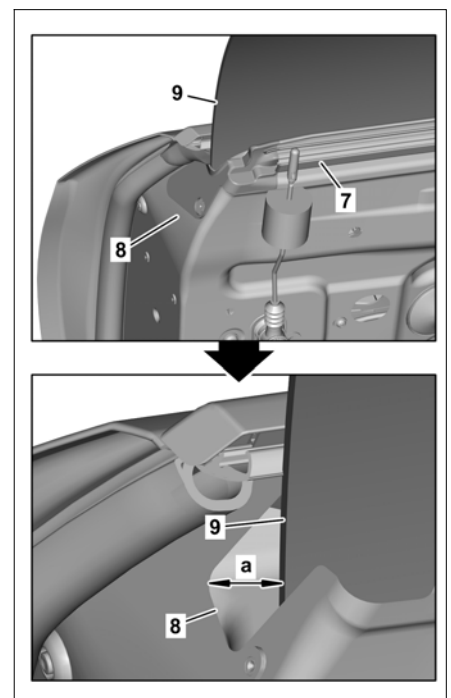

P72.10-4116-03

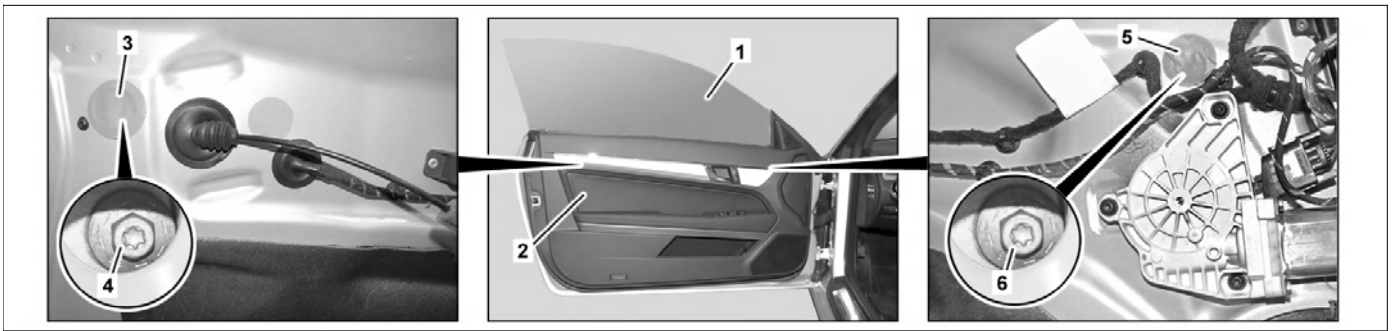

P72.10-3738-07

**Illustrated on model 207.3**

8 Remove bolts (4, 6).

9 Move window (1) on window lifter until inside dimension "a" is adjusted.

**i** Inside dimension "a" should be 16.5 mm.

10 Tighten bolts (4, 6).

11 Glue on new adhesive pad (3, 5).

12 Switch on ignition.

13 Completely roll up window (1).

14 Switch off ignition.

15 Disconnect electrical connectors on driver side power window and outside mirror adjustment switch group from left front door control unit or electrical connector passenger side power window switch from right front door control unit and remove door lining (2).