

Modification notes

6.10.11	Adjustment value for model 207.4 changed	Operation step 7
---------	--	------------------

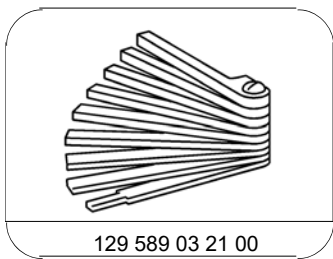

129 589 03 21 00

Feeler gauge

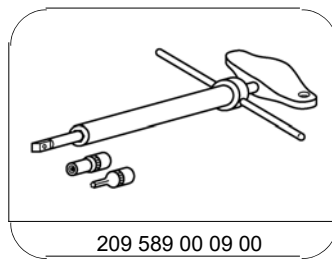

209 589 00 09 00

Socket wrench

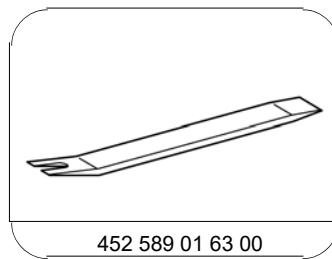

452 589 01 63 00

Clip remover

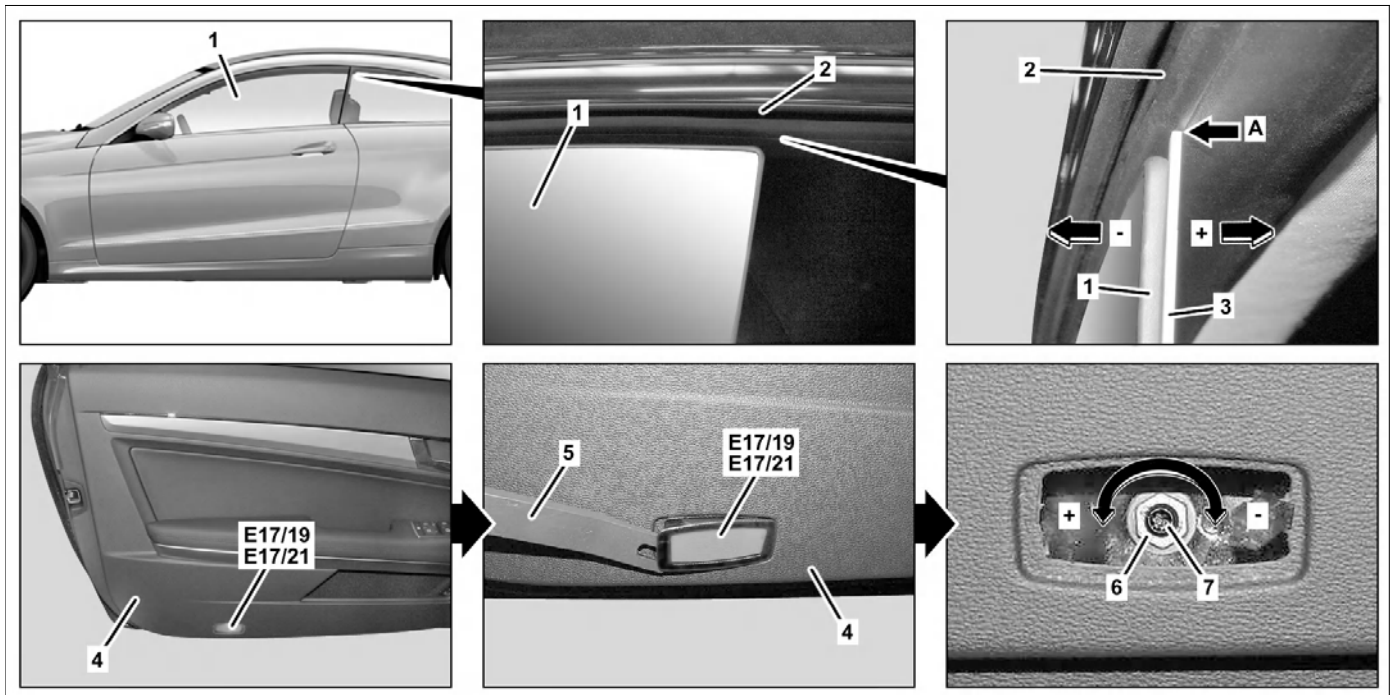

P72.10-3743-09

Shown on model 207.3

i If the adjustment range of the adjustment screw (7) for adjusting the initial tension is not sufficient, the adjustment range can be extended by moving the adjustment wedge toward the window (1).

- 1 Position door lining (4) on left or right front door and connect electrical connectors on driver side power window and outside mirror adjustment switch group to left front door control unit or electrical connector passenger side power window switch to right front door control unit.
- 2 Switch on ignition.
- 3 Move window (1) slightly below the short stroke position so that the window (1) does not move up when closing the front door

- 4 Disconnect electrical connectors on driver side power window and outside mirror adjustment switch group from left front door control unit or electrical connector passenger side power window switch from right front door control unit and remove door lining (4).

- 5 Switch off ignition.
- 6 Close front door.

- 7 Measure distance from inside of window (1) to groove (arrow A) on sealing frame (2) with S feeler gauge (3) as shown. If the actual dimension deviates, adjust window (1).

i The nominal dimension for model 207.3 is 2 to 3 mm. The nominal dimension for model 207.4 is 6 to 7 mm.

- 8 Open front door.
- 9 Remove left front door warning lamp (E17/19) or right front door warning lamp (E17/21) from door lining (4) with S snap-release tool (5) as shown.

⚠ Adjust adjustment screw (7) only until the adjustment force increases perceptively. This is the maximum limit for the adjustment range; turning the adjustment screw (7) further would damage the thread.

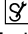
- 10 Disconnect electrical connector and remove left front door warning lamp (E17/19) or right front door warning lamp (E17/21).
 - 11 Loosen nut (6) with  socket wrench and TORX bit T25H and adjust pretension of window (1) by turning adjustment screw (7).
TORX tool kit (58-piece): TORX bit T25H and bit holder
[gotis://G_58.3_05.0](https://www.gotis.com/G_58.3_05.0)
-

- 12 Close front door.
- 13 Measure distance from inside of window (1) to groove (arrow A) on sealing frame (2) with  feeler gauge (3) as shown, if necessary repeat adjustment.
- 14 Open front door.

 Procedure:
Turning the adjustment screw (7) counterclockwise increases the window tension (1) ("+").
Procedure: Turning the adjustment screw (7) clockwise decreases the window tension (1) ("-").

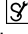
- 15 Tighten nut (6) with  socket wrench and TORX-Bit T25H.
TORX tool kit (58-piece): TORX bit T25H and bit holder
[gotis://G_58.3_05.0](https://www.gotis.com/G_58.3_05.0)

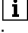
 When screwing on nut (6) ensure that adjustment screw (7) is not turned, otherwise it is necessary to readjust the initial window tension (1).