

Model 172, 204, 207

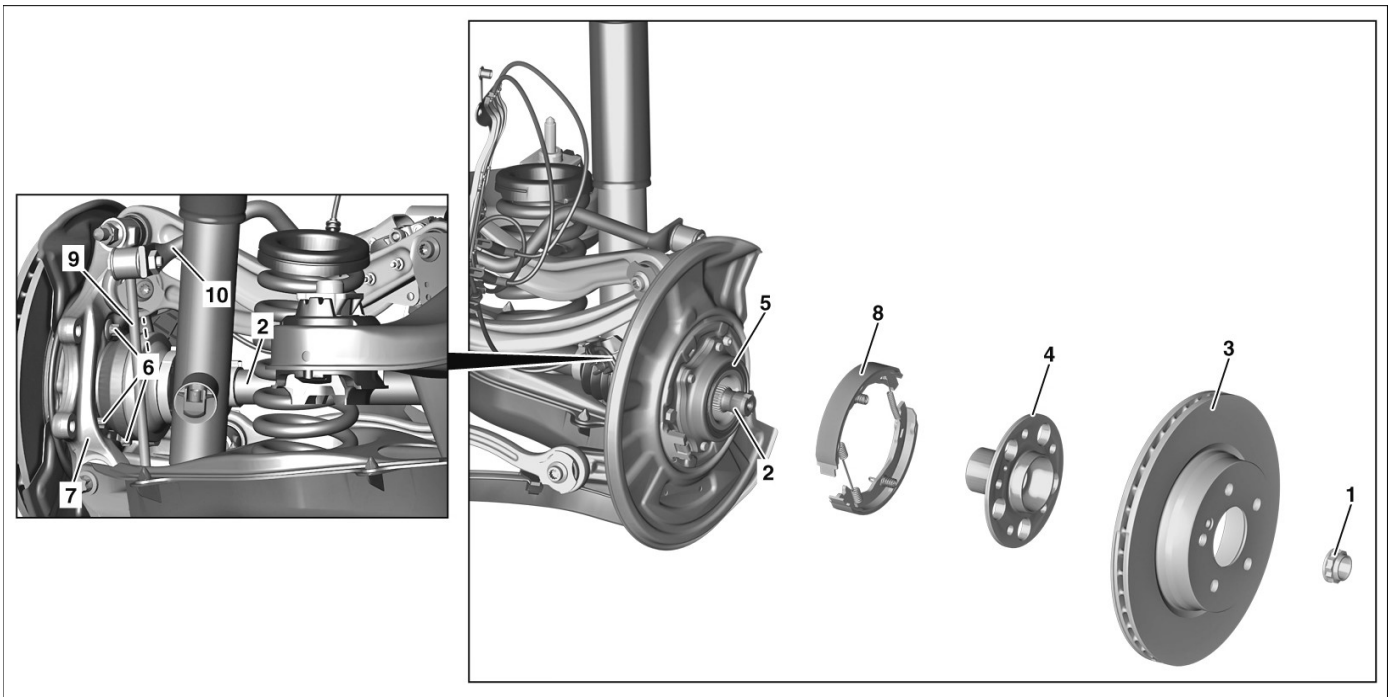

P35.20-2229-09

Shown on model 204

- | | | | | | |
|---|-------------------------|---|------------------------------|----|------------------------|
| 1 | Twelve-point collar nut | 5 | Angular contact ball bearing | 8 | Brake shoe |
| 2 | Rear axle shaft | 6 | Bolts | 9 | Stabilizer bar linkage |
| 3 | Rear brake disk | 7 | Wheel carrier | 10 | Torsion bar |
| 4 | Rear axle shaft flange | | | | |

	Remove		
Danger	Risk of death caused by vehicle slipping or toppling off of the lifting platform.	Align vehicle between vehicle lift columns and position the four support plates at the vehicle lift support points specified by the vehicle manufacturer.	AS00.00-Z-0010-01A
Warning	Risk of injury caused by pinching or crushing when working on springs or spring bodies that are under tension	Use only approved tensioning devices; additionally screen off hazardous area if necessary. Check special tools for damage and proper operation (visual inspection). Wear protective gloves.	AS00.00-Z-0001-01A
	Notes on repair work on suspension components		AH00.00-P-0100-01A
1	Secure vehicle on vehicle lift	Model 172 Model 204, 207	AR00.60-P-0100T AR00.60-P-0100CW
2 AP AP	Remove corresponding rear wheel	Model 172 Model 204, 207	AP40.10-P-4050V AP40.10-P-4050CW
3 Notice Notice	Unscrew twelve-point collar nut (1) from rear axle shaft (2) Notes on self-locking nuts and bolts Notes on threaded connections fastened using a tightening angle-based tightening process	Collar nut, rear axle shaft to rear axle shaft flange	AR35.30-P-0115-01TX AH00.00-P-0001-01KOA AH00.00-P-0020-01A *BA35.30-P-1001-01J
4	Remove rear brake disk (3)	Model 172 (except 172.466/475) Model 172.466/475 Model 204 (except 204.077/277/377) Model 204.077/277/377 Model 207	AR42.10-P-0220W AR42.10-P-0220MMI AR42.10-P-0240CW AR42.10-P-0240CMG AR42.10-P-0240EW
5	Remove brake shoes (8) of parking brake	Model 204	AR42.20-P-0530CW

		Model 207	AR42.20-P-0530EW AR35.20-P-0130-06SX
6	Pull rear axle shaft flange (4) out of angular contact ball bearing (5)	Press Puller	*202589044310 *211589013300
7	Detach torsion bar linkage (9) from torsion bar (10)		
8	Clamp appropriate rear axle spring	Do not use an impact wrench. Otherwise controlled clamping of the rear axle spring cannot be guaranteed. Tensioning device Clamping plates	AR32.20-P-0200-06CW *202589023100 *211589036300
9	Lift wheel carrier (7) using telescopic lifter and transmission plate until rear axle shaft (2) is approximately horizontal 000 588 11 62 00 Major assembly mount 000 588 10 62 00 Support plate		WS01.00-P-0092B WS26.00-P-3309B
WS WS			
10	Press the rear axle shaft (2) as far as possible out of the angular contact ball bearing (5)		
11	Detach angular-contact ball bearing (5) from wheel carrier (7)	To unscrew the four bolts (6), press the rear axle shaft (2) slightly to one side.	
12	Clean water drain in wheel carrier (7)		AR35.20-P-0115-03CW
13	Pull bearing inner race off the rear axle shaft flange (4)	Puller Thrust piece Collet chuck	AR35.20-P-0130-02TX *001589503300 *124589023400 *211589023400
	Install		
14	Attach angular-contact ball bearing (5) to wheel carrier (7)	Installation: Fit all screws (6) and tighten in a cross pattern. Wheel bearing to wheel carrier	*BA35.20-P-1001-06D
15	Press rear axle shaft (2) into angular-contact ball bearing (5)		
16	Lower wheel carrier(7)		
17	Unclamp rear axle spring	Do not use an impact wrench. Otherwise controlled clamping of the rear axle spring cannot be guaranteed. Tensioning device Clamping plates	AR32.20-P-0200-06CW *202589023100 *211589036300
18	Attach torsion bar linkage (9) to torsion bar (10)	Model 172Nut, link rod to stabilizer bar Model 204 Model 207Nut, link rod to stabilizer bar	*BA32.20-P-1001-04C *BA32.20-P-1002-04N
19	Pull rear axle shaft flange (4) into angular-contact ball bearing (5)	Extraction and insertion tool Insertion tool	AR35.20-P-0130-07SX *210589034300 *211589003300
20	Install parking-brake brake shoes (8)	Model 204, 207 Model 204 Model 207	AR42.20-P-0530CW AR42.20-P-0530EW
21	Install rear brake disk (3)	Model 172 (except 172.466/475) Model 172.466/475 Model 204 (except 204.077/277/377) Model 204.077/277/377 Model 207	AR42.10-P-0220W AR42.10-P-0220MMI AR42.10-P-0240CW AR42.10-P-0240CMG AR42.10-P-0240EW
22	Attach twelve-point collar nut (1) to rear axle shaft (2) and lock Notes on threaded connections fastened using a tightening angle-based tightening process Notes on self-locking nuts and bolts	Replace the twelve-point collar nut (1). Collar nut, rear axle shaft to rear axle shaft flange	AR35.30-P-0115-01TX AH00.00-P-0020-01A AH00.00-P-0001-01KOA *BA35.30-P-1001-01J
AP AP			
23	Attach corresponding rear wheel	Model 172 Model 204, 207	AP40.10-P-4050V AP40.10-P-4050CW
24	Remove vehicle lift safety device from vehicle	Model 172	AR00.60-P-0100T

Nm Rear axle torsion bar

Number	Designation	Model 172
BA32.20-P-1001-04C	Nut, link rod to stabilizer bar	Nm 30

Nm Rear axle torsion bar

Number	Designation	Model 204 (except 204.077/277/377)	Model 204.077/277/377
BA32.20-P-1002-04N	Nut, link rod to stabilizer bar	Nm 50	50

Nm Rear axle torsion bar

Number	Designation	Model 207
BA32.20-P-1002-04N	Nut, link rod to stabilizer bar	Nm 50

Nm Hub

Number	Designation	Model 172	Model 204
BA35.20-P-1001-06D	Wheel bearing to wheel carrier	Nm 70	70

Nm Hub

Number	Designation	Model 207
BA35.20-P-1001-06D	Wheel bearing to wheel carrier	Nm 70

Nm Rear axle shaft

Number	Designation	Model 172	Model 204	
BA35.30-P-1001-01J	Collar nut, rear axle shaft self-locking	Nm 350	350	
	not self-locking	Stage 1	Nm –	170
		Stage 2	Δ° –	45

Nm Rear axle shaft

Number	Designation	Model 207	
BA35.30-P-1001-01J	Collar nut, rear axle shaft self-locking	Nm 350	
	not self-locking	Stage 1	Nm 170
		Stage 2	Δ° 45

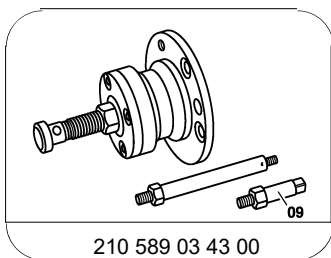

210 589 03 43 00

Extraction and insertion tool

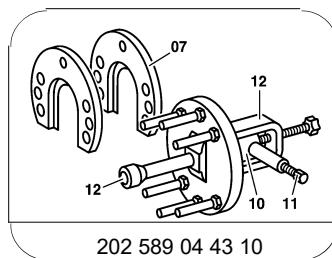

202 589 04 43 10

Press

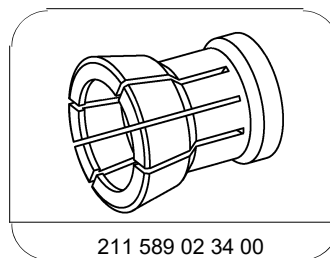

211 589 02 34 00

Collet chuck

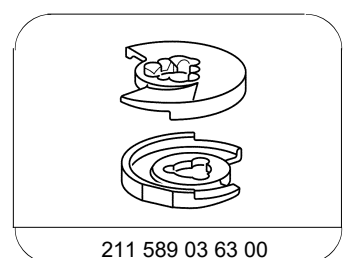

211 589 03 63 00

Clamping plates

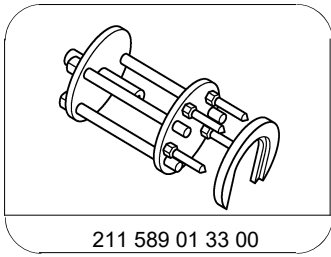

Puller

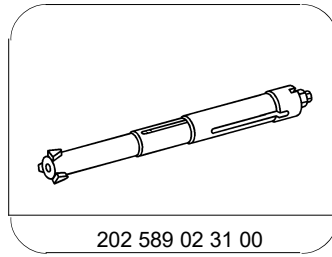

Tensioning device

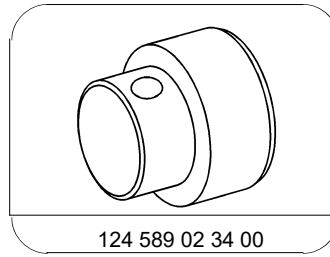

Thrust piece

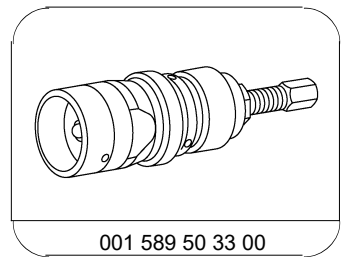

Puller

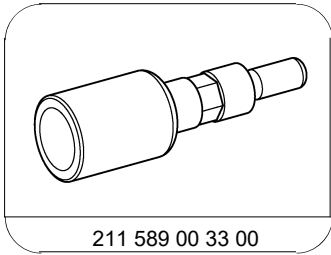

Insertion tool