

AR35.20-P-0130-06SX	Pull rear axle shaft flange out of angular contact ball bearing		
---------------------	---	--	--

**Model 172, 204, 207, 212, 217, 218, 222, 231**  
**Model 216 (except 216.379)**  
**Model 221 (except 221.179)**  
**except code Z07 (B7 armoring on special protection version)**

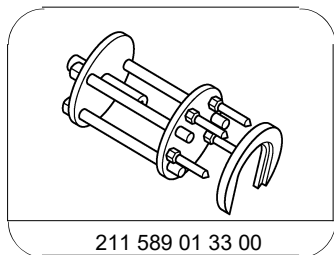

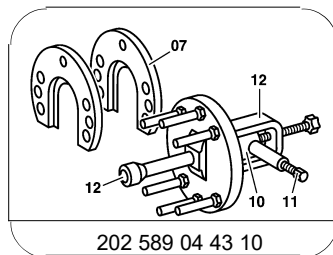

211 589 01 33 00

Puller



202 589 04 43 10

Press

**i** Use the following special tools:  puller and  press (04)

- 1 Position support (01) behind rear axle shaft flange (1).
- 2 Screw retaining bolts (03) into the rear axle shaft flange (1).
- 3 Push guide (05) forwards until the guide pins (02) are fixed in the support (01).
- 4 Insert press (04) and pull rear axle shaft flange (1) out of angular contact ball bearing (2) by turning the spindle (arrow).

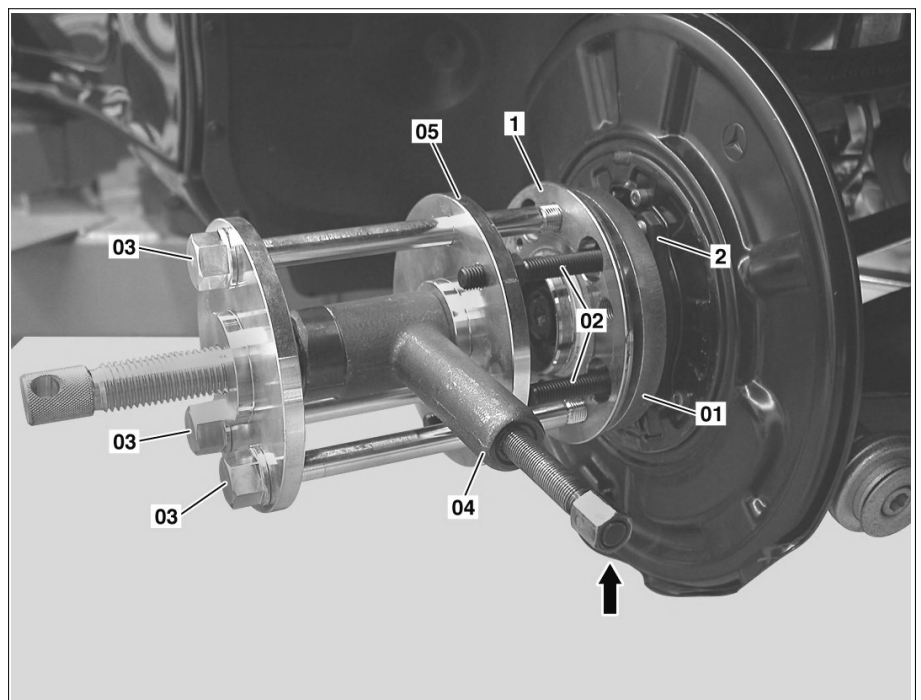

P35.20-2213-06