

MODEL 210

- 1 Cover
- 2 Cushion frame
- 3 Rubberized fiber matting
- 4 Velcro strips
- 5 Upholstery clips

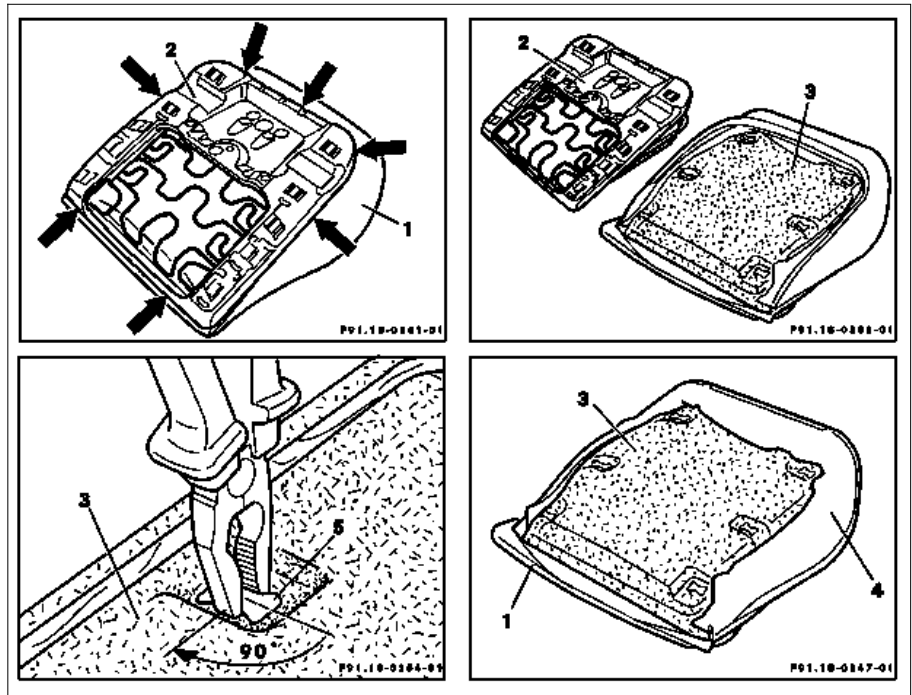

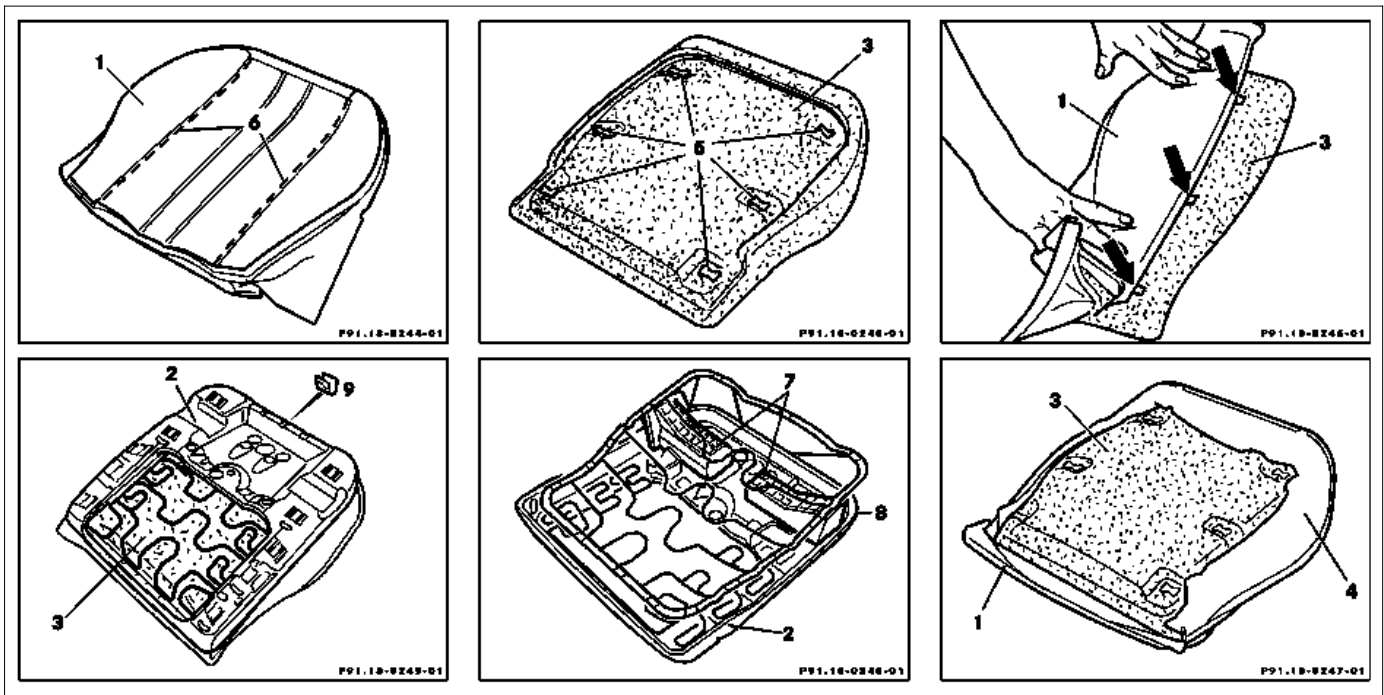





P91.18-0250-06

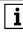

P91.18-0243-09

- 1 Cover
- 2 Cushion frame
- 3 Rubberized fiber matting
- 4 Velcro strips
- 5 Upholstery clips
- 6 Retaining wires
- 7 Foam rubber wedge
- 8 Crepe strip
- 9 Retaining clip

	Removal		
1	Remove seat adjustment mechanism on front seat		AR91.10-P-1450F
2	Lay seat cushion down on suitable surface with cover downward		
3	Unhook cover (1) from clip groove (arrows) in cushion frame (2) all around	 Relieve tension on cover (2) by pushing down cushion frame	
4	Remove cushion frame (2) from rubberized fiber matting (3)		
5	Draw cover (1) over outer edge of rubberized fiber matting (3)		

6	Pull Velcro strips (4) off of rubberized fiber matting (3)		
7	Loosen upholstery clips (5, 6 each), by turning upholstery clip (5) 90° with flat pliers		
8	Remove cover (1) from rubberized fiber matting (3) and pull retaining wires (6) out of cover (1)		
	Installation		
9	Push retaining wires (6) into fabric sleeves on cover (1) and align		
10	Press upholstery clips (5, 6 each) into rear of rubberized fiber matting (3)		
11	Fold cover (1) in on side and position on rubberized fiber matting (3) and align		
 BT	Upholstery filling of seat modified	 Valid only when fitting new seat covers or new rubberized fiber matting	BT91.18-P-0001-01F
 WF	Hook retaining wires (6) into upholstery clips (5) with installation tool Installation tool for retaining wire		WF58.50-P-9118-02A
13	Attach cover (1) to rubberized fiber matting (3) with Velcro strips (4)		
14	Pull cover (1) over outer edge of rubberized fiber matting (3) at sides and front		
15	Insert cushion frame (2) into rubberized fiber matting (3)	 Foam rubber wedge (7, 2 each) inserted in cushion frame (2)	
16	Hook cover (1) into clip groove all the way around while pushing the cushion frame (2) down and also insert one retaining clip (9) at the front	 Sheet metal edge on clip groove at front left and right covered with crepe strip (8)	
17	Install seat adjustment mechanism on front seat		AR91.10-P-1450F
18	Install front seat		AR91.10-P-1000F