



Mercedes-Benz

- [Door Panel](#)
- [Overhead Control Panels](#)
- [Brake Light](#)
- [Center Console](#)
- [Audio Unit & Control Panel](#)
- [Instrument Cluster](#)
- [Center Vent Assembly](#)
- [Dashboard](#)

- Introduction
- Keyless Go
- SBC Brakes
- SAS
- Dual Battery
- Networking
- FSS
- Climate Control
- Component Location
- Distronic Cruise Control
- Walk Around
- ▶ [Disassembly Procedures](#)
- W211 Information Access
- Home

◀ DISASSEMBLY MAIN MENU

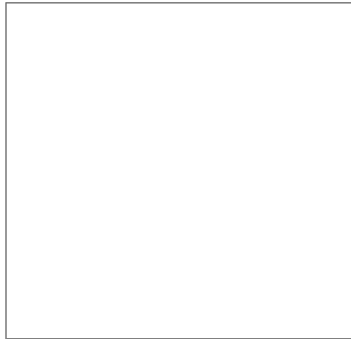

Wood Trim



1. Unclip the trim near the steering wheel using the plastic wedge and slide it to the right.



2. Pry up the trim with the wedge.

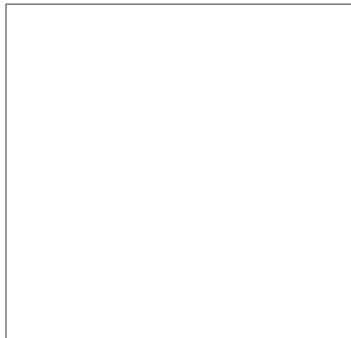

Center Vent Assembly



1. Use the instrument cluster hooks to remove the center speaker grill.



2. Remove the speaker.



3. Loosen two screws at the top and two at the bottom of the center vent assembly.

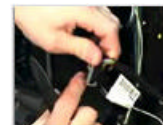

4. Remove the electrical connectors from the back of the assembly.