

MODEL 211.004 /006 /016 /023,

211.026 as of 1.9.03,

211.042 /043 /061,

211.065 as of 1.9.03,

211.080 /082 /083 /084 /087 /089 /092 /206 /216 /242 /243 /261 /280 /282 /283 /284 /287 /289 /292 /6 06

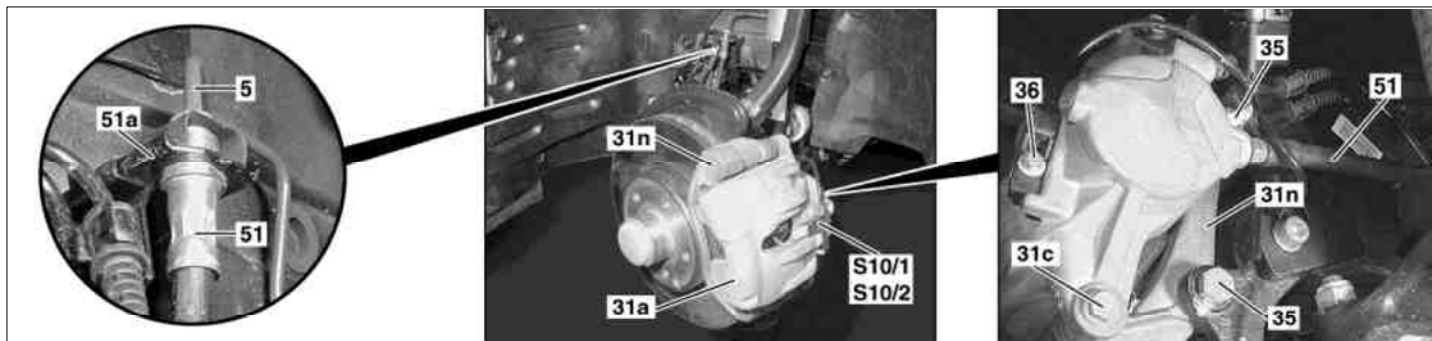

P42.10-2150-07

**Shown on model 211 without 4MATIC**

5 Brake line

31a Floating caliper

31c Bolt

31n Floating caliper support

35 Bolts

36 Bolt

51 Brake hose

51a Bracket

S10/1 Left front brake pad contact sensor

S10/2 Right front brake pad contact sensor

**Shown on model 211 with 4MATIC**

4 Caps

6 Floating brake caliper brake line

31a Floating caliper

31n Floating caliper support

35 Bolts

36 Bolt

51 Brake hose

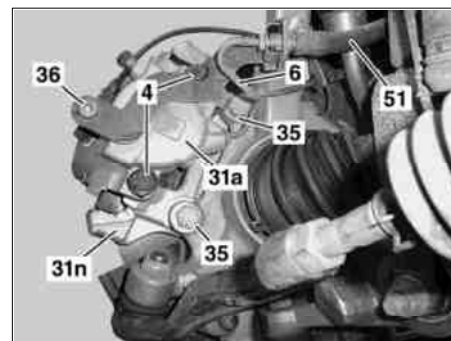

P42.10-2506-01

	<b>Remove/install</b>		
<b>Danger!</b>	<b>Risk of death</b> caused by vehicle slipping or toppling off of the lifting platform.	Align vehicle between the columns of the lifting platform and position the four support plates at the lifting platform support points specified by the vehicle manufacturer.	AS00.00-Z-0010-01A
<b>Danger!</b>	<b>Risk of injury</b> caused by body parts being jammed or crushed. <b>Risk of injury</b> to skin and eyes caused by brake fluid spraying out at high pressure when working on the SBC brake system	Deactivate SBC brake system using STAR DIAGNOSIS.	AS42.46-Z-0001-01A
	Notes on self-locking nuts and bolts	All models	AH00.00-N-0001-01A
1	Deactivate SBC brake system using STAR DIAGNOSIS.	The following steps should be run through in STAR DIAGNOSIS: Select menu item "SBC-Sensotronic Brake Control"/"Deactivate 'SBC' system". Then process all the individual steps from top to bottom. All models STAR DIAGNOSIS diagnosis system	AH42.00-P-0003-01A *WE58.40-Z-1013-06A
	Notes on repairs to brake system		
2	Remove front wheel Remove/install wheels, rotate if necessary		AP40.10-P-4050Z
	Remove brake hose (51)	Except model 211.08 /09 /28 /29	AR42.10-P-0013T

3.2 ⓘ	Detach brake hose (51) from floating brake caliper brake line (6) Notes on installation of brake hoses	Model 211.08 /09 /28 /29  ⓘ Seal brake hose (51) immediately with stop plugs. The brake fluid expansion reservoir must not run empty otherwise air gets into the brake system. Nm Brake line to floating brake caliper 🔧 Box wrench 🔧 Set of plugs	AH42.10-P-9406-01A  *BA42.10-P-1010-04A *000589760300 *129589009100
4	Separate left front brake pad contact sensor (S10/1) or right front brake pad contact sensor (S10/2) at their connector		
5.1 ⓘ	Detach electrical feed line of left or right front brake pad contact sensor from floating brake caliper (31a) Note on installing contact sensor for brake lining wear indicator	Except model 211.08 /09 /28 /29  ⓘ <b>Installation:</b> Replace bolt. Nm Self-locking bolt, brake pad wear sensor to floating caliper brake carrier.	AH42.10-P-0003-01A  *BA42.10-P-1005-03A
5.2 ⓘ	Unscrew bolt (36) from bracket and remove bracket and brake pad contact sensor Note on installing contact sensor for brake lining wear indicator	Model 211.08 /09 /28 /29  ⓘ <b>Installation:</b> The bracket must abut the floating brake caliper (31a). Replace bolt (36) of bracket. Nm Bolt, brake hose clip to floating brake caliper	AH42.10-P-0003-01A  *BA42.10-P-1009-04A
6	Remove brake pads from the front axle		AR42.10-P-1600T
7.1	Undo bolt (31c) of guide pin	Except model 211.08 /09 /28 /29 ⓘ <b>Installation:</b> Replace bolt (31c). Nm Guide pins, floating caliper to caliper support	*BA42.10-P-1004-03A
7.2	Remove cover caps (4) and unscrew guide bolt	Model 211.08 /09 /28 /29 ⓘ <b>Installation:</b> Replace the guide bolts. Nm Guide pins, floating caliper to caliper support	*BA42.10-P-1004-03A
8	Remove floating brake caliper		
9.1	Unscrew bolts (35) and take off floating caliper mount (31n)	ⓘ Only if necessary. ⓘ <b>Installation:</b> install new bolts (35). Nm Self-locking bolt, caliper support to steering knuckle	*BA42.10-P-1001-03A
10	Install in the reverse order		
11	Bleed brake system with STAR DIAGNOSIS	ⓘ The following steps should be run through in STAR DIAGNOSIS: Select menu item "Initial startup after repair"/"Exchanging brake calipers". Then process all the individual steps from top to bottom.	
		ⓘ When performing the bleeding operation, it is essential to observe the instructions in the document "Bleeding brake system using STAR DIAGNOSIS": - Bleed brake system with STAR DIAGNOSIS STAR DIAGNOSIS diagnosis system	AR42.10-P-0012R *WE58.40-Z-1013-06A

**Nm Front axle floating caliper**

Number	Designation	Models
		211.004/006/ 016/020/022/ 023/042/043/ 061/206/216/ 220/222/242/ 243/261/606 models 211.026/065 as of 01.09.03

BA42.10-P-1001-03A	Self-locking bolt, caliper support to steering knuckle	Nm	115
BA42.10-P-1004-03A	Guide pins, floating caliper to caliper support	Nm	27
BA42.10-P-1005-03A	Self-locking bolt, brake pad wear sensor to floating caliper brake carrier	M6 Nm	8
		M8 Nm	-

**Nm Front axle floating caliper**

Number	Designation	Model 211.080/082/ 084/087/089/ 092/280/282/ 284/287/289/ 292	Model 211.083/283
BA42.10-P-1001-03A	Self-locking bolt, caliper support to steering knuckle	Nm	110
BA42.10-P-1004-03A	Guide pins, floating caliper to caliper support	Nm	27
			180
			40

**Nm Brake lines, brake hoses**

Number	Designation	Model 211.08/09/ 28/29
BA42.10-P-1009-04A	Bolt, brake hose clip to floating brake caliper	Nm 20
BA42.10-P-1010-04A	Brake line to floating brake caliper	Nm 14

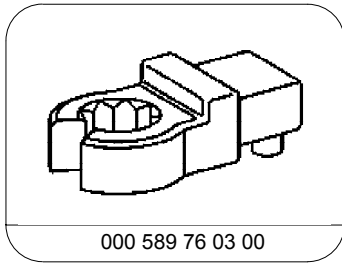

Ring wrench

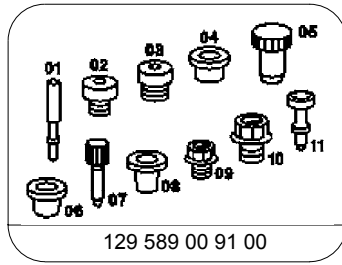

Set of plugs

**Workshop equipment/MB testers** (see Workshop Equipment Manual)

WE58.40-Z-1013-06A	STAR DIAGNOSIS Compact diagnosis system for passenger cars, order number 6511 1801 00
--------------------	---