

**MODELS 211.0 /2 /6 with CODE (819a) CD changer**

- 1 Ashtray housing
- 2 Fiber optical cable connection
- 3 Bracket
- 4 Electrical connectors
- 5 Screw
- 6 Locking clip
- (only with CD changer up to generation Q4)

A2/6 CD changer

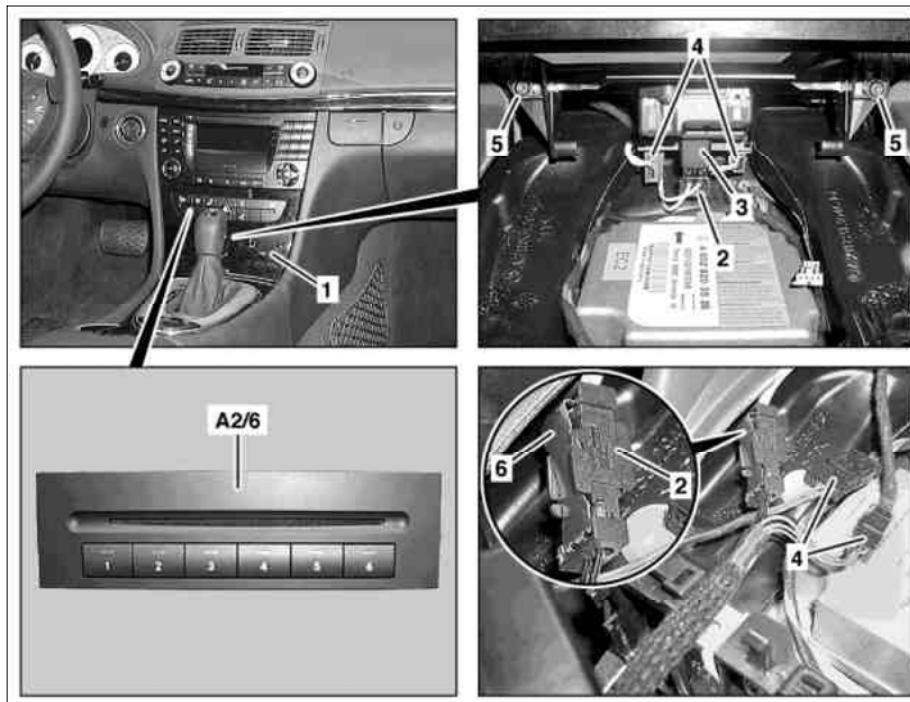

P82.62-2450-06

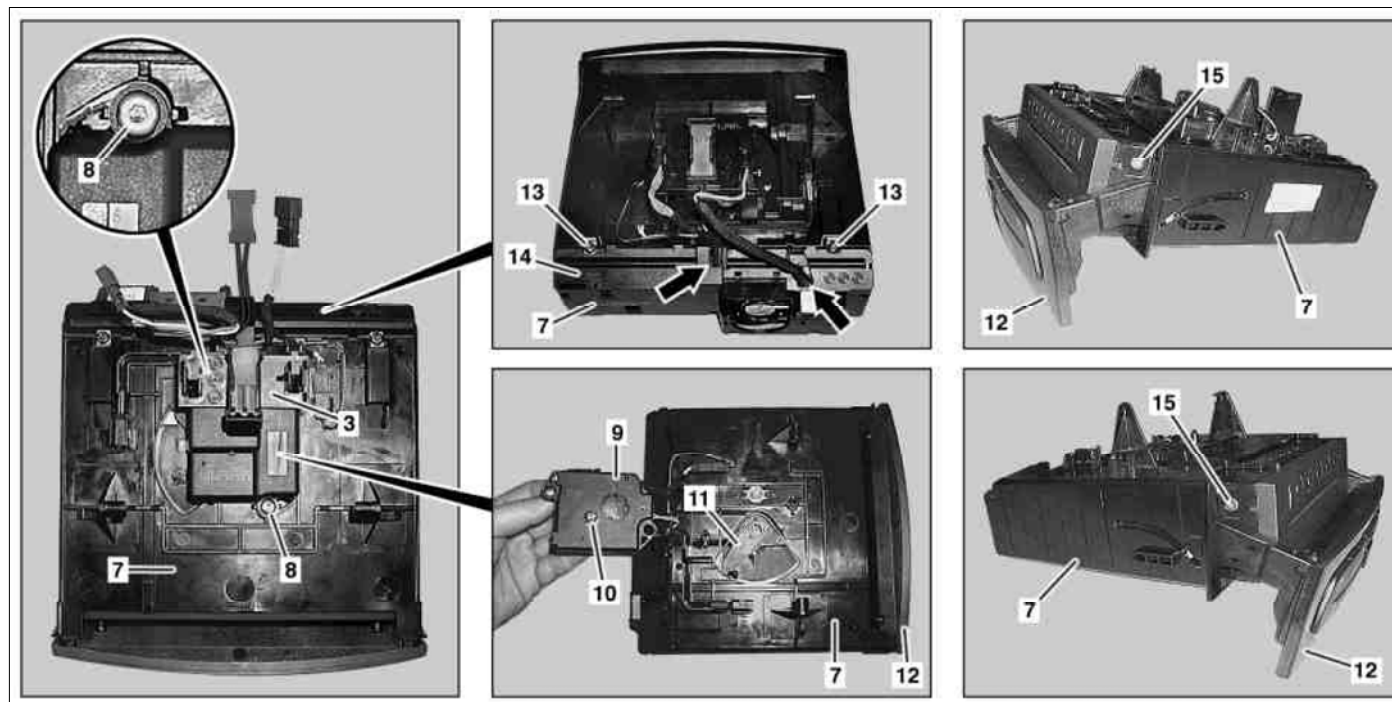

P82.62-2451-09

- 3 Bracket
- 7 Bracket
- 8 Screw

- 9 Motor
- 10 Shaft
- 11 Lever

- 12 Flap
- 13 Screw
- 14 Cover with fan
- 15 Screw

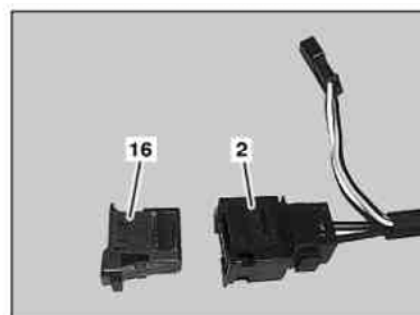
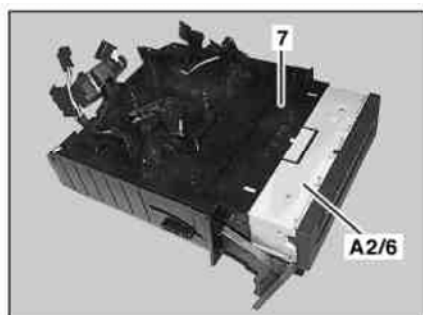

P82.62-2452-07







- 2 Fiber optical cable connection
- 7 Bracket

16 Adapter

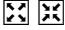
A2/6 CD changer

**Modification notes**

18.3.03	Repair method has been revised		
---------	--------------------------------	--	--

	Remove/Install		
	Notes on avoiding damage to electronic components due to electrostatic discharge		AH54.00-P-0001-01A
1	Remove ashtray housing (1) from front center console		AR68.20-P-2400T
2	Unclip fiber optical cable coupling (2) forwards out of the bracket (3)		
3	Unclip electrical connector (4) from the bracket (3)		
4	Unscrew bolts (5)		
5	Pull the CD changer (A2/6) from the center console until the fiber optic cable coupling (2) and the electrical connectors (4) are accessible		
6	Disconnect electrical connectors (4).		
7.1	Unlock locking clip (6)	Only with CD changer (A2/6) up to generation Q4.	
8	Disconnect fiber optical cable coupling (2) and remove CD changer (A2/6) with bracket (7)	 <b>Installation:</b> When replacing the CD changer (A2/6) up to version Q4 by one from version Q5 (arrow), an adapter (16) must be inserted into the fiber optical cable coupling (2). The adapter is available (16) as a replacement part.	
9	Cover fiber optic cable		AR82.95-P-0005-01A
10	Unclip and remove bracket (3) from bracket (7)		
11	Unclip cover with fan (14) from bracket (7) and put to one side	 Do not detach cover with fan (14) completely.   <b>Installation:</b> Do not trap electrical wiring harnesses (arrows).	
12	Unscrew bolts (8) and detach motor (9) from lever (11) of bracket (7)	 <b>Installation:</b> The gearing of the shaft (10) must engage in the lever (11) of the bracket (7).	
13	Open flap (12) completely		
14	Unscrew bolts (13) and bolts (15) on bracket (7)		
15	Remove CD changer (A2/6) from bracket (7)		
16	Install in the reverse order		