

Practical hints

Where will I find ...?

Vehicles with TIREFIT

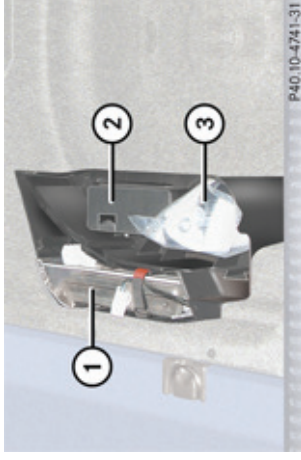

- ① Jack and tools
- ② Electric air pump
- ③ TIREFIT kit

- ▶ **To access remaining tools:** Remove jack ①.

Collapsible wheel chock

The collapsible wheel chock serves to secure the vehicle, e.g. while changing a wheel.

- ▶ Take the collapsible wheel chock from the vehicle tool kit (▶ page 290).



- ① Tilt the plates upward
 - ② Fold the lower plate outward
 - ③ Insert the plate
- ▶ **Setting up:** Tilt both plates upward ①.
 - ▶ Fold the lower plate outward ②.
 - ▶ Guide the tabs of the lower plate all the way into the openings of base plate ③.

For information on where to place wheel chocks when changing a wheel, see “Lifting the vehicle” (▶ page 360).

Jack



Warning!

Only use the jack supplied with your vehicle to lift the vehicle briefly for wheel changes. If you use the jack for any other purpose,

you or others could be injured, as the jack is designed only for the purpose of changing a wheel.

When using the jack, observe the safety notes in the “Mounting the spare wheel” section and the notes on the jack.

- ▶ Take the jack from the vehicle tool kit (▶ page 290).

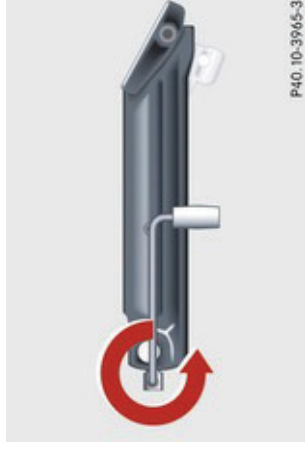

Storage position

- ▶ Turn the crank handle in the direction of arrow as far as it will go.