

MODEL 211.0 /2 /6  
as of model year 04

- 1 Screwdriver
- 2 Steering column switch module
- 3 Locking pin

A45 Fanfare horns and airbag clock spring contact

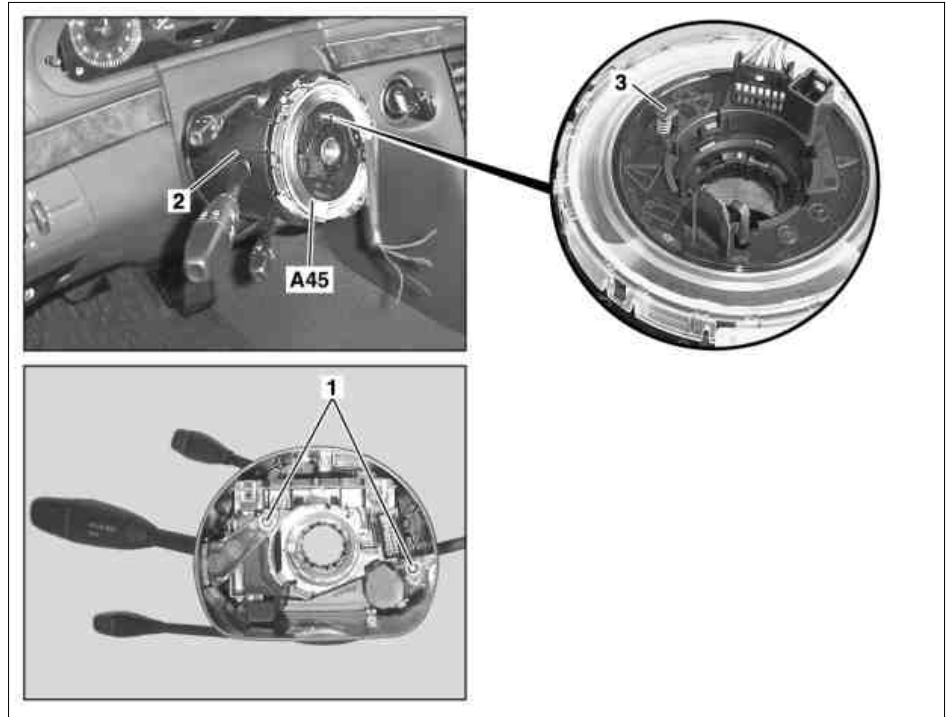

P46.10-2621-06

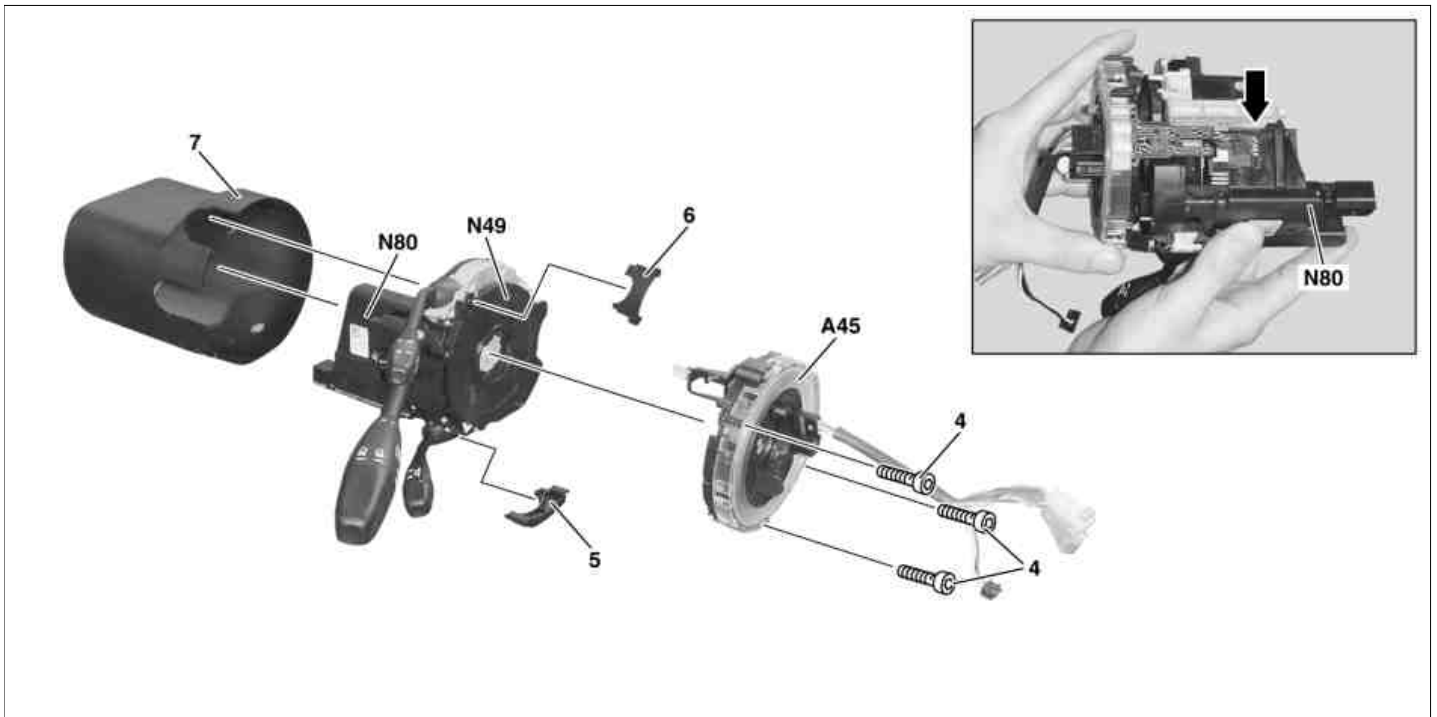



P46.10-2569-09

- 4 Screwdriver
- 5 Cover
- 6 Cover
- 7 Steering column switch module trim
- A45 Fanfare horns and airbag clock spring contact
- N49 Steering angle sensor
- N80 Steering column module

#### Modification notes

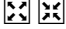
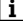
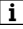
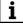
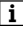
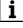
14.2.07	Information "Replace clock spring contact" replaced by information "Move clock spring contact into center position"	Step 6	
---------	---	--------	--

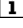
	<b>Remove/install</b>		
1	Remove steering wheel		AR46.10-P-0100T
2	Remove jacket tube switch module (2)	 <b>Installation:</b> Slide steering column switch module (2) complete with clock spring contact (A45) onto steering column tube and screw in mounting screw.	AR54.25-P-2800-01TA
3	Unscrew bolts (1) from steering column switch module (2)	 Do not operate locking pin (3) as this is the anti-twist lock of the clock spring contact (A45).	
4	Remove paneling (7) of steering column switch module (2)	 <b>Installation:</b> Pay attention to correct seating of coverings (5, 6).	
5	Unscrew bolts (4) from steering column switch module (2)		
6	Remove clock spring contact (A45)	 <b>Installation:</b> If the clock spring contact (A45) was twisted, bring the clock spring contact (A45) into the center position before reinstalling: ↓ Turn clock spring contact (A45) clockwise up to the limit stop (turn gently against the limit stop, risk of damage), then turn counterclockwise until the arrows are opposite one another and the cable loop with black points is visible in the window.  <b>Installation:</b> When fitting the clock spring contact (A45) check for correct seating of the plug contacts on the steering column module (N80) (arrow).	
	<b>Checking</b>		
7	Check the spiral contact coil (A45) for damage	 Visual inspection, if necessary replace clock spring contact (A45).	
8	Install in the reverse order		