

AR00.19-P-0120-02B

Removing contacts from sensor laminated contact socket

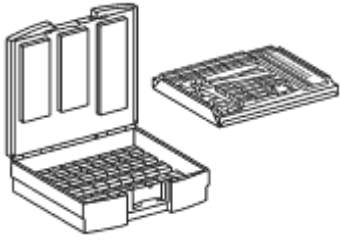

220 589 01 99 00

Wiring harness repair set

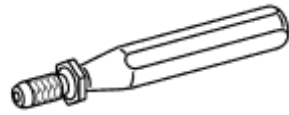

220 589 01 99 50

Blade holder with clamping pliers

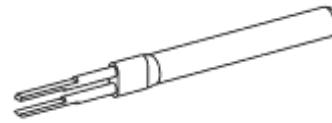

220 589 01 99 62

SLK blade 2.8

### Secondary unlocking in version with locking bar (SLK)

1 Push locking bar retaining tabs (1) out of catch in direction of arrow using suitable tool.

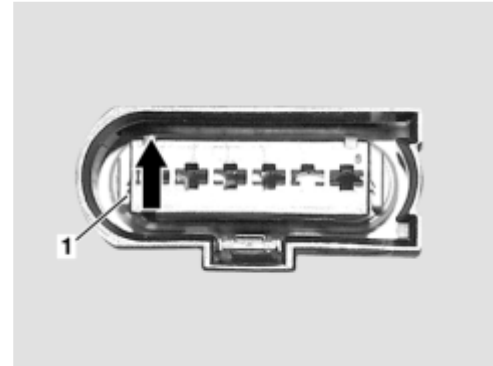

P54.18-2475-01

Shown on 6-pin SLK coupling

### Secondary unlocking in version with locking bar (SLK)

1 Push locking bar (2) on in direction of arrow using suitable tool.

Pushing the tool (1) in too far can damage the seal. Pushing the locking bar (2) over the stop can destroy the locking bar (2).

The locking bar (2) remains locked when removing the female contacts.

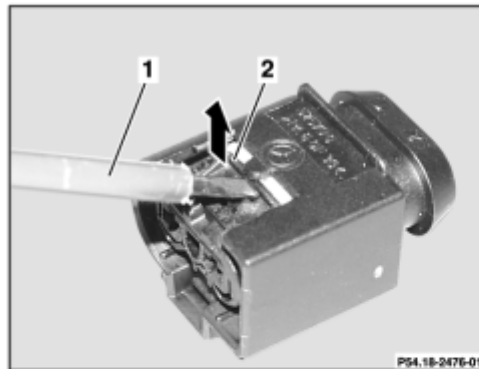

P54.18-2476-01

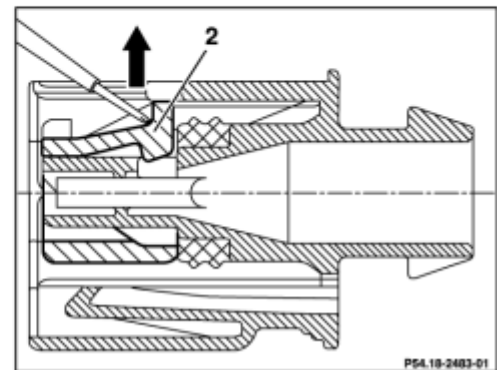

P54.18-2483-01

P54.18-2484-05

Shown on 2-pin SLK coupling

### Removing female contacts from coupling (SLK)

1 Insert unlocking tool from the front through the openings in the coupling contact chamber (1).

This pushes the spring tabs at the female contact (2) together.

2 Remove female contact from coupling by pulling gently on the relevant cable.

**Installation:** Make sure the contact pin is properly engaged in the housing by pulling gently on the cable.

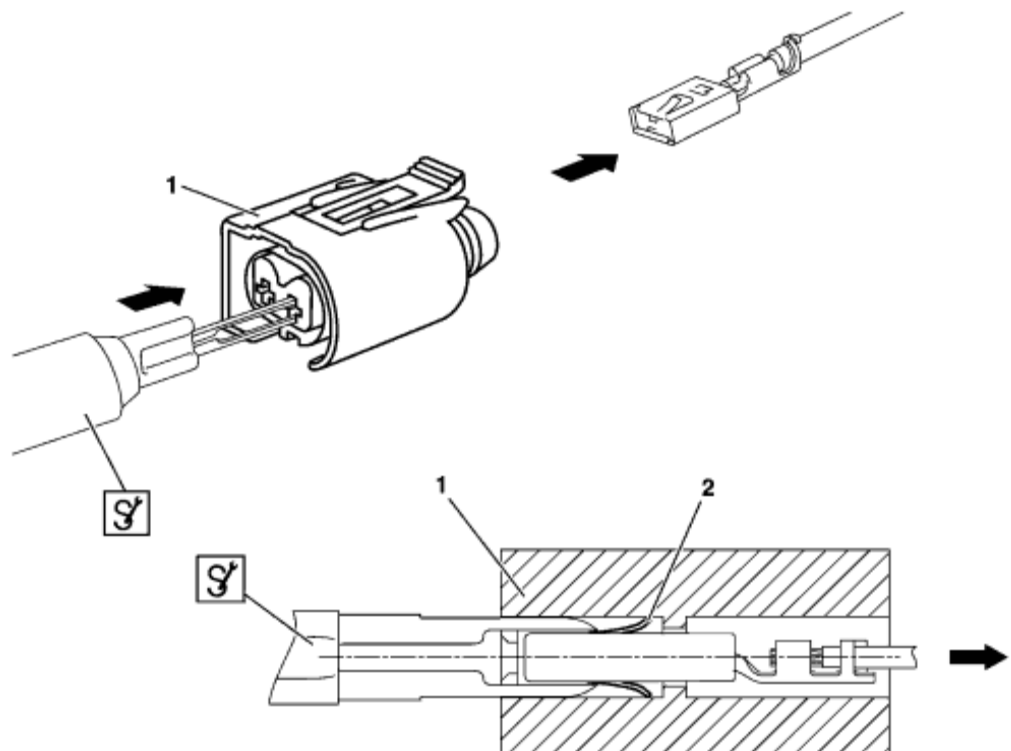

P54.18-2563-06