

MODEL 211.0 /2 /6 up to 1.6.08  
 except CODE (809) Model year 2009  
 with CODE (819) CD changer

- 1 Ashtray housing
- 2 Fiber-optic cable connection
- 3 Bracket
- 4 Electrical connectors
- 5 Screw
- 6 Safety clamp  
(only with CD changer up to generation Q4)

A2/6 CD changer

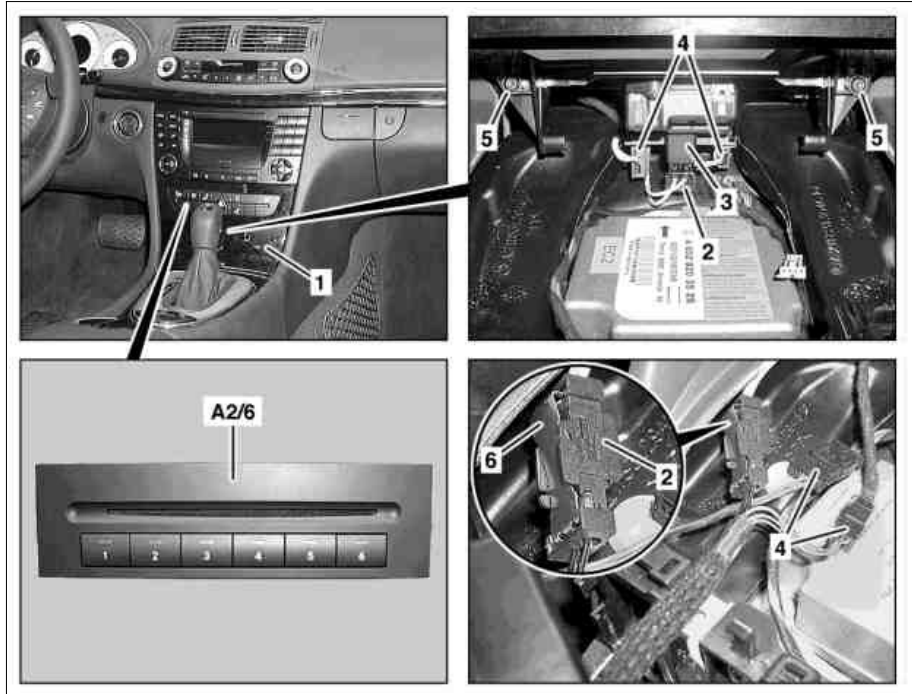

P82.62-2450-06

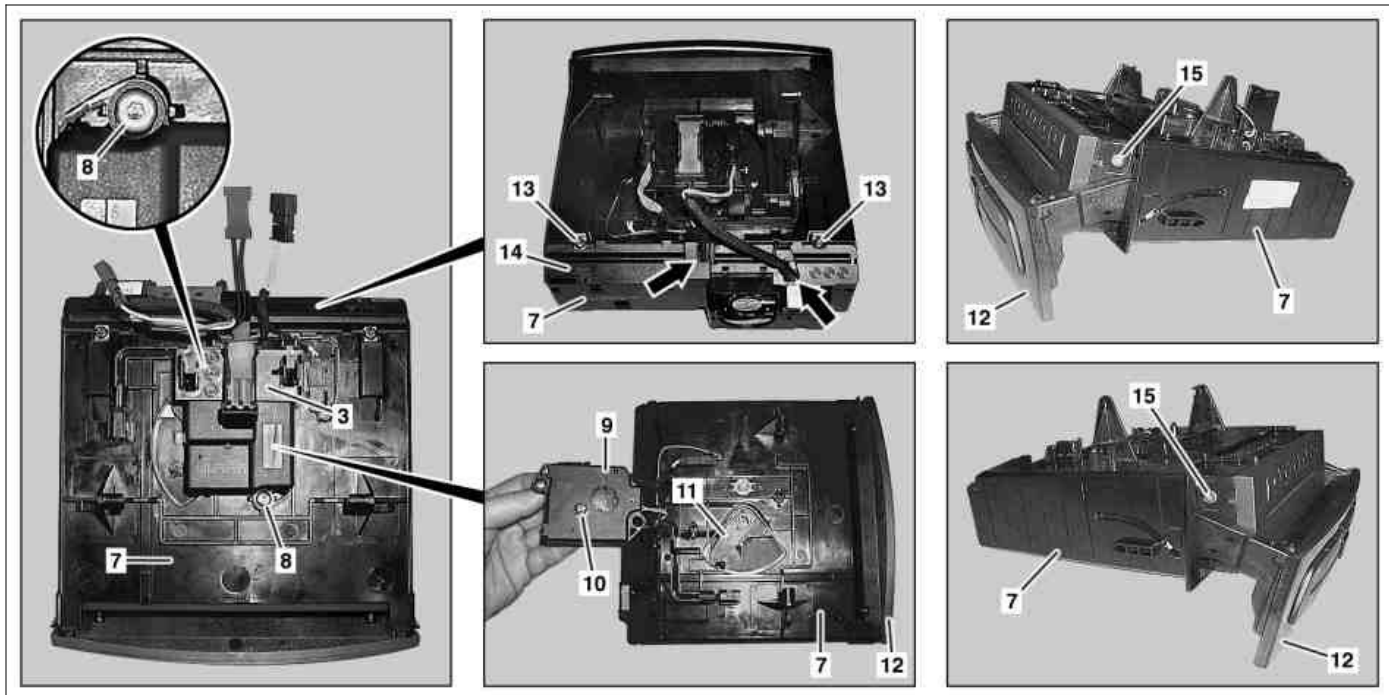

P82.62-2451-09

- 3 Bracket
- 7 Bracket
- 8 Screw

- 9 Engine
- 10 Shaft
- 11 Lever

- 12 Flap
- 13 Screw
- 14 Cover with fan
- 15 Screw

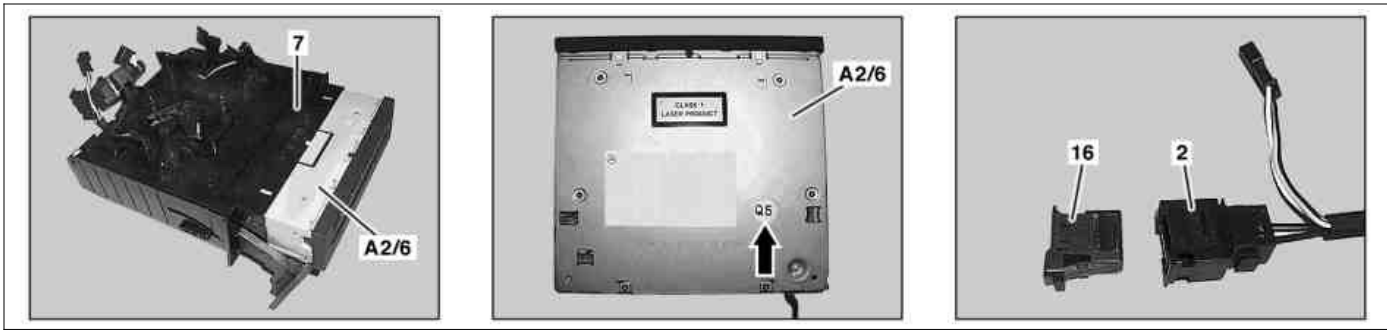

P82.62-2452-07

2 Fiber-optic cable connection  
7 Bracket

16 Adapter

A2/6 CD changer

☒ ☒	Remove/install		
ⓘ	Information on preventing damage to electronic components due to electrostatic discharge		AH54.00-P-0001-01A
1	Remove ashtray housing (1) from front center console		AR68.20-P-2400T
2	Unclip fiber optic cable (2) from bracket (3) towards the front		
3	Unclip electrical connector (4) from bracket (3)		
4	Remove bolts (5)		
5	Pull CD changer (A2/6) out of center console until the fiber optic cable connector (2) and the electrical connectors (4) are accessible		
6	Separate electrical connectors (4)		
7	Release safety clamp (6)	Only with CD changer (A2/6) up to generation Q4.	
8	Disconnect fiber optic cable connector (2) and remove CD changer (A2/6) with bracket (7)	<p>ⓘ To avoid damaging the fiber optic cable, do not kink fiber optic cable, route over sharp edges or bend in radii smaller than 25 mm.</p> <p>ⓘ <b>Installation:</b> When replacing the CD changer (A2/6) up to generation Q4 with a CD changer as of generation Q5 (arrow), an adapter (16) must be inserted into the fiber optic cable connector (2). The adapter (16) is available as a replacement part.</p>	
9	Cover fiber optic cable		AR82.95-P-0005-01A
10	Unclip and remove bracket (3) from holder (7)		
11	Unclip cover with fan (14) from holder (7) and place to one side	<p>ⓘ Do not completely remove cover with fan (14).</p> <p>ⓘ <b>Installation:</b> Do not clamp electrical wiring harnesses (arrows).</p>	
12	Remove bolts (8) and detach motor (9) from lever (11) of holder (7)	<p>ⓘ <b>Installation:</b> Toothing of shaft (10) must engage in lever (11) of holder (7).</p>	
13	Open cover (12) all the way		
14	Remove bolts (13) and bolts (15) from holder (7)		
15	Remove CD changer (A2/6) from holder (7)		
16	Install in the reverse order		