

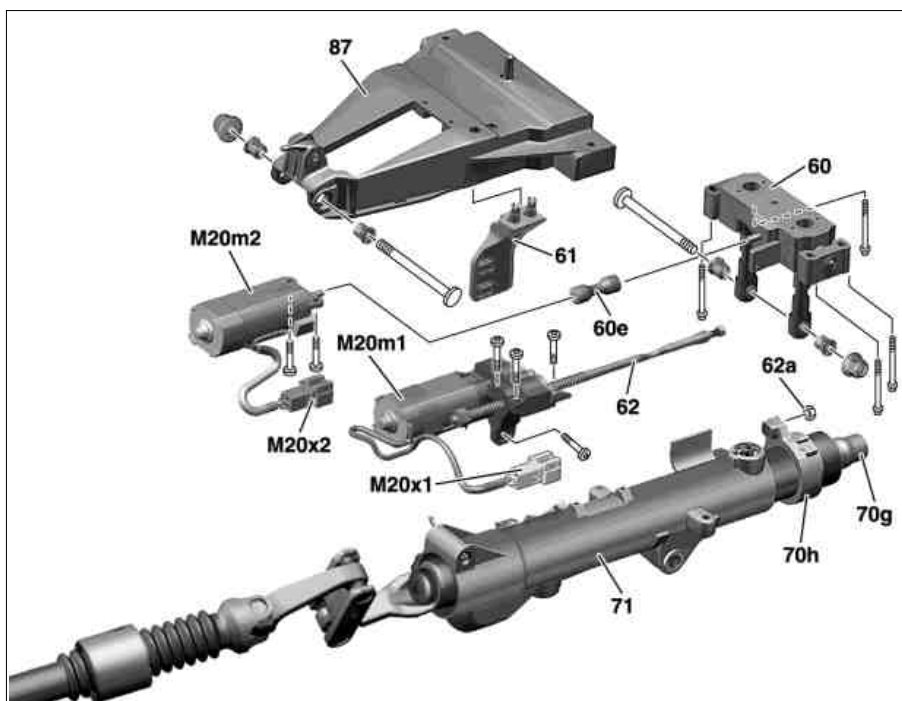





MODEL 211.0 /2 /6 with CODE (275) Memory package (driver's seat, steering column, mirrors)

60	Height adjustment gear mechanism
60e	Gear mechanism coupling
61	Cable holder
62	Link rod
62a	Nut
70g	Upper steering shaft
70h	Jacket tube bracket
71	Jacket tube
87	Mounting
M20m1	Fore/aft adjustment motor
M20x1	Fore/aft adjustment motor connector
M20m2	Height adjustment up/down motor
M20x2	Height adjustment up/down motor connector

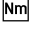
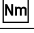
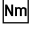

P46.15-2170-06

 	Disassemble/assemble		
1	Remove jacket tube		AR46.10-P-0400T
2	Detach mounting (87) from jacket tube (71)	 Height adjustment motor gear mechanism to jacket tube  Mounting to jacket tube	AR46.10-P-0600-10T *BA46.10-P-1004-03K *BA46.10-P-1005-03K
3	Remove fore/aft adjustment motor (M20m1).	Dimension between jacket tube and bracket on upper steering shaft  Fore/aft adjustment motor to jacket tube  Nut, link rod to jacket tube bracket	AR46.10-P-0600-03T *BE46.10-P-1001-03B *BA46.10-P-1006-03K *BA46.10-P-1007-03K
4	Remove height adjustment up/down motor (M20m2).		AR46.10-P-0600-05T *BA46.10-P-1009-03K
5	Remove height adjustment gear mechanism (60).		AR46.10-P-0600-06T *BA46.10-P-1010-03K
6	Assemble in reverse order		

## Test values for jacket tube

Number	Designation	Model 211
BE46.10-P-1001-03B	Dimension "x" between jacket tube and bracket on upper steering shaft	60
	See picture in	-

 Jacket tube

Number	Designation	Model 211
--------	-------------	-----------

BA46.10-P-1004-03K	Height adjustment motor gear mechanism to jacket tube	1st stage	Nm	8
		2nd stage	Nm	3
		Assembly note	refer to	-
BA46.10-P-1005-03K	Mounting to jacket tube	1st stage	Nm	8
		2nd stage	Nm	3
		Assembly note	refer to	-
BA46.10-P-1006-03K	Fore/aft adjustment motor to jacket tube		Nm	4
BA46.10-P-1007-03K	Nut, link rod to jacket tube bracket		Nm	4
BA46.10-P-1009-03K	Height adjustment motor to mounting		Nm	4
BA46.10-P-1010-03K	Height adjustment motor gear mechanism to mounting		Nm	10