

MODEL 211.0/ 2/ 6

Shown without memory package

- 1 Bolt
- 2 Steering coupling
- 3 Lower steering shaft
- 4 Locking plate
- 6 Connector
- 7 Toggle
- 8 Grip arm
- 9 Bolt
- 10 Steering column adjustment
- 11 Bolts
- 12 Jacket tube
- 13 Cover
- 14 Nut

N26/5 Electric steering lock control unit

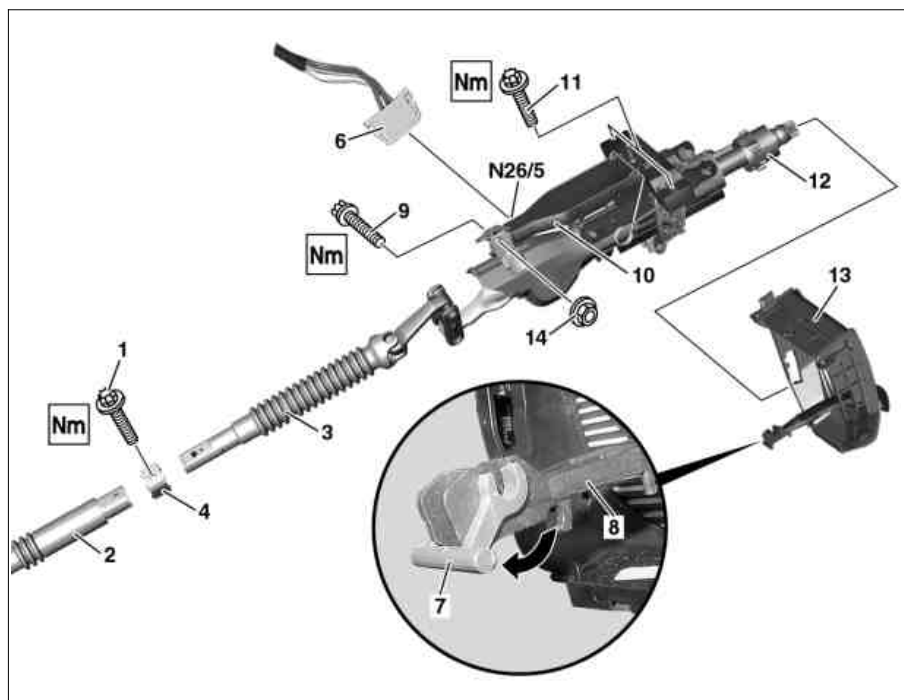

P46.10-2384-06

For memory package (driver seat, steering column, mirrors), code 275

X4/39 Steering column adjustment connector

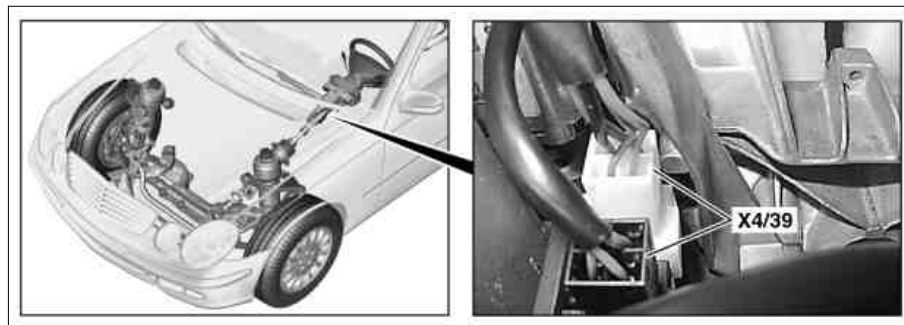

P46.10-2383-04

Modification notes

14.2.05	When replacing the jacket tube, the mechanical steering column lock has to be adjusted	Step 17.1	
---------	--	-----------	--

Icons	Remove/install		
⚠	Notes on self-locking nuts and bolts		AH00.00-N-0001-01A
1	Extend or pull out adjustable steering column fully	i Required to separate the steering coupling (2) from the lower steering shaft (3).	
2	Position steering wheel horizontal	i The front wheels must be in the straight-ahead position.	
3.1	Remove bottom section of sound-proofing capsule	Vehicles with diesel engines	AR94.30-P-5300T
3.2	Remove engine compartment paneling	Vehicles with gasoline engines	AR61.20-P-1105T
4	Remove screw (1)	Nm Bolt, steering coupling to steering shaft	*BA46.10-P-1001-01E
5	Pull lower steering shaft (3) upwards out of steering coupling (2)	<p>⚠ Do not use force (hammer blows, severe leverage) as the lower steering shaft (3) is sensitive to the effects of side force.</p> <p>⚠ When the steering coupling (2) is detached the steering wheel must not be twisted as the fanfare horns and airbag clock spring contact may be damaged.</p> <p>i Installation: Turn rack-and-pinion steering to center position.</p>	AR46.20-P-0600-01P

		i Installation: Insert lower steering shaft (3) fully into the steering coupling (2); pay attention to the studs of the steering coupling (2) and groove of the lower steering shaft (3).	
6	Pull locking plate (4) off the steering coupling (2), in doing so lift up the lug on the locking plate (4) using a suitable tool.	i Installation: Replace locking plate (4) with self-locking nut. Push on locking plate (4) until its lug engages in the steering coupling (2).	
7	Remove steering wheel		AR46.10-P-0100T
8	Remove steering column switch module	Vehicles up to model year 04 Vehicles as of model year 04	AR54.25-P-2800-01T AR54.25-P-2800-01TA
9	Remove instrument cluster		AR54.30-P-6015T
10	Remove left cover below instrument panel		AR68.10-P-1500T
11	Disconnect plug (6) from electric steering lock control unit (N26/5)		
12.1	Disconnect steering column adjustment connector (X4/39)	Vehicles with memory package (driver's seat, steering column, mirrors) code 275	
13.1	Remove cover (13).	Vehicles with memory package (driver's seat, steering column, mirrors) code 275	
14.1	Swivel locking handle (7) forwards until it latches in the handle arm (8) (arrow).	Vehicles without memory package	
15.1	Press handle arm (8) downwards carefully to separate it from the jacket tube (12)	Vehicles without memory package	
16	Detach steering column adjustment (10) from crossmember below instrument panel; to do this, unscrew lower bolt (9) and upper bolts (11)	i Installation: Tighten bolt (9) and bolts (11) finger-tight, the jacket tube (12) must remain movable. Tighten the upper bolts first (11). Nm Lower bolt for jacket tube on cross member below instrument panel Nm Upper bolt for jacket tube on cross member below instrument panel	*BA46.10-P-1001-03K *BA46.10-P-1002-03K
17	Remove jacket tube (12) with lower steering shaft (3) upwards	! Do not use force (hammer blows, severe leverage) as the lower steering shaft (3) is sensitive to the effects of side force. i Ensure that the boot remains in the firewall as the pedal assembly has to be removed to reinstall the boot. i Installation: Rubber boot must be greased near bearing seat (from vehicle interior). Klueber Polyub GLY 801 grease	*BR00.45-Z-1046-06A
18.1	Adjust locking arm of mechanical steering column adjustment	When replacing jacket tube (12) on vehicles without memory package	AR46.15-P-0220T
19	Install in the reverse order		

Nm Steering shaft

Number	Designation		Model 211 except 211.08/09/28/29	Model 211.08/09/28/29	
BA46.10-P-1001-01E	Bolt, steering coupling to steering shaft	Stage 1	Nm	30	20
		Stage 2	Nm	-	60

Nm Jacket tube

Number	Designation	Model 211
BA46.10-P-1001-03K	Lower bolt, jacket tube to cross member below instrument panel	Nm 20

BA46.10-P-1002-03K	Upper bolt, jacket tube to cross member below instrument panel	Nm	20
--------------------	--	----	----

Repair materials

Number	Designation	Order number
BR00.45-Z-1046-06A	Klueber Poly lub GLY 801 grease	A 001 989 84 51