

MODEL 211.0 /2 /6 up to 31.5.06

Front bumper

- 1 Protective strip
- 2 Front bumper
- 3 Electrical connectors (with code (220) Parktronic system (PTS))

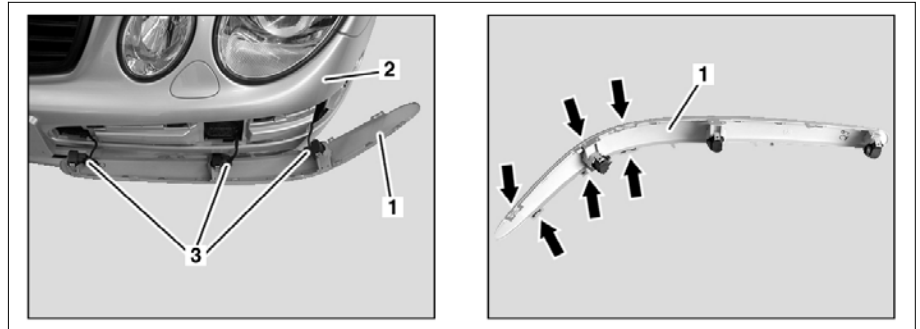

P88.80-2037-04

☒ ☒	Remove/install		
1	Protect paint on front bumper (2) with strips of adhesive tape in area of protective strip (1).	<p>i To avoid damaging paint.</p>	
2	Unclip protective strip (1) at catch hooks (arrows) from front bumper (2) with long wedge	<p>i Unclip toward center of bumper starting at outside.</p> <p>S</p>	*115589035900
3.1	Disconnect electrical connectors (3) from Parktronic system sensors (PTS) and remove protective strip (1)	<p>On vehicles with code (220) Parktronic system (PTS)</p> <p>i When replacing protective strip (1) do not disconnect electrical connectors (3).</p>	
4.1	Remove Parktronic system sensors (PTS)	<p>On vehicles with code (220) Parktronic system (PTS)</p> <p>i When replacing center protective strip (1), unclip Parktronic system sensors (PTS) together with bracket from protective strip (1).</p>	AR54.65-P-0001T
5	Install in the reverse order		

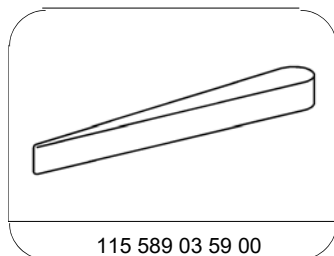

115 589 03 59 00

Long wedge