

- ▶ Loosen tabs ④ of spare wheel well cover ⑥.
- ▶ Reach into recess ⑤ of spare wheel well cover ⑥ to pull it up and remove it.

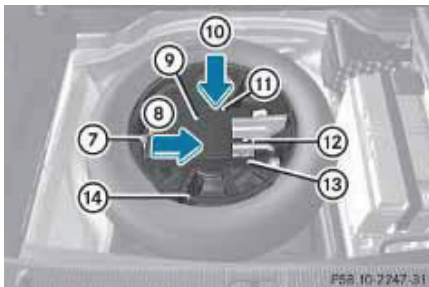

- ⑦ Tab
- ⑧ Removing vehicle tool kit box
- ⑨ Vehicle tool kit box cover
- ⑩ Opening vehicle tool kit box cover
- ⑪ Tab
- ⑫ Vehicle tool kit
- ⑬ Vehicle tool kit box
- ⑭ Luggage bowl

- ▶ **Removing vehicle tool kit box:** Pull tab ⑦ in direction of arrow ⑧ and lift vehicle tool kit box ⑬.
- ▶ Remove vehicle tool kit box ⑬ from luggage bowl ⑭.
- ▶ **Opening vehicle tool kit box cover:** Pull tab ⑪ in direction of arrow ⑩ and open vehicle tool kit box cover ⑨.

- ▶ **Closing vehicle tool kit box cover:** Push vehicle tool kit box cover ⑨ downward until it engages into vehicle tool kit box ⑬.
- ▶ **Installing vehicle tool kit box:** Slide vehicle tool kit box ⑬ into the recess of luggage bowl ⑭.
- ▶ Push vehicle tool kit box ⑬ downward until it engages into luggage bowl ⑭.

Collapsible wheel chock

The collapsible wheel chock serves to secure the vehicle, e.g. while changing a wheel.

- ▶ Take the collapsible wheel chock from the vehicle tool kit (> page 250).

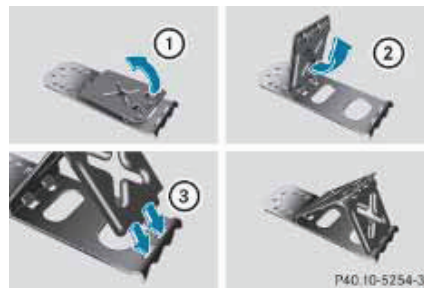

- ▶ **Setting up:** Tilt both plates upward ①.
- ▶ Fold the lower plate outward ②.
- ▶ Guide the tabs of the lower plate all the way into the openings of base plate ③.

For information on where to place wheel chocks when changing a wheel, see “Lifting the vehicle” (> page 303).

Jack

⚠ Warning!

Only use the jack supplied with your vehicle to lift the vehicle briefly for wheel changes. If you use the jack for any other purpose, you or others could be injured, as the jack is designed only for the purpose of changing a wheel.