

MODEL 172.4, 218
 MODEL 204.9
 as of model year 2013
 MODEL 212
 with CODE 279 (Electronic gear selector)

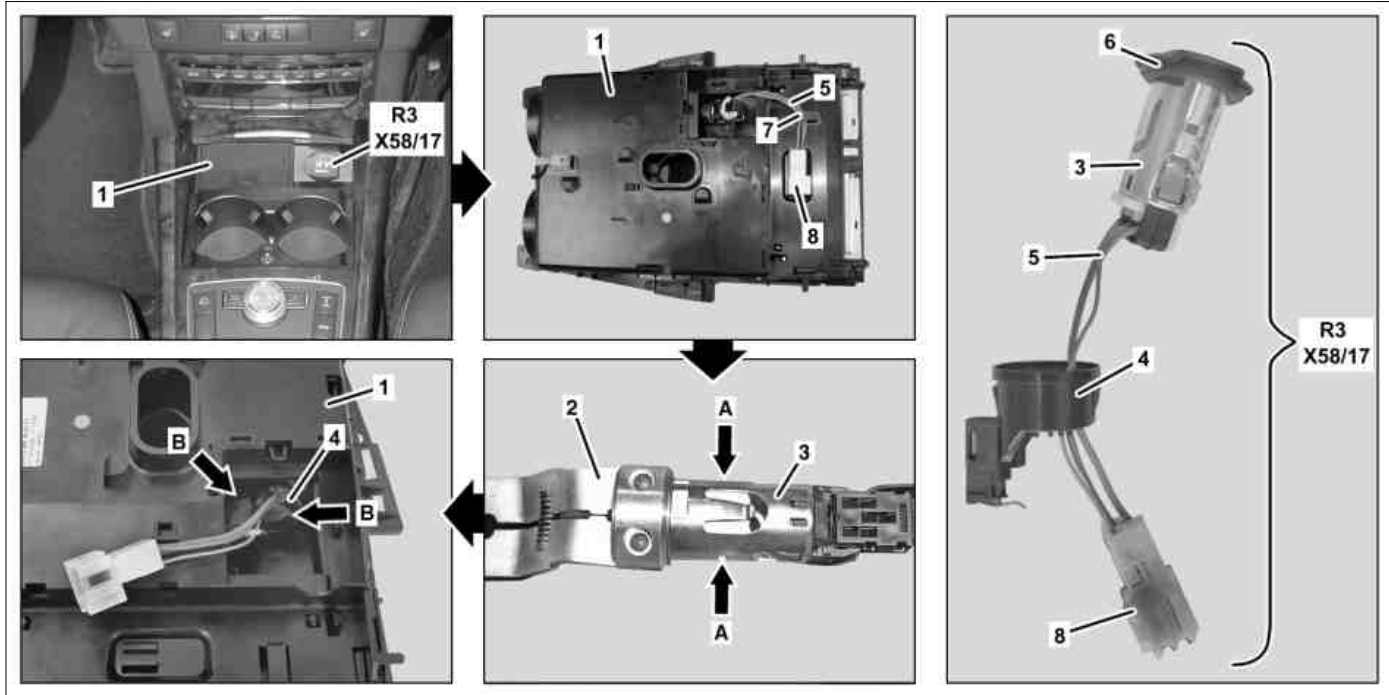

P54.10-3120-09

Shown on model 212

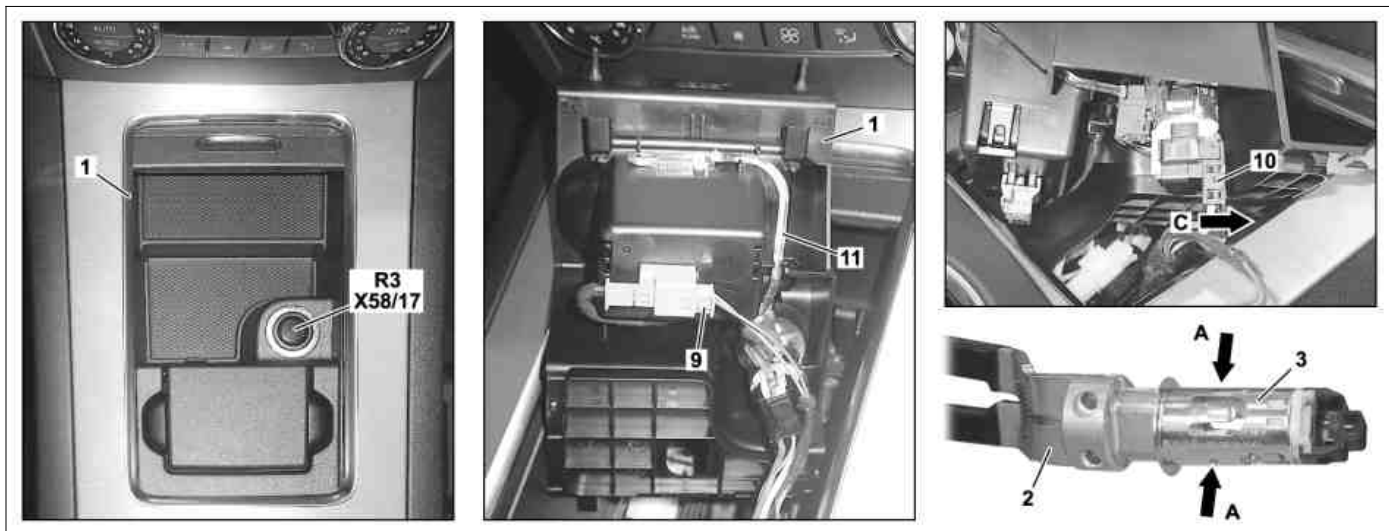

- | | | | | | |
|---|--|---|---|--------|--|
| 1 | Stowage compartment or ashtray housing | 5 | Wiring harness | R3 | Cigarette lighter with front ashtray illumination (with code (301) Ashtray package/smoker package) |
| 2 | Pliers | 6 | Cover (without code (301) ashtray package/smoker package) | X58/17 | Front vehicle interior socket (without code (301) Ashtray package/smoker package) |
| 3 | Housing | 7 | Tab | | |
| 4 | Roll pin | 8 | Connector | | |



P54.10-3777-08

Shown on model 204.9 as of model year 2013

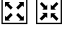
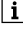
- | | | | |
|---|--|--------|--|
| 1 | Stowage compartment or ashtray housing | 10 | Electrical connector |
| 2 | Pliers | 11 | Fiber optic cable |
| 3 | Housing | R3 | Cigarette lighter with front ashtray illumination (with code (301) Ashtray package/smoker package) |
| 9 | Electrical connector | X58/17 | Front vehicle interior socket (without code (301) Ashtray package/smoker package) |

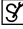
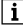
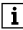
	Remove/install		
1	Remove cover for center console	MODEL 172.4	AR68.20-P-2000W
2	Remove stowage compartment or ashtray housing (1)	MODEL 204.9 as of model year 2013 MODEL 172.4, 218 MODEL 212 with CODE 279 (Electronic gear selector) MODEL 212.0 (except 212.074/077), 212.1, 212.2 (except 212.274/277) with CODE 279 (Electronic gear selector) MODEL 218	AR68.20-P-2420EW AR68.20-P-2420EL
3	Disconnect electrical connector (9)	MODEL 204.9	
4	Detach electrical connection (10) in direction of arrow (arrow C)	MODEL 204.9	
5	Loosen connector (8) on stowage compartment or ashtray housing (1) and unhook wiring harness (5) from the clip (7)	MODEL 172.4, 212, 218	
6	Open cover on stowage compartment or ashtray housing (1)	MODEL 172.4, 212, 218	
7	Pull heating element for cigarette lighter out of housing (3) of the cigarette lighter with front ashtray illumination (R3)	With CODE 301 (Ashtray package/smoker package)	
8	Open covering (6), plug pliers (2) into housing (3) and pull housing (3) approx. 5 cm out of spring pin (4)	 The cover (6) is only fitted on vehicles without code (301) Ashtray package/smoker package. For vehicles without code (301) Ashtray package/smoker package the cigarette lighter with front ashtray illumination (R3) is replaced by the front vehicle interior socket (X58/17). The pins of the  pliers (2) must engage in the housing cutouts (3) (arrows A).  Pliers	*169589003700
9	Unclip optical fiber (11) from stowage compartment or ashtray housing (1)	MODEL 204.9	
10	Unclip spring pin (4) by pressing back the catch hooks (arrow B) out of the stowage compartment or ashtray housing (1) and remove cigarette lighter with front ashtray illumination (R3) or socket of front vehicle interior (X58/17) together with the housing (3) and spring pin (4)	 For vehicles without code (301) Ashtray package/smoker package the cigarette lighter with front ashtray illumination (R3) is replaced by the front vehicle interior socket (X58/17). The cigarette lighter with front ashtray illumination (R3) or the front vehicle interior socket (X58/17) cannot be disassembled any further.  Installation: Check for correct installation position of spring pin (4).	
11	Install in the reverse order		

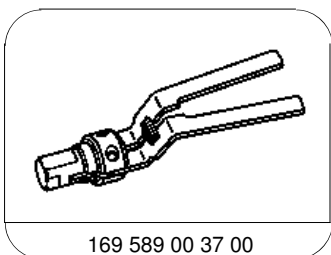

169 589 00 37 00

Pliers