

- Parts list -

Print



Please select the required components for printing:

| | | | |
|-------------------------|-------------------------|------------------|---------------------|
| Vehicle | WDD2120342B083260 (D04) | E 200 | |
| Color | 755 - undefined | Equipment | 111 - |
| Assortment class | PC | Group | 88 ATTACHMENT PARTS |
| Sub-group | 135 RADIATOR GRILL | | |

- Vehicle print only
- Shopping cart
- Total basket
- Equipment only
- Data card
- With designation
- With designation

Cancel Confirm

Print

Please select the required components for printing.

Picture chart







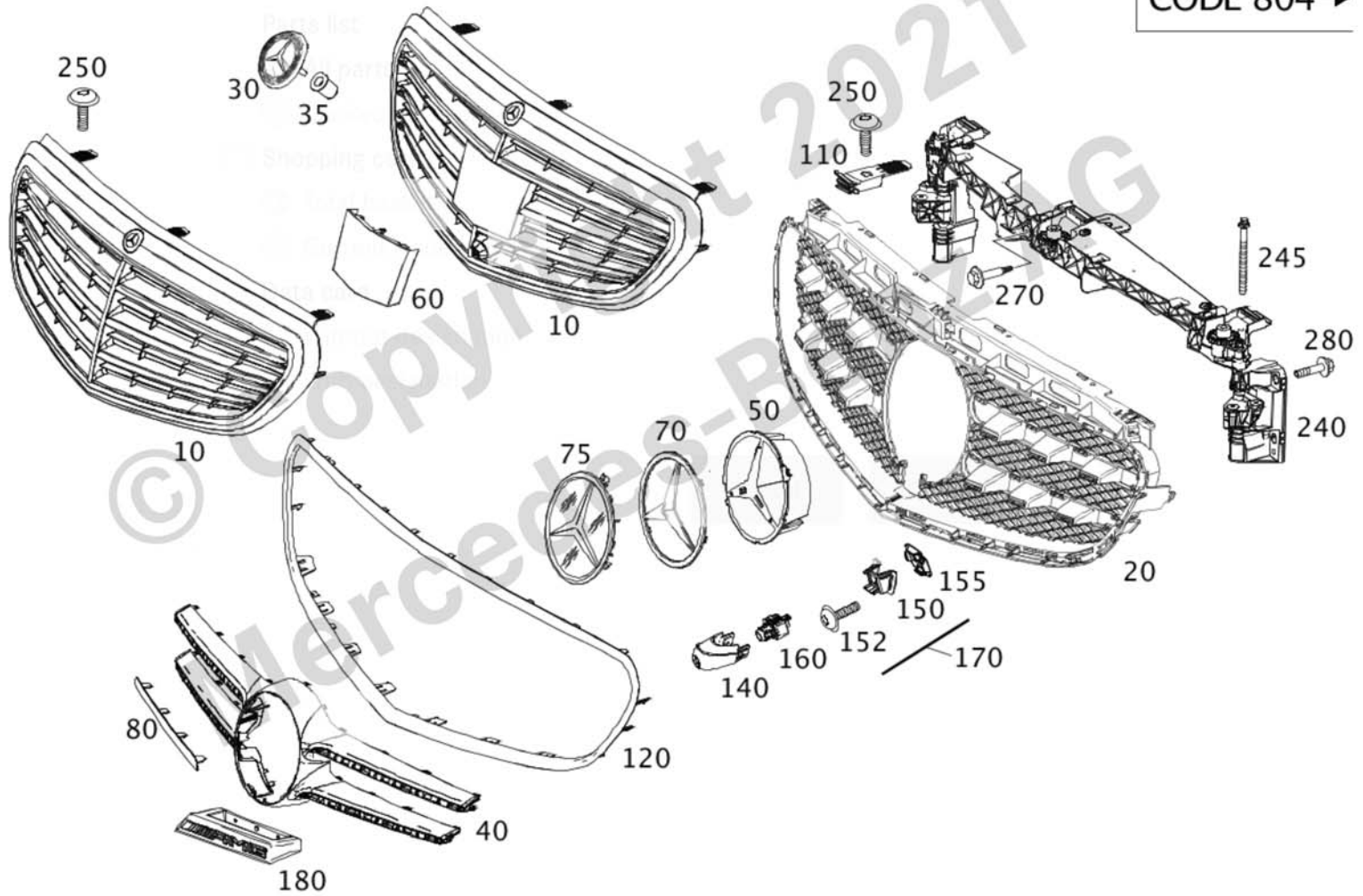

Parts list

Part name

Shipping

CODE 804 →



| Item | Part number | Designation/additional information | Qty |
|------|--|--|-----|
| 20 | A 212 885 15 00  | COVER, BUMPER AREA  Code: (954/(953/955)+P96)+4U4+501+(804/805)/772+501+(804/805/806/807); | 1 |
| 40 | A 212 885 14 22 | COVER, BUMPER AREA  Code: (954+-(P55+P96)/((953/955)+P96+-P55))+4U4+501+-(772/773/800/801/802/803); | 1 |
| 50 | A 218 888 00 60 | CARRIER MERCEDES STAR  Code: (954/(953/955)+P96)+4U4+-(233/M157/800/801/802/803);  Fault location 8830R | 1 |
| 70 | A 000 817 10 16 | MERCEDES STAR  Code: (954/(953/955)+P96)+4U4+-(233/M157/800/801/802/803);  Fault location 88302 | 1 |
| 80 | A 212 885 23 21 | TRIM STRIP TOP LEFT  Code: (954/(953/955)+P96)+4U4+-(M157+M55/800/801/802/803); | 1 |
| 80 | A 212 885 24 21 | TRIM STRIP TOP RIGHT  Code: (954/(953/955)+P96)+4U4+-(M157+M55/800/801/802/803); | 1 |
| 80 | A 212 885 25 21 | TRIM STRIP BOTTOM LEFT  Code: (954/(953/955)+P96)+4U4+-(M157+M55/800/801/802/803); | 1 |

Parts Information

Print



| Item | Part number | Designation/additional information | Qty |
|------|-----------------|--|-----|
| 80 | A 212 885 26 21 | TRIM STRIP BOTTOM RIGHT Code: (954/(953/955)+P96)+4U4+-(M157+M55/800/801/802/803); | 1 |
| 110 | A 212 885 54 14 | BRACKET COVER TO CARRIER, LEFT Code: (954/(953/955)+P96)+4U4+-(800/801/802/803); | 1 |
| 110 | A 212 885 55 14 | BRACKET COVER TO CARRIER, RIGHT Code: (954/(953/955)+P96)+4U4+-(800/801/802/803); | 1 |
| 110 | A 212 885 56 14 | BRACKET COVER TO CARRIER, CENTER Code: (954/(953/955)+P96)+4U4+-(800/801/802/803); | 1 |
| 120 | A 212 885 25 74 | TRIM RADIATOR GRILL Code: (954/(953/955)+P96)+4U4+-(M157/800/801/802/803); | 1 |
| 140 | A 212 888 01 73 | TRIM CAMERA Code: (954/(953/955)+P96)+4U4+501+(804/805)+-(M157+M55); | 1 |
| 150 | A 212 888 00 14 | BRACKET CAMERA Code: (954/(953/955)+P96)+4U4+501+(804/805)+-M157; | 1 |

Parts Information

Print



| Item | Part number | Designation/additional information | Qty |
|------|---------------------|---|-----|
| 160 | A 000 905 39 02 | CAMERA 360 DEGREE VIEWING SYSTEM Code: 501+(954/(953/955)+P96)+4U4+(804/805); Fault location 8207R | 1 |
| 170 | A 212 440 33 40 | ELECTRICAL WIRING HARNESS FRONT CAMERA Code: 501+(954/(953/955)+P96)+4U4+(804/805); | 1 |
| 240 | A 212 880 14 03 | CARRIER RADIATOR GRILL Code: -(800/801/802/803); | 1 |
| 245 | A 212 990 00 03 | * SCREW WITH FEATURE Code: -(800/801/802/803); | 2 |
| 250 | N 000000 007095 | PAN HEAD SCREW RADIATOR GRILLE SHELL TO CROSS CONNECTION; 7X30 Code: (953/954/955)+-(800/801/802/803); | 3 |
| 270 | A 000 990 55 23 | SCREW, SPECIAL SHAPE FRONT SUPPORT; M6X33 Code: -(800/801/802/803); | 1 |
| 280 | N 000000 007018 | SCREW-AND-WASHER ASSEMBLY CARRIER FASTENING; M6X30 Code: -(800/801/802/803); Replaced by: N 000000 000281 +1 N 000000 003260 WASHER | 5 |

Parts Information

Print



| Item | Part number | Designation/additional information | Qty |
|------|-----------------|--|-----|
| 280 | N 000000 000281 | HEXALOBULAR BOLT CARRIER FASTENING; M6X30 Replaces: N 000000 007018 +1 N 000000 003260 WASHER | 5 |

- All parts
- Mailed parts only
- Shopping cart
- Total basket
- Current basket only
- Data card
- With description
- With designation

Cancel

Confirm