

MODEL 207, 212, 218

Shown on model 218

- 1 Fender liner
- 2 Nuts
- 3 Expansion clips
- 4 Bolts

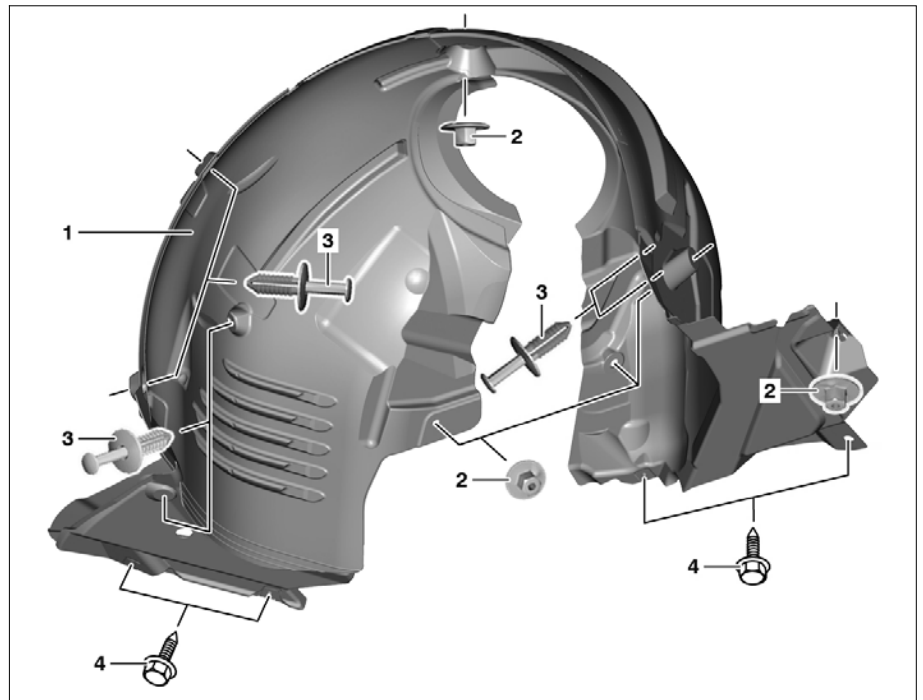

P88.10-2267-06

☒ ☒	Remove/install		
⚠ Danger!	Risk of death caused by vehicle slipping or toppling off of the lifting platform.	Align vehicle between vehicle lift columns and position the four support plates at the vehicle lift support points specified by vehicle manufacturer.	AS00.00-Z-0010-01A
1	Raise vehicle with vehicle lift		
2	Remove expansion clips (3)		
3	Remove screws/bolts (4)		
4	Unscrew nuts (2)		
5	Pull outer edge of fender liner (1) toward inside out of fender edge and remove fender liner (1) downward		
6	Install in the reverse order		