

MODEL 212, 218
without CODE M005 (4MATIC)

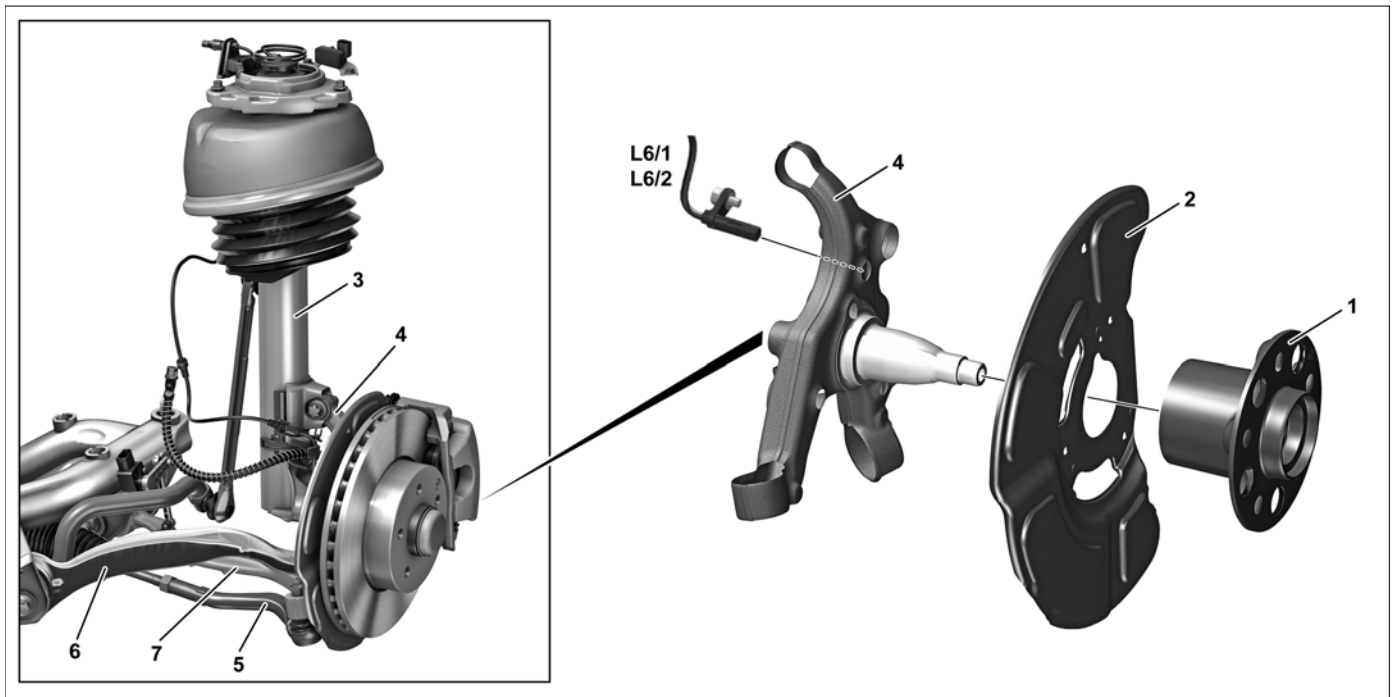

P33.25-2057-09

Shown on vehicle except CODE 460 (Canada version) and except CODE 494 (USA version)

- | | | | | | |
|---|-------------------|---|------------------|------|-----------------------------|
| 1 | Wheel hub | 4 | Steering knuckle | 7 | Cross strut |
| 2 | Brake cover plate | 5 | Tie rod | L6/1 | Left front axle rpm sensor |
| 3 | Suspension strut | 6 | Strut rod | L6/2 | Right front axle rpm sensor |

Shown on vehicle with CODE 460 (Canada version) and with CODE 494 (USA version)

- | | |
|----|------------------|
| 4 | Steering knuckle |
| 5 | Tie rod |
| 8 | Screw |
| 9 | Bracket |
| 10 | Supporting strut |
| 11 | Bracket |

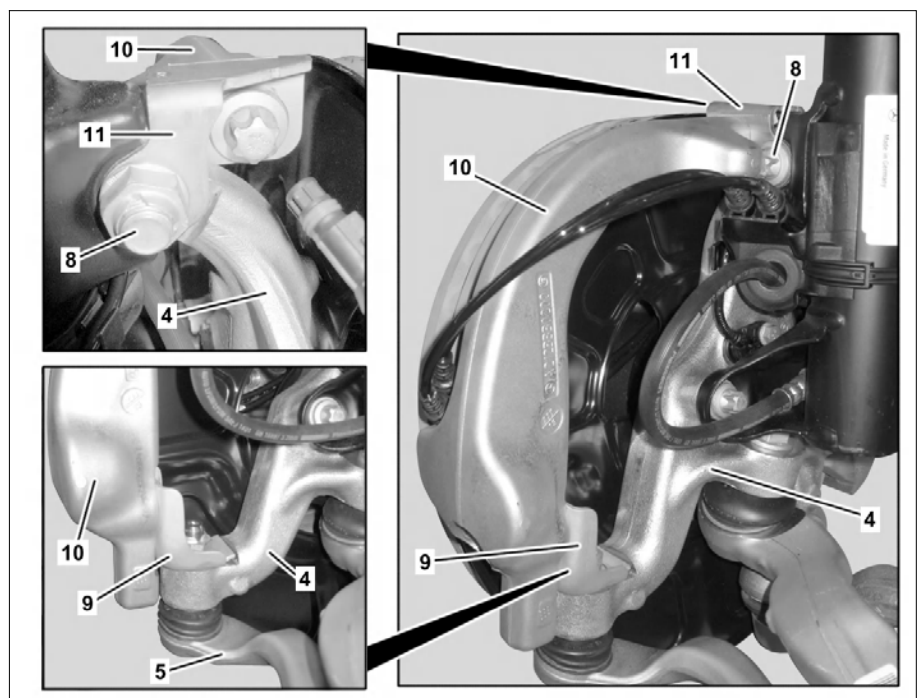

P33.25-2079-06

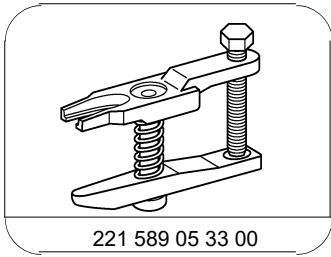

Puller

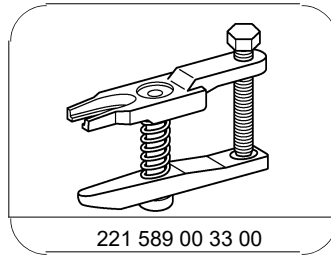

Puller

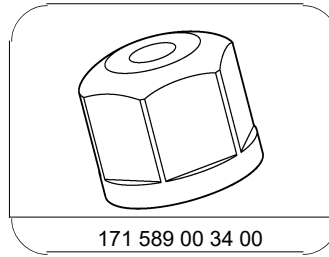

Thrust piece

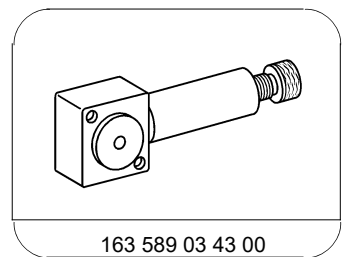

Press