

Model	212 except code M005 (Vehicles with 4MATIC/all-wheel drive)
Model	216 except code M005 (Vehicles with 4MATIC/all-wheel drive)
Model	218 except code M005 (Vehicles with 4MATIC/all-wheel drive)
Model	221 except code M005 (Vehicles with 4MATIC/all-wheel drive) except code Z07 (B7 armoring on special protection version)

## Modification notes

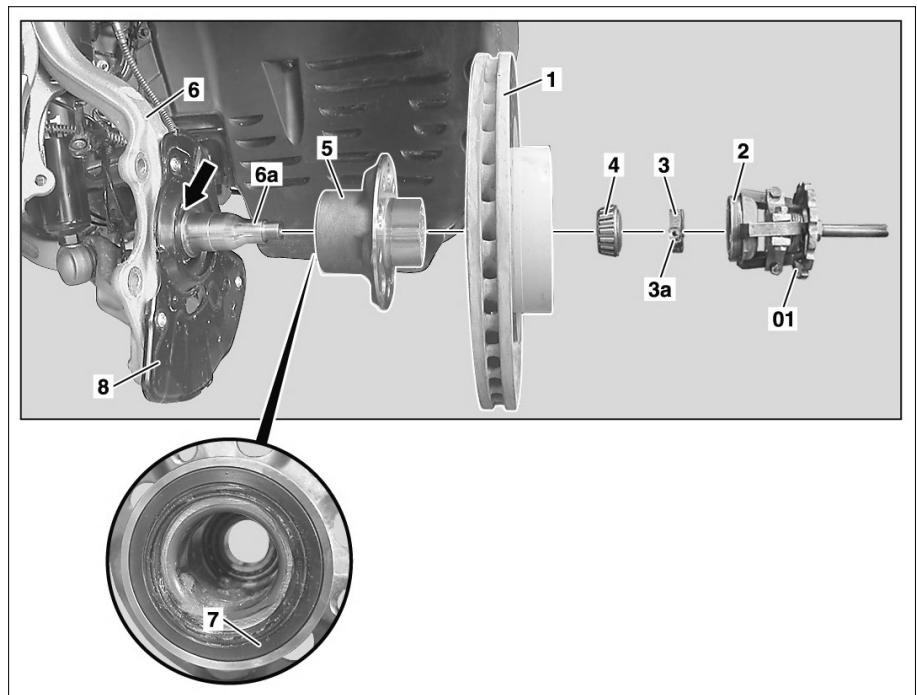



24.04.2014	Schraube Bremsabdeckblech an Achsschenkel oder Radträger	BA42.10-P-1003-06H
------------	--	--------------------

- 01 Removal and installation tool  
 1 Brake disk  
 2 Hub cover  
 3 Clamp nut  
 3a Screw  
 4 Outer tapered roller bearing  
 5 Wheel hub  
 6 Steering knuckle  
 6a Stub axle  
 7 Radial shaft sealing ring  
 8 Brake cover plate

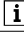

P33.20-2166-06

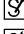
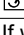
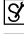
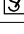
	Notes on safety-relevant components		AH00.00-Z-0019-01A
	<b>Remove/install</b>		
1 	Remove corresponding front wheel	Model 216 except code M005 (Vehicles with 4MATIC/all-wheel drive) Model 221 except code M005 (Vehicles with 4MATIC/all-wheel drive) except code Z07 (B7 armoring on special protection version) Model 212 except code M005 (Vehicles with 4MATIC/all-wheel drive) Model 218 except code M005 (Vehicles with 4MATIC/all-wheel drive)	AP40.10-P-4050SX  AP40.10-P-4050EW
2	Remove brake disk (1)	Model 212.074/075/076/077/274/275/276/277 with code B07 (Ceramic brake system) except code M005 (Vehicles with 4MATIC/all-wheel drive) Model 218.374/375/376/974/975/976 with code B07 (Ceramic brake system) except code M005 (Vehicles with 4MATIC/all-wheel drive)	AR42.10-P-0220QQ

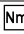
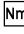
		<p>Model 212 (except 212.074/075/076/077/092/274/275/276/277/292)  except code B07 (Ceramic brake system)  except code M005 (Vehicles with 4MATIC/all-wheel drive)</p> <p>Model 218 (except 218.374/375/376/392/974/975/976/992)  except code B07 (Ceramic brake system)  except code M005 (Vehicles with 4MATIC/all-wheel drive)</p> <p>Model 216  except code M005 (Vehicles with 4MATIC/all-wheel drive)</p> <p>Model 221  except code M005 (Vehicles with 4MATIC/all-wheel drive)  except code Z07 (B7 armoring on special protection version)</p>	<p>AR42.10-P-0220EWE</p> <p>AR42.10-P-0220SX</p>
3	Pull off hub cap (2) with removal and installation tool (01)	 Removal and installation tool	*116589223300
4	Unfasten bolt (3a) and unscrew clamp nut (3)	Adjust wheel bearing play  <b>Installation:</b> Adjust wheel bearing play.	AR33.20-P-0300SX
5	Remove outer tapered roller bearing (4)		
6	Remove wheel hub (5) from kingpin (6a)	<p>If the wheel hub (5) is difficult to remove</p> <p style="text-align: center;">↓</p> <p>Detach wheel hub (5).</p> <p> Impact extractor</p> <p> Puller</p> <p> Collet chuck</p>	<p>AR33.20-P-0310-01TX</p> <p>*201589103300</p> <p>*001589503300</p> <p>*201589013400</p>
7	Replace radial shaft sealing ring (7)	<p>If wheel hub (5) is re-used.</p> <p> Puller</p> <p> Installation tool</p>	<p>AR33.20-P-0310-03SX</p> <p>*001589023300</p> <p>*203589024300</p>
	<b>Check</b>		
8	Check brake cover plate (8) for damage	<p> Model 216  except code M005 (Vehicles with 4MATIC/all-wheel drive)</p> <p>Model 221  except code M005 (Vehicles with 4MATIC/all-wheel drive)  except code Z07 (B7 armoring on special protection version) Bolt, brake cover plate to steering knuckle or wheel carrier</p> <p> Model 212  except code M005 (Vehicles with 4MATIC/all-wheel drive)</p> <p>Model 218  except code M005 (Vehicles with 4MATIC/all-wheel drive) Bolt, brake cover plate to steering knuckle or wheel carrier</p> <p>If damage is present</p> <p style="text-align: center;">↓</p> <p>Replace brake cover plate (8).</p>	<p>*BA42.10-P-1003-06G</p> <p>*BA42.10-P-1003-06H</p>
9	Check steering knuckle spindle (6a) for discoloration and wear on bearing seats	<p>If the bearing seats are discolored or worn</p> <p style="text-align: center;">↓</p> <p>Replace steering knuckle (6).</p> <p>Model 216.37  except code M005 (Vehicles with 4MATIC/all-wheel drive)</p> <p>Model 221.003/02/05/07/10/12/15/17  except code M005 (Vehicles with 4MATIC/all-wheel drive)  except code Z07 (B7 armoring on special protection version)</p> <p>Model 221.09/19  except code M005 (Vehicles with 4MATIC/all-wheel drive)  except code Z07 (B7 armoring on special protection version)</p> <p>Model 212, 218  except code M005 (Vehicles with 4MATIC/all-wheel drive)</p>	<p>AR33.25-P-0400SX</p> <p>AR33.25-P-0400EW</p>

10	Check bearing surface (arrow) of radial shaft sealing ring (7) on steering knuckle spindle (6a)	<p>If noticeable scoring or galling is present</p> <p style="text-align: center;">↓</p> <p>Replace steering knuckle (6).  Model 216.37  except code M005 (Vehicles with 4MATIC/all-wheel drive)  Model 221.003/02/05/07/10/12/15/17  except code M005 (Vehicles with 4MATIC/all-wheel drive)  except code Z07 (B7 armoring on special protection version)  Model 221.09/19  except code M005 (Vehicles with 4MATIC/all-wheel drive)  except code Z07 (B7 armoring on special protection version)  Model 212, 218  except code M005 (Vehicles with 4MATIC/all-wheel drive)</p>	<p>AR33.25-P-0400SX</p> <p>AR33.25-P-0400EW</p>
11	Check threaded holes of wheel bolts in wheel hub (5)	<p>If damage is present</p> <p style="text-align: center;">↓</p> <p>Replace wheel hub (5).</p>	
12	Check inner tapered roller bearing, outer tapered roller bearing (4) and bearing races	<p>Model 212  except code M005 (Vehicles with 4MATIC/all-wheel drive)  Model 216  except code M005 (Vehicles with 4MATIC/all-wheel drive)  Model 218  except code M005 (Vehicles with 4MATIC/all-wheel drive)  Model 221  except code M005 (Vehicles with 4MATIC/all-wheel drive)  except code Z07 (B7 armoring on special protection version)  Model 212 (except 212.08/09/28/29)  except code M005 (Vehicles with 4MATIC/all-wheel drive)  Model 216  except code M005 (Vehicles with 4MATIC/all-wheel drive)  Model 218 (except 218.39)  except code M005 (Vehicles with 4MATIC/all-wheel drive)  Model 221  except code M005 (Vehicles with 4MATIC/all-wheel drive)  except code Z07 (B7 armoring on special protection version)  If damage is present</p> <p style="text-align: center;">↓</p> <p>Replace wheel hub (5).</p>	AR33.20-P-0310-02TX
13	Install in the reverse order		

**Nm** Brake disks, brake cover plate

Number	Designation			Model 216	Model 221
BA42.10-P-1003-06G	Bolt, brake cover plate to steering knuckle or wheel carrier	M6	Nm	14	14
		M8	Nm	18	18

**Nm** Brake disks, brake cover plate

Number	Designation			Model 212	Model 218
BA42.10-P-1003-06H	Bolt, brake cover plate to steering knuckle or wheel carrier	M6	Nm	12	12
		M8	Nm	18	18

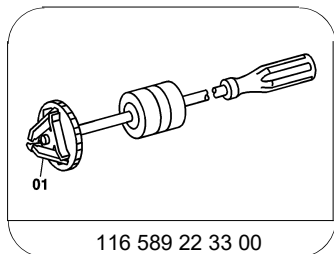

116 589 22 33 00

Removal and installation tool

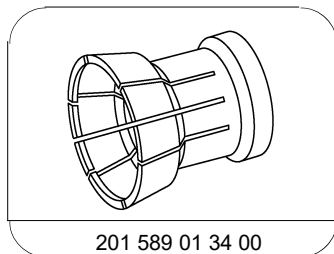

201 589 01 34 00

Collet chuck

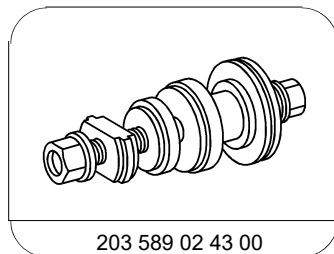

203 589 02 43 00

Installation tool

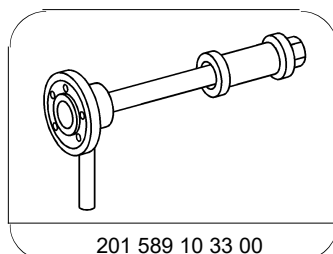

201 589 10 33 00

Impact extractor

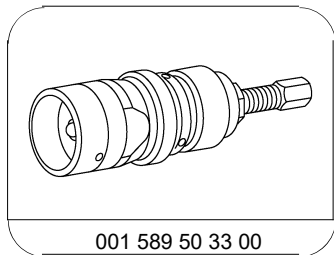

001 589 50 33 00

Puller

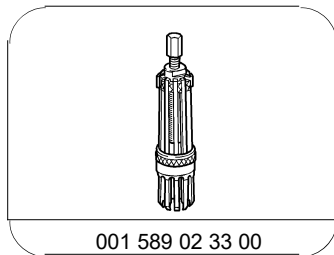

001 589 02 33 00

Puller