

220 589 01 43 00

Press out/in tool

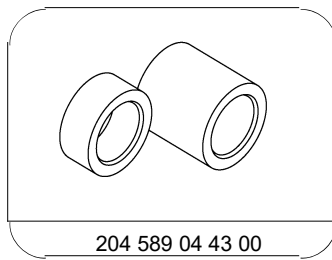

204 589 04 43 00

Extraction and insertion tool

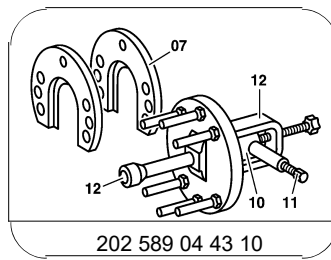

202 589 04 43 10

Press

Removing

i The stroke of the press (010) is very low, because of this the press (010) must be released several times, the spindle (a) of the bracket (01) must be adjusted and the press (010) operated again.

- Install sleeve (001) on bracket (01).
- Attach bracket (01) to rear axle carrier (4) and rubber mount (6l) using sleeve (001), thrust piece (04) and press (010).
- Press rubber mount (6l) out of rear axle carrier (4).

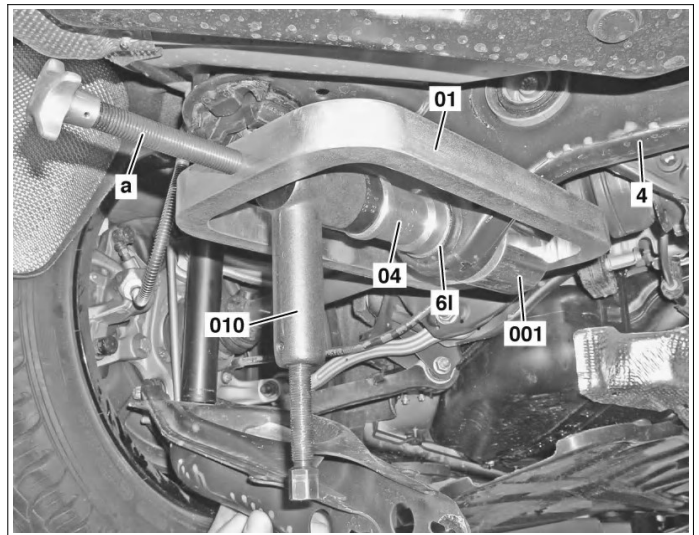

P35.20-2228-11

- 001 Sleeve (204 589 04 43 01)
- 01 Bracket (220 589 01 43 01)
- 04 Thrust piece (220 589 01 43 04)
- 010 Press (202 589 04 43 10)

- 4 Rear axle carrier
- 6l Rubber bushing
- a Spindle

Install

- Install sleeve (02) on bracket (01).
- Attach bracket (01) to rear axle carrier (4) and rubber mount (6l) using sleeve (02), thrust piece (07) and press (010).
- Press rubber mount (6l) into rear axle carrier (4).

- 01 Bracket (220 589 01 43 01)
- 02 Sleeve (204 589 04 43 02)
- 07 Thrust piece (220 589 01 43 07)
- 010 Press (202 589 04 43 10)
- 4 Rear axle carrier
- 6l Rubber bushing
- a Spindle

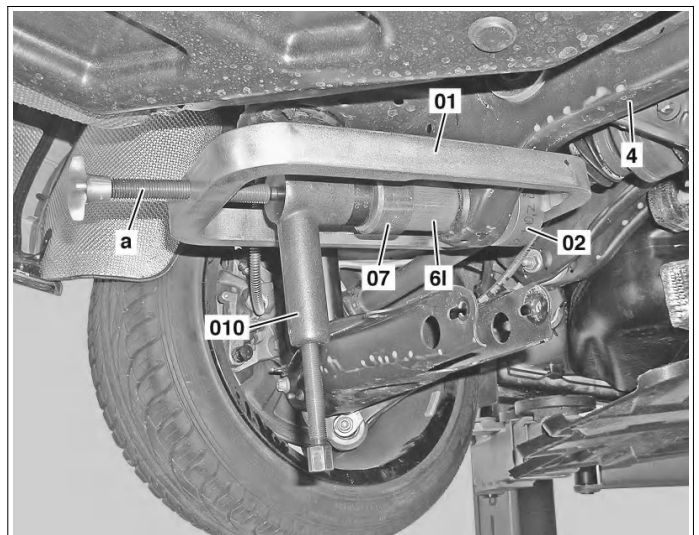

P35.20-2227-11