

Model 212, 218

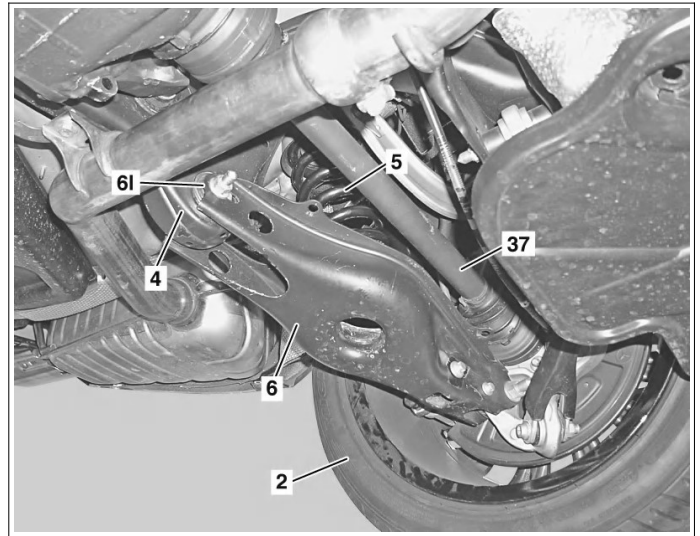

Shown except CODE 489 (AIRmatic) and except CODE 488 (Steel/air suspension)

- 2 Rear wheel
 4 Rear axle carrier
 5 Steel spring (except CODE 489 (AIRmatic))
 6 Spring control arm
 6l Elastomer bearing
 37 Rear axle shaft

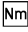
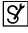

P35.20-2226-11

Danger	Risk of death caused by vehicle slipping or toppling off of the lifting platform.	Align vehicle between vehicle lift columns and position the four support plates at the vehicle lift support points specified by the vehicle manufacturer.	AS00.00-Z-0010-01A
Notice	Notes on AIRmatic		AH32.22-P-1000-02EW
Notice	Notes on self-locking nuts and bolts		AH00.00-P-0001-01KOA
	Notes on repair work on suspension components		AH00.00-P-0100-01A
Remove/install			
1	Operate parking brake		
2	Empty air spring using diagnostic system	Model 212.0/1, 218 with code 488 (Steel/air suspension) Model 212.0/1, 218 with code 489 (AIRMATIC Dual Control/semi-active air suspension) Model 212.2	AD00.00-P-2000-04A
AD		Installation: The air spring must be filled as per the specifications. The air spring may otherwise be damaged and fail later.	
3.1	Switch off ignition and remove transmitter key from electronic ignition lock control unit	Model 212, 218 except code 889 (KEYLESS-GO)	
3.2	Switch off ignition and remove transmitter key or KEYLESS-GO start/stop button from electronic ignition lock control unit	Model 212, 218 with code 889 (KEYLESS-GO)	
4	Secure vehicle on vehicle lift		AR00.60-P-0100EWS
5	Remove left or right rear wheel (2)		AP40.10-P-4050EW
AP			
6	Remove left and right rear diagonal strut	Model 212.2, 218.9 Bolt, rear diagonal strut bracket mount to body	*BA61.10-P-1006-01H
7	Remove exhaust system as from connecting point	Model 212, 218 Model 212 with engine 274 Model 212, 218 with engine 157, 276, 278 Model 212 with engine 156, 272, 273 Model 212, 218 with engine 642, 651	AR49.10-P-7100MR AR49.10-P-7100EL AR49.10-P-7100EW AR49.10-P-7100EWI
8.1	Remove left or right steel spring (5)	Model 212.0/1, 218 except code 488 (Steel/air suspension) except code 489 (AIRMATIC Dual Control/semi-active air suspension)	AR32.20-P-0230EW

8.2	Unclip left or right air spring from spring control arm (6)	Model 212.0/1, 218 with code 488 (Steel/air suspension) Model 212.0/1, 218 with code 489 (AIRMATIC Dual Control/semi-active air suspension) Model 212.2	AR32.22-P-1500EW
9	Unscrew nut for spring control arm (6) on rear axle carrier, lift up spring control arm (6) until the rear axle shaft (37) is almost horizontally positioned, and pull out the bolt	 Self-locking screw/nut, spring link to rear axle carrier	*BA35.20-P-1001-01D
10	Fold spring control arm (6) downwards		
11	Remove elastomer bearing (6l)	 Removal and installation tool  Extraction and insertion tool  Press	AR35.20-P-0114-01CW *220589014300 *204589044300 *202589044310
12	Install in the reverse order		

 Spring link

Number	Designation		Model 212	Model 218	
BA35.20-P-1001-01D	Self-locking screw/nut, spring link to rear axle carrier	Stage 1	Nm	50	50
		Stage 2	°	90	90

 Frame floor assembly

Number	Designation		Model 212	Model 218
BA61.10-P-1006-01H	Bolt, rear diagonal strut bracket mount to body	Nm	60	60

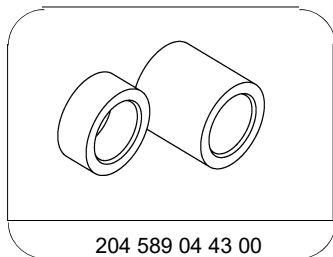

Extraction and insertion tool

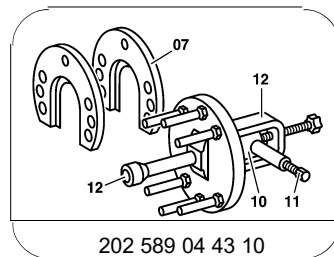

Press

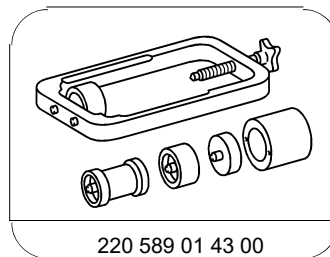

Removal and installation tool