

**Document title** Remove/install thrust arm bushing at the wheel carrier

**Document number** ar3520p0105ew

## MODEL 212, 218

- 1 Rear axle carrier  
 5 Thrust arm  
 5l Rubber bushing  
 7 Wheel carrier

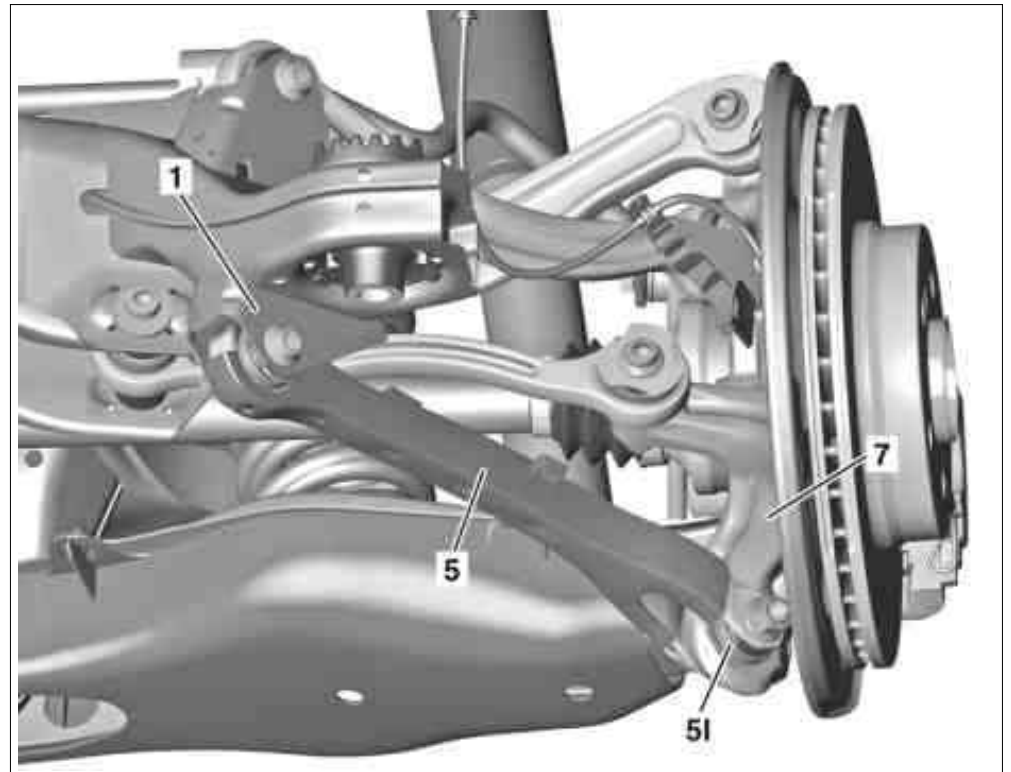

P35.20-2224-11

	<b>Remove/install</b>		
	<b>Risk of death</b> caused by vehicle slipping or toppling off of the lifting platform.	Align vehicle between columns of vehicle lift and position four support plates at vehicle lift support points specified by vehicle manufacturer.	AS00.00-Z-0010-01A
	Notes on self-locking nuts and bolts		AH00.00-N-0001-01A
		While working on the rear axle care must be taken to ensure that the surface of all aluminum components do not get any scratches, cracks and notches. Otherwise the service life of the parts will be reduced.	
		<b>Installation:</b> Tighten nuts and bolts of chassis components only when vehicle is in the ready-to-drive condition.	
1	Remove rear wheel		AP40.10-P-4050EW
2	Detach thrust arm (5) from wheel carrier (7)		*BA35.20-P-1002-05G
3	Loosen the thrust arm (5) on the rear axle carrier (1) and fold downwards		*BA35.20-P-1001-05G
4	Remove rubber mount (5l)	Extraction and insertion tool	AR35.20-P-0105-01CW *204589034300
5	Install in the reverse order		

## Thrust arm

Number	Designation			Model 212	Model 218	
BA35.20-P-1001-05G	Self-locking nut, thrust arm to rear axle carrier	M12	Stage 1	Nm	50	50
			Stage 2	∠°	90	90
BA35.20-P-1002-05G	Self-locking nut, thrust arm to wheel carrier	M12	Stage 1	Nm	50	50
			Stage 2	∠°	90	90

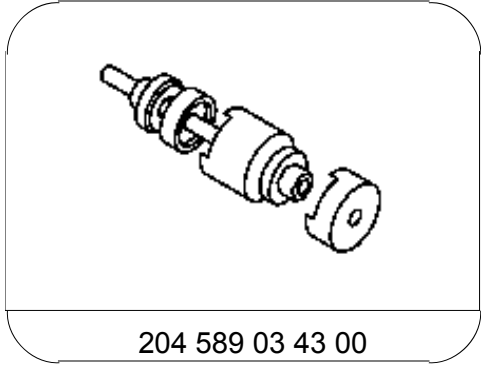

204 589 03 43 00

Extraction and insertion tool