

Model 205 (except 205.4)

Model 213

Model 217.3

Model 222

Model 253

Shown on model 222

1 Headliner

2 Plastic card

3 Lock

N70 Overhead control panel control unit

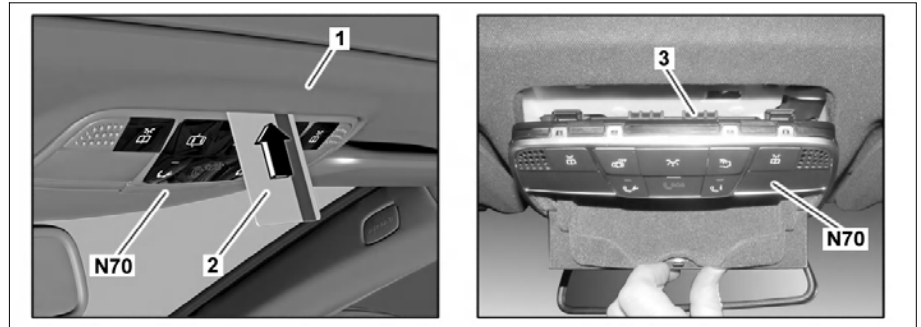

P82.20-4605-04

Shown on model 222

3 Lock

4 Electrical connector

N70 Overhead control panel control unit

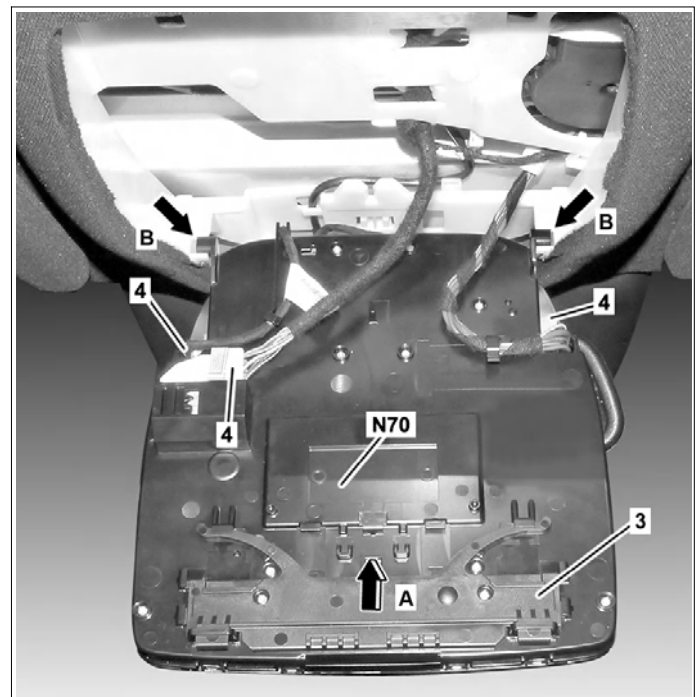

P82.20-4127-12

	Information on preventing damage to electronic components due to electrostatic discharge		AH54.00-P-0001-01A
	Remove/install		
1	Perform initial startup of overhead control panel control unit (N70)	When installing new overhead control panel control unit (N70).	
			AD00.00-P-2000-04B
2	Switch off ignition and store transmitter key outside of transmission range (min. 2 m)		
3	Insert a plastic card (2) or a similar object (approx. 2 mm thick) along a perpendicular line at the center between roof lining (1) and overhead control panel control unit (N70), unlock the lock (3) in direction of travel (arrow A) and fold overhead control panel control unit down (N70)		
4	Release and disconnect all electrical connectors (4) from overhead control panel control unit (N70)	The number can vary according to the equipment.	
5	Unhook overhead control panel control unit (N70) from the brackets (arrows B) and remove		

6	Reconfigure the bracket for taximeter	Model 213 with code 336 (Taximeter console in OCP) When installing new overhead control panel control unit (N70).	
7	Install in the reverse order		