

Model 213  
 Model 238

**Modification notes**



20.03.2017	Removal of door sill added.	Operation step 2	
------------	-----------------------------	------------------	--

**Shown on model 213.0**

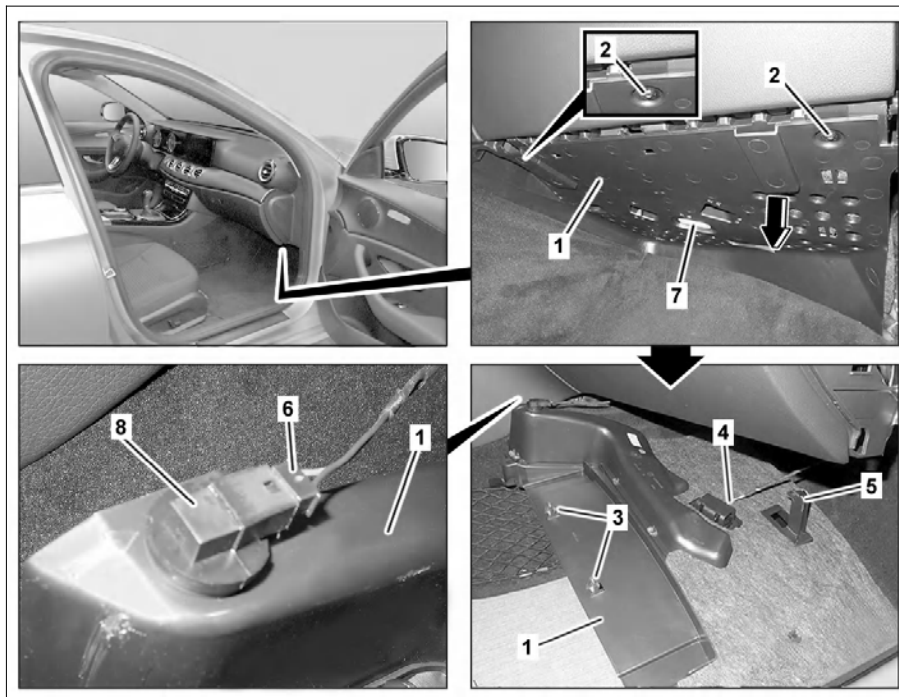
- 1 Cover
- 2 Screw
- 3 Retaining clips
- 4 Electrical connector
- 5 Hook
- 6 Electrical connector
- 7 Footwell lamp
- 8 Temperature sensor



P68.10-5446-06

 	Remove/install		
1	Move passenger seat to end position toward rear		
2	Remove door sill molding	Model 213 Model 238	AR68.30-P-4100LW AR68.30-P-4100CLW
3	Unscrew bolts (2)		
4	Unclip cover (1) from retaining clips (3), push outward using hook (5), unhook, and lower (arrow) until electrical connectors (4, 6) are accessible	 Mounting wedge	*110589035900
5	Disconnect electrical connections (4, 6)		
6	Take off cover (1)		
7	Transfer temperature sensor (8)	When replacing cover (1).	
8	Transfer footwell lamp (7)	When replacing cover (1).	
9	Install in the reverse order		

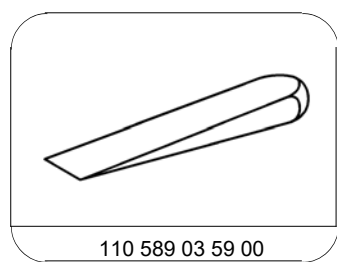

110 589 03 59 00

Mounting wedge