

Model 213

Model 238

Shown on model 213

- 1.1 Fender liner front section
 1.2 Fender liner rear section
 2 Expansion rivet
 3 Nut
 4 Screw

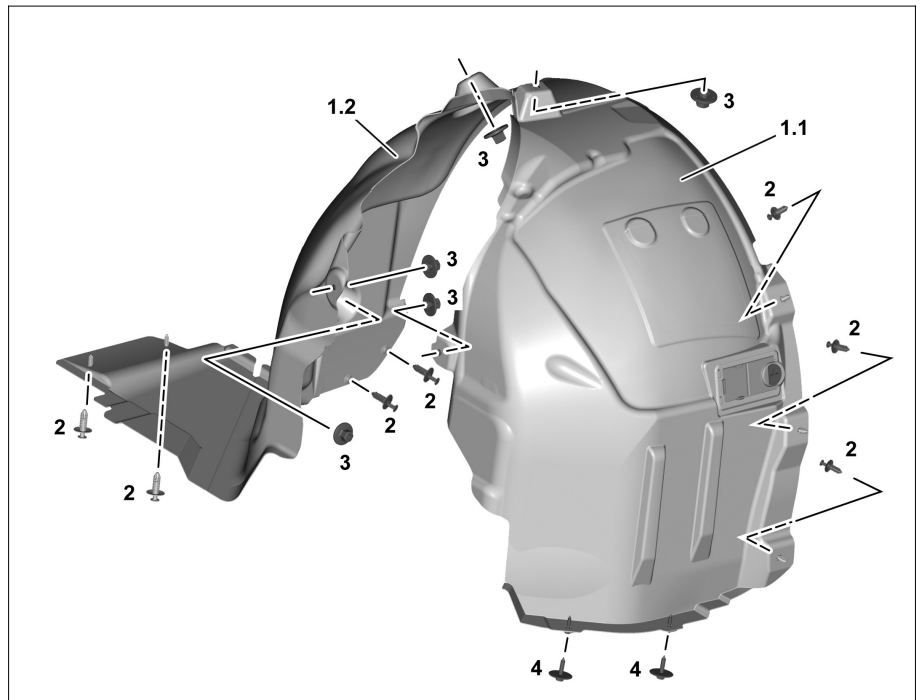

P88.10-2318-06

☒ ☒	Remove/install		
1	Raise vehicle		AR00.60-P-1002LWG
2	Remove bolt s (4)		
3	Remove expansion rivets (2)	i The number of expansion rivets (2) can vary.	
4	Unscrew nuts (3)	i The number of nuts (3) can vary.	
5	Pull outer edges of fender liner front section (1.1) and fender liner rear section (1.2) inwards out of wheel arch lip and remove fender liner front section (1.1) and fender liner rear section (1.2)		
6	Install in the reverse order		