

Model 117, 156, 176, 205, 213, 222, 242, 246, 253, 293

Shown on model 246

- 1 Grab handle
- 2 Covers
- 3 Clips

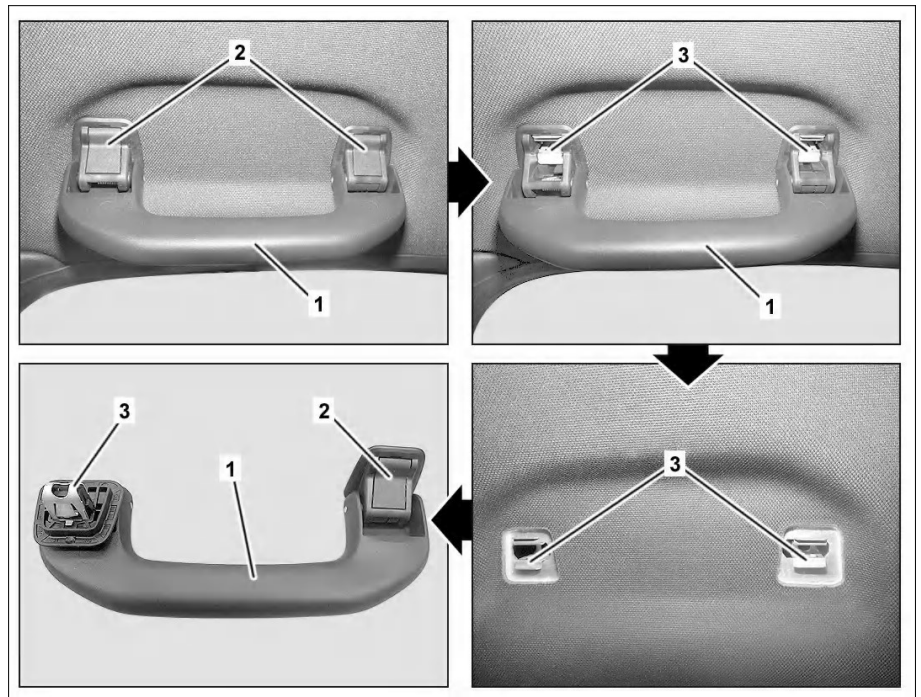

P68.30-3598-06

	Notes on safety-relevant components		AR00.00-Z-0019-01A
	Remove		
1	Remove covers (2).		
2	Press together clips (3) and remove grab handle (1).		
3	Release and disconnect electrical connector of rear illumination at rear grab handle (1).	Model 156 with code 413 (Automatic panoramic sliding sunroof) Model 205, 253, 293 with code 876 (Interior Light package) Model 213, 222	
4	Remove clamps (3) from the body.		
	Install		
5	Clip clamps (3) and covers (2) into the grab handle (1).		
6	Connect electrical connector of rear illumination at rear grab handle (1).	Model 156 with code 413 (Automatic panoramic sliding sunroof) Model 205, 253, 293 with code 876 (Interior Light package) Model 213, 222	
7	Clip grab handle (1) into the roof.		
	Check		
8	Check grab handle at roof.		AR68.30-P-4330-01NKB