

Hello,
I was able to install an illuminated star in my 2012 GL450. I will explain as best as I can how I did it. I took pictures that I will attach. I don't know if this will apply to other years or models.

Remove Old Star

- I was able to remove the old star without removing the grill.
- I removed the chrome emblem with a small flat head screwdriver.
- Then with a small flat head screw driver I push the tabs holding the housing in place one by one and pull the housing out.
- After moving the first tabs it was pretty easy to wiggle the housing out pull it towards me.



Replacement Star

There's an Old and New style of replacement stars that fits this truck.
The New has a black gloss backing (W205)
(<https://a.co/d/gK7zfPR>)

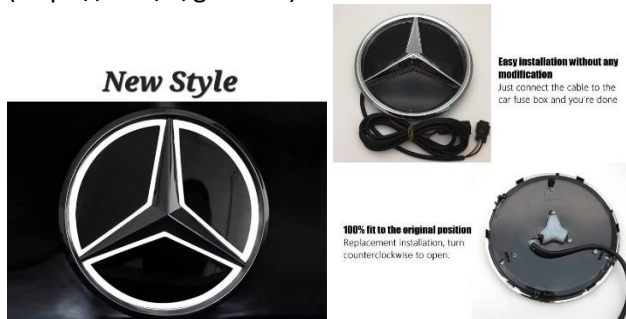

The Old style has the mesh backing the same as the original.
(<https://a.co/d/5C6vSRS>)

Old Style



Modification and Install of New style

- Separate the two pieces of the star
- Place the black backing into the frame of the grill.
- Then twist until it's flushed and locked in the grill.
- It took me a few attempts to get it to line up correctly.



- The emblem snaps into the grill.
- However I found that there was one tab that couldn't snap in place because it was blocked by the frame of the grill.
- I just snapped the tab off and the emblem snapped in the grill.
- It was the bottom tab on my truck



Modification and Install of Old style

The Old style star modification is more labor intensive.

- There are sections of the frame of the star that must be removed to allow for it to fit and lock into the grill using a box cutter or electric heated knife.
- I went with an electric knife and removed about 2 cm for the frame and tab of the star.
- There are 3 tabs on the frame that need to be trimmed.
- The 3 pictures show the same cut with a before/after and from different angles.
- Place the star into the frame of the grill.
- Then twist until it's flushed and locked in the grill.
- It took me a few attempts to get it to line up correctly.

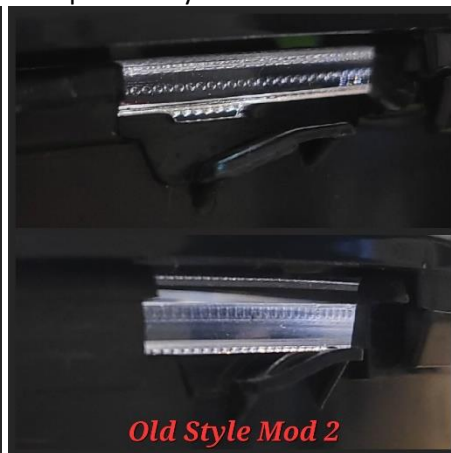

Wiring the Star

Both styles of star are wired the same.

-The fuse extension provided with the star looked cheap. It was also for a mini-fuse.

-Picked one up from the auto part store.

-The star can be linked to the follow locations:

Headlight fuse (lights up at night)

Brake fuse (lights up with brake lights)

Door unlock fuse (lights up when doors unlock) etc.

-The 2 pictures show how the light can be wired with or without the fuse extension

Installation method (with a fuse extension device)

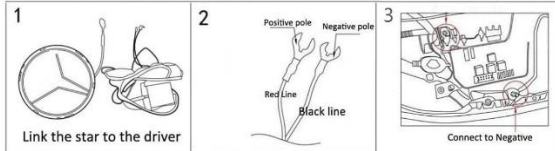

You can also install the LED star badge by replacing the fuse, which can be connected to any control interface according to your needs. For example: car light fuse, unlock fuse, brake light fuse interface, etc.

We will give you a fuse extension device. (pictured)

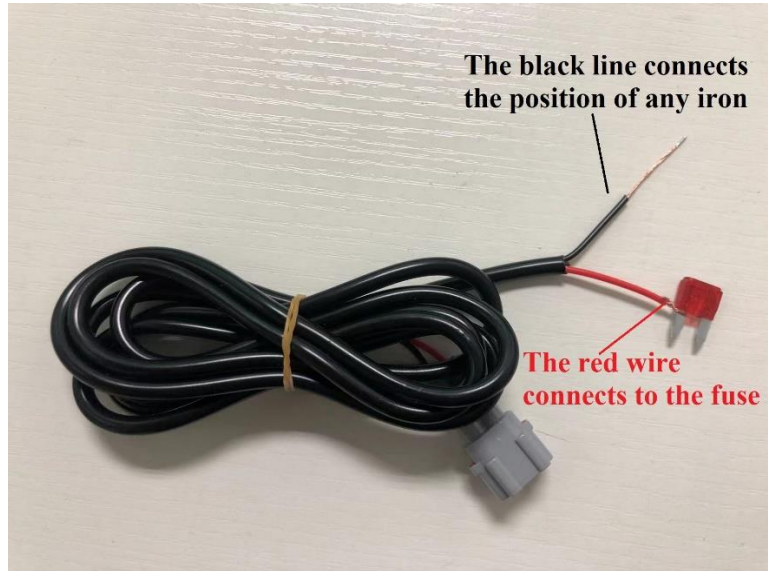
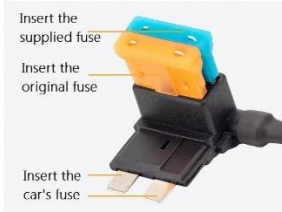

A: Sicherung · Fuse · Fusible 100 -125

im Motorraum rechts, im Gerätekasten
 in the engine compartment, on the right side
 Dans le compartiment moteur, à droite



Function	Fuse
A/C Module	12
Airbag	61
AIRMATIC / Control unit height adjustment	32, 53, 108
Antenna	28
ATA Horn	110
Auto. Transmission	111, 116
Backup camera	37, 60
Blind Spot Assist	60
Blower, Rear passenger compartment, 2nd row	10
BLUETEC	A, B, C, 48, 56
CA Head Restraints	59
Cellphone	23
Child Seat Recognition	61
Cigar lighter	46
Compass Module	15
DAB-Radio	39
Diagnostics Outlet	58
Dead-filter heating	123
DISTRONIC	117
Door CU, Driver	34
Door CU, Passenger	26
Door sill, Burnished	47
Elec. Seat Adjustment, Driver	28, 63
Elec. Seat Adjustment, Passenger	27, 62
Emergency Tensioning Retractor	24, 29
Engine CU	51, 102, 104, 116, 119, 120
ESP	109, 115
Folding 3rd Seat Line	30
Fuel Pump	57
Fuel Pump CU	36, 43, 53
Glove Box Light	60
HD-Radio	39
Headlamp Range Adjustment	54, 112
Heated Seat Rear	68
Horn	113
Ignition Lock	14
Instrument cluster	11, 59
KEYLESS GO	33
Korea navigation system	39, 60
Light Control Switch	55
Media Interface	15
Multi-contour Seat	60, 66
Panorama Sunroof	42
PARKTRONIC	22
Power Outlet 2nd Seat Line	45
Power Outlet Fr. Passenger	44
Power Outlet Trunk	44, 45
Power Steering	124
Radio systems	25
Rear Control Panel	21
Rear Seat Entertainment	23
Rear Window Defroster	49
Remote tailgate closing	40
Residual Engine-Heat Utilization	22, 121
Roof Lint	61
RR Diff. Lock	48, 52, 53, 69
RR Fan	67
RR Wiper	60
Secondary Air Pump	107
Sound Amplifier	25
Starter	122, 105
Steering Column Module	13
Steering Wheel Heater	31
Supply Eng.	101, 103, 104, 105
Switch panel	13
TELEAID / VCS (Japan)	36, 60
Tire Pressure Control	39
Trailer Brake (US)	71
Trailer hitch	70, 72
TV-Tuner / Radio system Japan	38
Wipers, front	60, 100
-	16
-	17
-	18
-	64
-	65
-	106

I decided to go with a New style star in Black on Black star instead of the original Old style in Chrome on Black star.

The seller on amazon offers the New style in both color schemes. Old style is offered in Chrome on Black only.

I hope this is helpful to someone.

Please feel free to ask any questions, I'll do my best to answer them.

Thanks

Tonya

