

Model 166, 292

Modification notes

19.05.2015	Bolt, torsion bar bracket/torsion bar to front axle carrier	Model 166 with code 468 (Active driving stability (roll stability))	BA32.20-P-1001-02Q
------------	---	---	--------------------

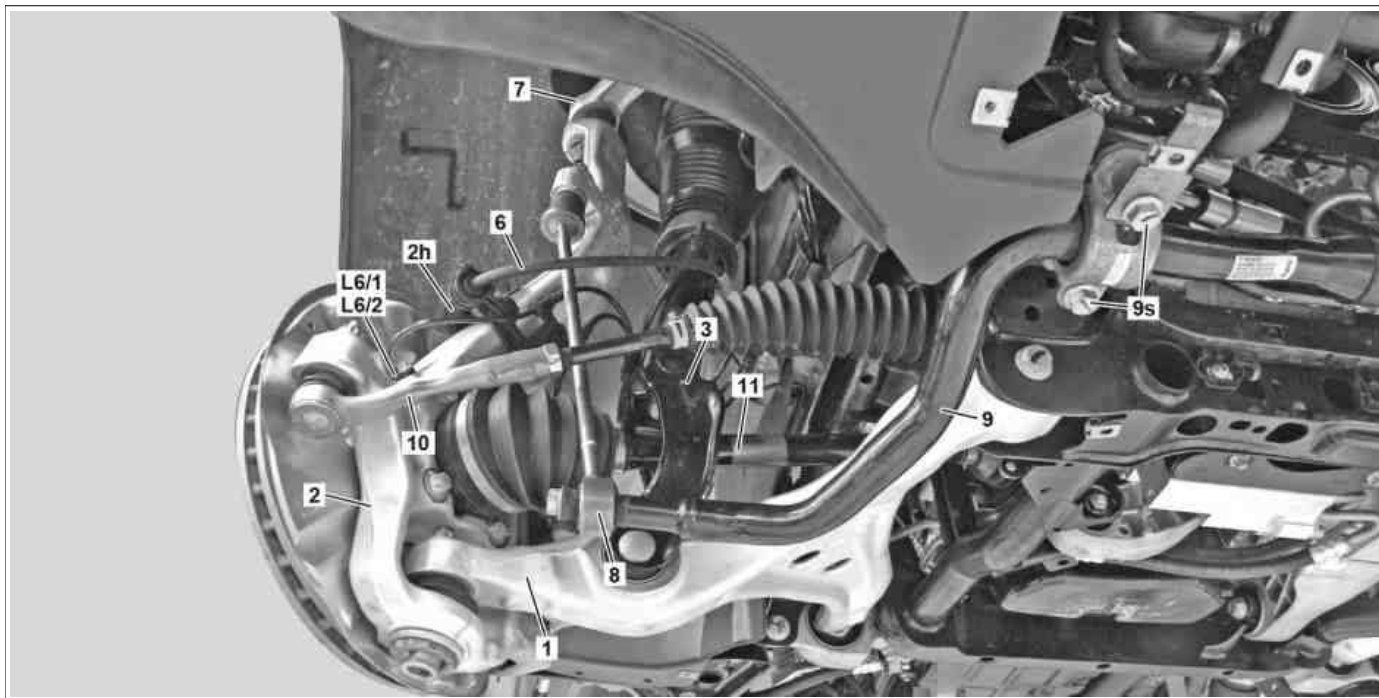

P33.10-2365-09

Shown on model 166.057

1	Lower control arm	7	Upper transverse control arm	11	Front axle shaft
2	Steering knuckle	8	Torsion bar linkage	L6/1	Left front axle rpm sensor
2h	Bracket	9	Torsion bar	L6/2	Right front axle rpm sensor
3	Suspension strut	9s	Screw		
6	Brake hose	10	Tie rod		

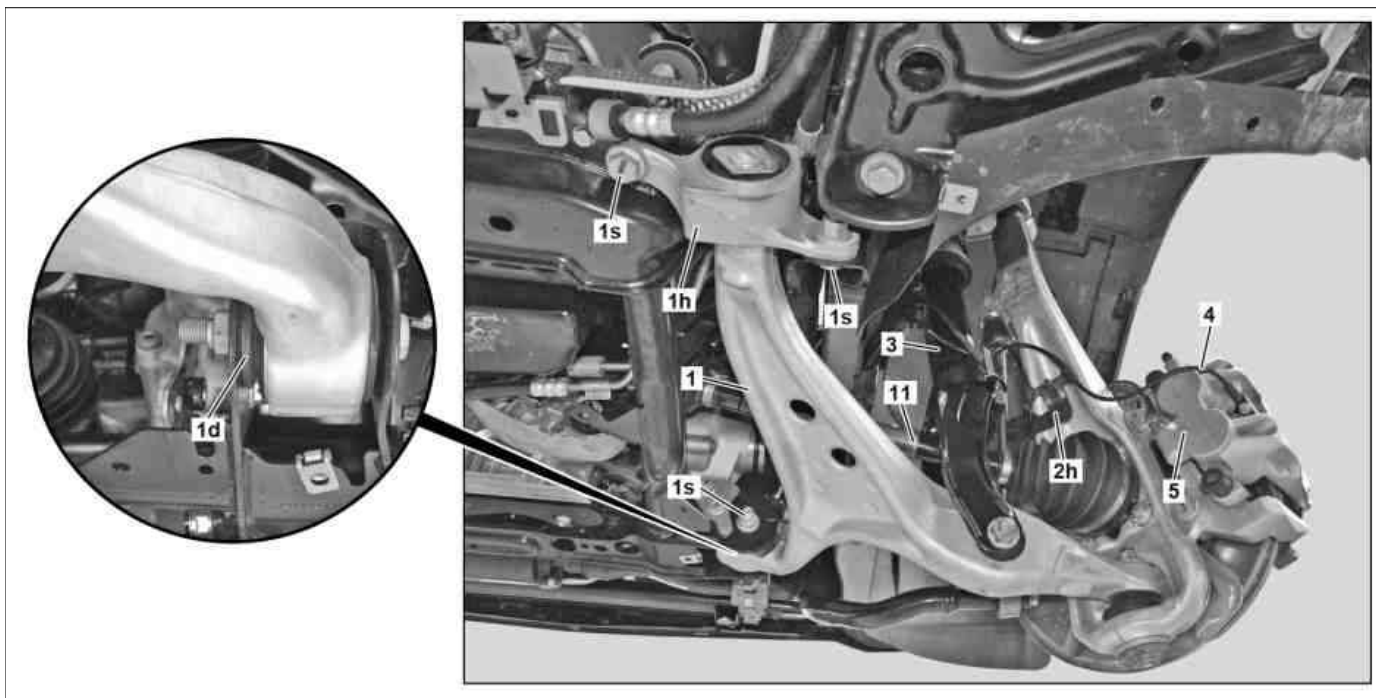

P33.10-2364-09

1 Lower control arm
 1d Shim
 1h Rear bearing bracket

1s Bolts
 2h Bracket
 3 Suspension strut

4 Electrical feed line
 5 Brake caliper
 11 Front axle shaft

Warning	Risk of injury. Moving parts can pinch, crush or, in extreme cases even sever extremities.	No parts of the body or limbs should be within the operating area of mechanical components when moving components.	AS00.00-Z-0009-01A
Warning	Risk of injury caused by pinching or crushing when working on springs or spring bodies that are under tension	Use only approved tensioning devices; additionally screen off hazardous area if necessary. Check special tools for damage and proper operation (visual inspection). Wear protective gloves.	AS00.00-Z-0001-01A
	Notes on installing brake hoses		AH42.10-P-9406-01A
	Notes on self-locking nuts and bolts		AH00.00-N-0001-01A
	Notes on repair work on suspension components		AH00.00-P-0100-01A
	Remove/install		
1	Raise vehicle using vehicle lift until the wheels are clear of the ground		AR00.60-P-1000GZ
2 	Empty AIRmatic using diagnostic system Notes on AIRmatic	Typ 166, 292 mit Code 489 (AIRMATIC) Model 166, 292 with code 489 (AIRMATIC) 	AH32.22-P-1000-02GZ AD00.00-P-2000-04A
3	Switch off ignition and store transmitter key outside of transmission range (min. 2 m)		
4 	Detach front wheel and tire assembly	Model 166 Model 292	AP40.10-P-4050EW AR40.10-P-1100GQC
5	Detach collar nut of front axle shaft (11)	Only for vehicles with 4MATIC. Collar nut, front axle shaft to front axle shaft flange	*BA33.30-P-1001-02I
6	Remove corresponding underfloor paneling		AR61.30-P-1001GQ
7	Highlight the installation position of rear bearing bracket (1h) of lower control arm (1) to front axle carrier		

8	Remove bolt of left front axle rpm sensor (L6/1) or right front axle rpm sensor (L6/2)	Self-locking bolt, rpm sensor on front axle to steering knuckle	*BA42.30-P-1001-01G
9	Remove feed line from bracket (2h) and fasten left front axle rpm sensor (L6/1) or right front axle rpm sensor (L6/2) to suspension strut (3)		
10	Remove bolt of electric feed line (4)	Electrical feed line (4) available only on right brake caliper (5). Bolt, brake pad contact sensor to brake caliper	*BA42.10-P-1004-10L
11	Detach electrical connection, remove electric feed line (4) from bracket (2h) and fasten to suspension strut (3)		
12	Remove brake hose (6) from bracket (2h)		
13	Remove brake lining	Model 166.074/874, 292.374/375 Model 166 (except 166.074/874), 292 (except 292.374/375) Do not kink brake hose (6) or subject it to tension and fasten brake caliper (5) free of tension at vehicle. Otherwise the brake hose (6) will be damaged.	AR42.10-P-1610GQA AR42.10-P-1600GQ
14	Detach torsion bar linkage (8) from torsion bar (9)	Exercise caution when detaching torsion bar linkage (8) as torsion bar (9) is under tension. Bolt, link rod to torsion bar	*BA32.20-P-1002-02Q
15	Remove bolts (9s) from torsion bar (9)	Bolt, torsion bar bracket/torsion bar to front axle carrier	*BA32.20-P-1001-02Q
16	Remove tie rod (10) from steering knuckle (2)	Self-locking nut, tie rod to steering knuckle	*BA46.40-P-1002-01K
17	Detach suspension strut (3) from lower control arm (1)	Self-locking nut, shock absorber to wishbone	*BA32.25-P-1002-01O
18	Support front-axle half and lash down securely 000 588 11 62 00 Major assembly mount 000 588 10 62 00 Support plate		WS01.00-P-0092B WS26.00-P-3309B
19	Detach steering knuckle (2) from upper transverse control arm (7)	Self-locking nut, upper ball joint out of upper transverse control arm to steering knuckle	*BA33.20-P-1001-01R
20	Push front axle shaft (11) out of wheel hub	Only for vehicles with 4MATIC. Extraction and insertion tool	*210589034300
21	Remove bolts (1s) and remove front-axle half	Installation: Align rear bearing bracket (1h) of lower control arm (1) with the marks made previously. If new parts are to be fitted, transfer the marks to the new parts so that the original installation position can be achieved as far as possible. Screw/bolt, lower transverse control arm at front to front axle carrier Nut, lower control arm at bottom rear to front axle carrier Screw/bolt, lower transverse control arm at outside rear to front axle carrier	*BA33.20-P-1004-01R *BA33.20-P-1005-01R *BA33.20-P-1007-01R
22	Install shim (1d) at position shown		
23	Install in the reverse order		
24	Perform wheel alignment check		AR40.20-P-0200GQ

Front axle torsion bar

Number	Designation		Model 166 except code 468 (ACTIVE CURVE SYSTEM)	Model 166 with code 468 (ACTIVE CURVE SYSTEM)	
BA32.20-P-1001-02Q	Bolt, torsion bar bracket/torsion bar to front axle carrier	Stage 1	Nm	100	90
		Stage 2	∠°	-	45

Front axle torsion bar

Number	Designation		Model 292 except code 468 (ACTIVE CURVE SYSTEM)	Model 292 with code 468 (ACTIVE CURVE SYSTEM)

BA32.20-P-1001-02Q	Bolt, torsion bar bracket/torsion bar to front axle carrier	Stage 1	Nm	100	90
		Stage 2	Δ°	-	45

Nm Front axle torsion bar

Number	Designation			Model 166 except code 468 (ACTIVE CURVE SYSTEM)	Model 166 with code 468 (ACTIVE CURVE SYSTEM)
BA32.20-P-1002-02Q	Bolt, link rod to torsion bar	Stage 1	Nm	80	80
		Stage 2	Δ°	90	90

Nm Front axle torsion bar

Number	Designation			Model 292 except code 468 (ACTIVE CURVE SYSTEM)	Model 292 with code 468 (ACTIVE CURVE SYSTEM)
BA32.20-P-1002-02Q	Bolt, link rod to torsion bar	Stage 1	Nm	80	80
		Stage 2	Δ°	90	90

Nm Front axle shock absorber

Number	Designation			Model 166	Model 292
BA32.25-P-1002-01O	Self-locking nut, shock absorber to wishbone	Stage 1	Nm	100	100
		Stage 2	Δ°	180	180

Nm Wheel control, hub

Number	Designation			Model 166	Model 292
BA33.20-P-1001-01R	Self-locking nut, upper ball joint out of upper transverse control arm to steering knuckle	Stage 1	Nm	100	100
		Stage 2	Δ°	45	45

Nm Wheel control, hub

Number	Designation			Model 166	Model 292
BA33.20-P-1004-01R	Screw/bolt, lower transverse control arm at front to front axle carrier	Stage 1	Nm	120	120
		Stage 2	Δ°	90	90

Nm Wheel control, hub

Number	Designation			Model 166	Model 292
BA33.20-P-1005-01R	Nut, lower control arm at bottom rear to front axle carrier	Stage 1	Nm	65	65
		Stage 2	Δ°	90	90

Nm Wheel control, hub

Number	Designation			Model 166	Model 292
BA33.20-P-1007-01R	Screw/bolt, lower transverse control arm at outside rear to front axle carrier	Stage 1	Nm	130	130
		Stage 2	Δ°	45	45

Nm Front axle shaft

Number	Designation		Model 166	Model 292		
BA33.30-P-1001-02I	Collar nut, front axle shaft to front axle shaft flange	Stage 1	Nm	250	250	
		Stage 2	Loosen	4°	180	180
		Stage 3		Nm	200	200
		Stage 4		4°	30	30

Nm Front axle brake caliper

Number	Designation		Model 166	Model 292	
BA42.10-P-1004-10L	Bolt, brake pad contact sensor to brake caliper M6		Nm	8	8

Nm Front axle rpm sensor

Number	Designation		Model 166	Model 292	
BA42.30-P-1001-01G	Self-locking bolt, rpm sensor on front axle to steering knuckle		Nm	8	10

Nm Tie rod

Number	Designation		Model 166	Model 292	
BA46.40-P-1002-01K	Self-locking nut, tie rod to steering knuckle	Stage 1	Nm	90	90
		Stage 2		4°	90

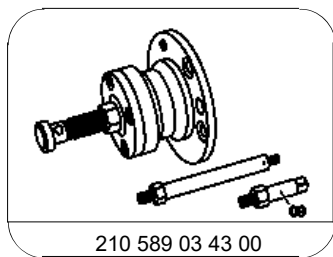

Extraction and insertion tool