

Model 167

- 1 Complete wheel
- 2 Wheel lift



P40.10-7124-12

- 1 Complete wheel
- 5 Torsion bar

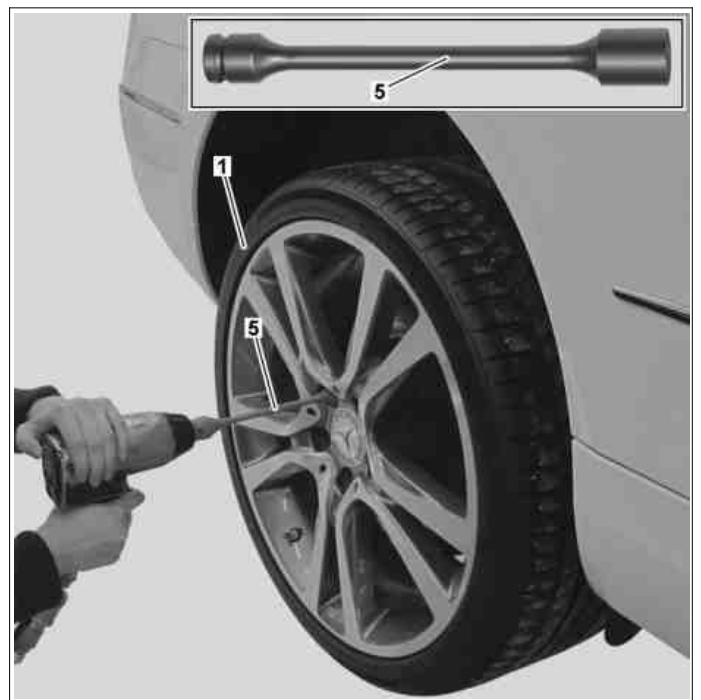

P40.10-7098-12

1 Complete wheel

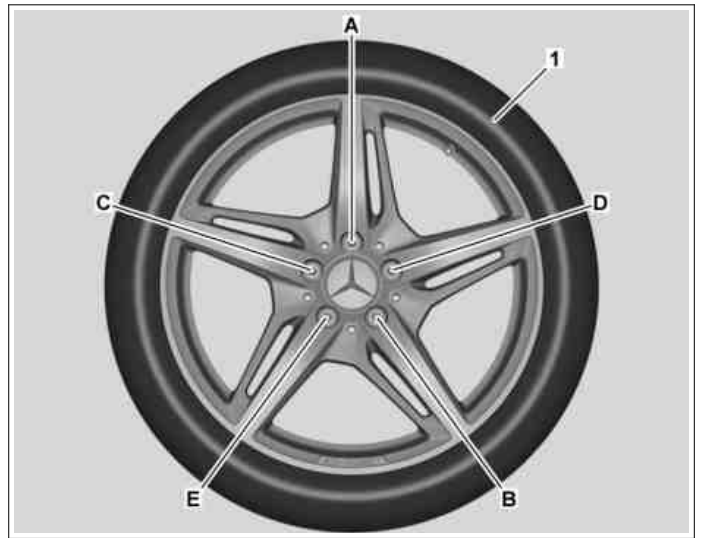

P40.10-7092-11

	Information on tires / rims		AH40.10-P-9411-01A
	Notes on handling, transport and storage of composite brake disks		AH42.10-P-9406-12LF
	Notes on safety-relevant components		AH00.00-Z-0019-01A
	<b>Remove</b>		
1	Raise vehicle.		AR00.60-P-1006A
2	Remove wheel trims.	If installed.	
3	Remove wheel and tire assemblies (1).	<p> <b>Only for</b> </p> <p>Use a wheel lift dolly (2) with a rim size from 17".</p> <p> Socket wrench</p>	*199589010900
	<b>Check</b>		
4	Check components of wheel threaded connection.	<p> Before mounting a wheel and tire assembly (1), remove minor soiling using a rag.</p> <p>Apply heat-resistant lubricating paste sufficiently on wheel hub.</p> <p>Paste, hot lubrication 1 kg, DBL 6879.20</p> <p>If problems occur,</p> <p style="text-align: center;">↓</p> <p>clean components of wheel threaded connection and protect against corrosion.</p> <p>If enough soiling is present,</p> <p style="text-align: center;">↓</p> <p>carry out further cleaning and anti-corrosion protection measures.</p>	*BR00.45-Z-1005-06A
5	Check tires of wheel and tire assemblies (1) for wear and damage.	On the wheel and tire assemblies (1) to be installed.	AR40.10-P-1100-02A
			AP40.10-P-4051EW
	<b>Install</b>		
6	Install wheel and tire assemblies (1).	<p> <b>Only for</b> </p> <p>Use a wheel lift dolly (2) with a rim size from 17".</p> <p> <b>Commercially available devices/tools</b></p> <p>Use torsion bar (5) with 75 Nm for 2nd stage (initial torque).</p> <p> Observe tightening sequence "A, B, C, D, E" and the multistage tightening torque of the wheel bolts.</p> <p> Wheel bolt</p> <p> Socket wrench</p>	*BA40.10-P-1001-01O *199589010900
7	Install wheel trims.	<p>If installed.</p> <p></p> <p>Check for firm seating of wheel trim on rim and for correct positioning of wheel trim relative to valve.</p> <p>Otherwise, there is a risk of losing the wheel trim or of damaging the valve.</p>	

8 AP	Check tire pressure on wheel and tire assemblies (1).	Only when changing tire.  In the event of a problem, ↓ correct tire pressure on wheel and tire assemblies (1).	AP40.15-P-4061A
9 AP	Restart tire pressure monitor (TPM) or tire pressure loss warning via the instrument cluster.	Only when changing tire.	AP40.15-P-4069U
10	Check maximum speed limitation in instrument cluster, correct if necessary. Limited maximum speed for winter tires with speed index V Information about regulations for recommended wheel/tire combinations	Only when changing tire.  <b>i</b> Note tire speed rating. If the maximum permissible speed of an M+S tire is lower than the maximum permissible speed of the vehicle. ↓ Apply corresponding adhesive label in the driver's visual field.	AH40.10-P-1020-03A  AH40.10-P-0003-01A

**Nm** Wheels

Number	Designation	Model 167
BA40.10-P-1001-01O	Wheel bolt	Stage 1 (position by hand) Nm -
		Stage 2 (initial torque) Nm 75
		Stage 3 Nm 150

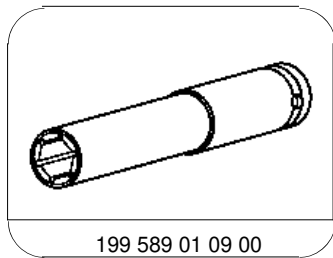

199 589 01 09 00

Socket wrench

**Repair materials**

Number	Designation	Order number
BR00.45-Z-1005-06A	Paste, hot lubrication 1 kg, DBL 6879.20	A 000 989 76 51