

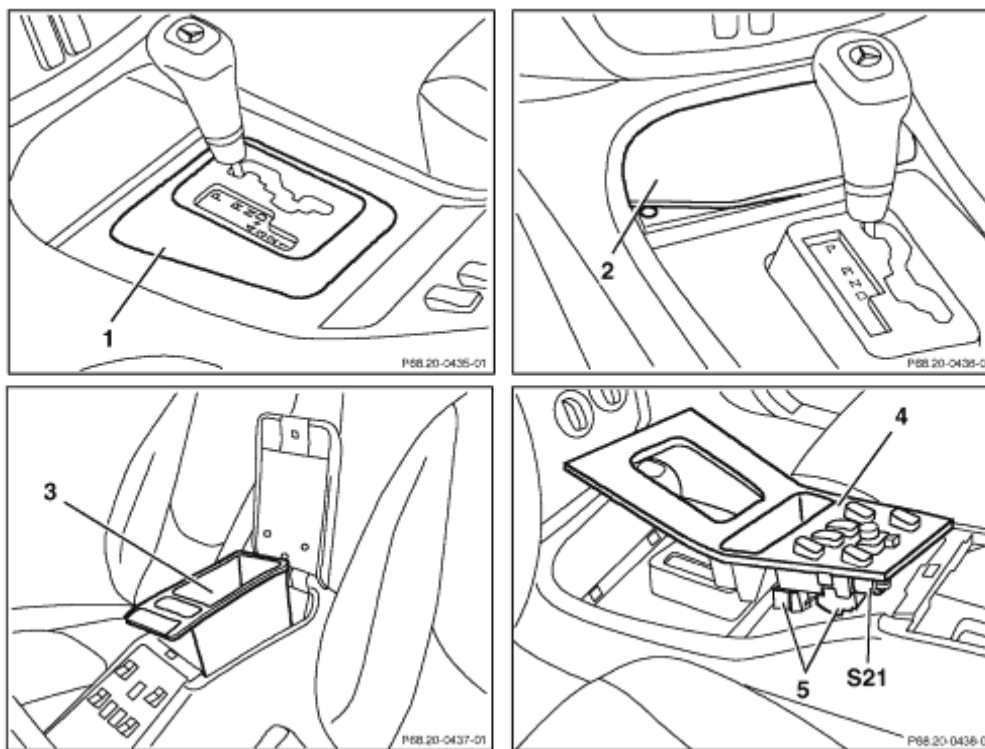



AR68.20-P-2310GH	Removing and installing cover at gearshift lever	4.2.97
------------------	--	--------



**MODEL 163.154 /172 /174 up to 31.8.01**

- 1 Plastic frame
- 2 Covering in front stowage compartment
- 3 Center console insert
- 4 Cover
- 5 Connectors
- S21 Center console switch group

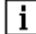

P68.20-0434-06

 	Remove/install		
1	Remove plastic frame (1) upward		<a href="tel:115589035900">115 589 03 59 00</a>
2	Remove covering in stowage compartment (2)	 Fastened with pin.	

3	Remove center console insert (3)	 Remove screws (2 each) from insert floor	
4	Press cover (4) out of catch in center console at rear and sides with long wedge		<a href="#">115 589 03 59 00</a>
5	Disconnect connectors (5) from center console switch group (S21)		
6	Install in the reverse order		

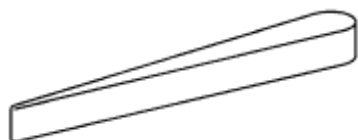

115 589 03 59 00

Long wedge