

AR33.25-P-0400GH

Removing and installing steering knuckle

10.3.97

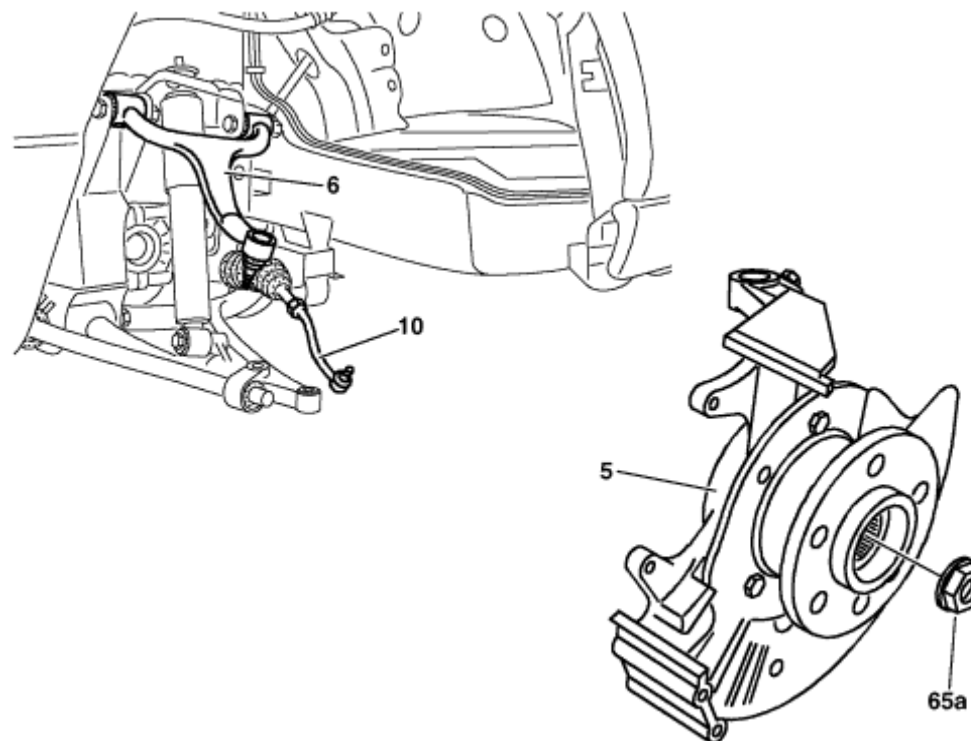





MODEL 163

Shown on vehicle with floating caliper

P33.25-0245-06

	Remove/Install		
	Notes on self-locking nuts and bolts	All models	AH00.00-N-0001-01A
1	Remove front wheels		
	Remove/install wheels, rotate if		AP40.10-P-4050GH

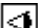
	necessary		
2	Detach collar nut (65a) from front axle shaft	i Installation: Replace collar nut (65a)	
		Nm	BA33.30-P-1001-02B
3	Unclip cables for speed sensor and brake lining wear indicator from guides	i Installation: Pay attention to correct line routing.	
4	Remove brake disc	i Model 163.154 up to VIN A289564, models 163.154 /157 with USA version, code 494a	AR42.10-P-0220GH
		i Model 163.154 as of FIN A289565, 163.172 /174 /175, models 163.154 /157 except USA version, code 494a	AR42.10-P-0220GI
5	Remove rpm sensor with bracket from steering knuckle		AR42.30-P-0712GH
6	Detach tie rod (10) from steering knuckle	i Check rubber boot and ball joint for wear and damage.	AR46.40-P-0200-02C
		Nm	BA46.40-P-1001-01C
		S Thrust piece	140 589 00 63 00
		S Puller	202 589 02 33 00
7	Press out follower joint from upper transverse control arm (6) using puller	i Check rubber boot and ball joint for wear and damage.	AR33.20-P-0500-01GH
		Nm	BA33.20-P-1001-01D
		S Thrust piece	129 589 10 63 00
		S Support	163 589 01 43 00
		S Press	163 589 03 43 00
8	Press front axle shaft out of front axle		AR33.30-P-0620-

	shaft flange		04GH
		 Extraction and insertion tool	210 589 03 43 00
9	Press supporting joint off lower wishbone	 Secure steering knuckle to prevent it from falling down, in order to rule out damage to the steering knuckle  Check rubber boot and ball joint for wear and damage.	AR33.20-P-0440-02GH
		 Nm	BA33.20-P-1002-01D
		 Thrust piece	140 589 00 63 00
10	Remove steering knuckle (5) forwards		
	Check		
11	Check supporting joint		
 AP	Inspect front axle joint for play, inspect rubber boots		AP33.20-P-3353GH
12	Install in the reverse order		
13.1	Perform chassis alignment check	 After installation of new parts.	AR40.20-P-0200GH

 **Wheel location, hub**

Number	Designation		Model 163
BA33.20-P-1001-01D	Self-locking nut, upper wishbone follower joint to steering knuckle	Nm	50 = 37 ft. lbs
BA33.20-P-1002-01D	Self-locking nut, supporting joint to steering knuckle	Nm	85 = 63 ft. lbs.

 **Front axle shaft**

Number	Designation		Model 163

BA33.30-P-1001-02B	Nut, front axle shaft to front axle shaft flange	Nm	490 = 362 ft. lbs.
--------------------	--	----	--------------------

Nm Track rod

Number	Designation	Model 163	
BA46.40-P-1001-01C	Self-locking nut, tie rod to steering knuckle	Nm	55 = 41 ft. lbs.

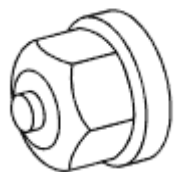

140 589 00 63 00

Thrust piece

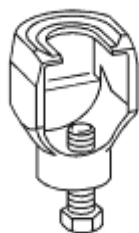

202 589 02 33 00

Puller

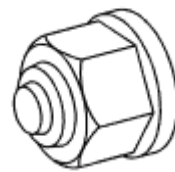

129 589 10 63 00

Thrust piece

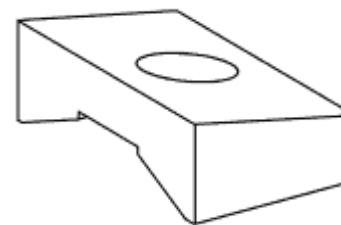

163 589 01 43 00

Support

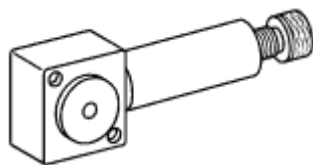

163 589 03 43 00

Press

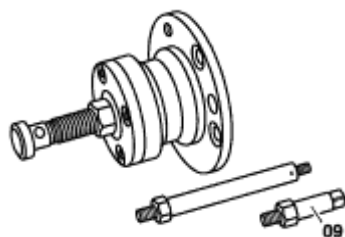

210 589 03 43 00

Extraction and installation tool