

AR35.20-P-0117GH	Removing/installing supporting joint on wheel carrier (wheel carrier removed)	5.3.97
------------------	---	--------

MODEL 163

If you are going to install Moog ball joints a Dana, 60 series, 4 prong socket will be needed.

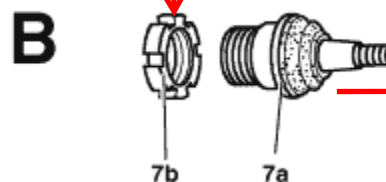
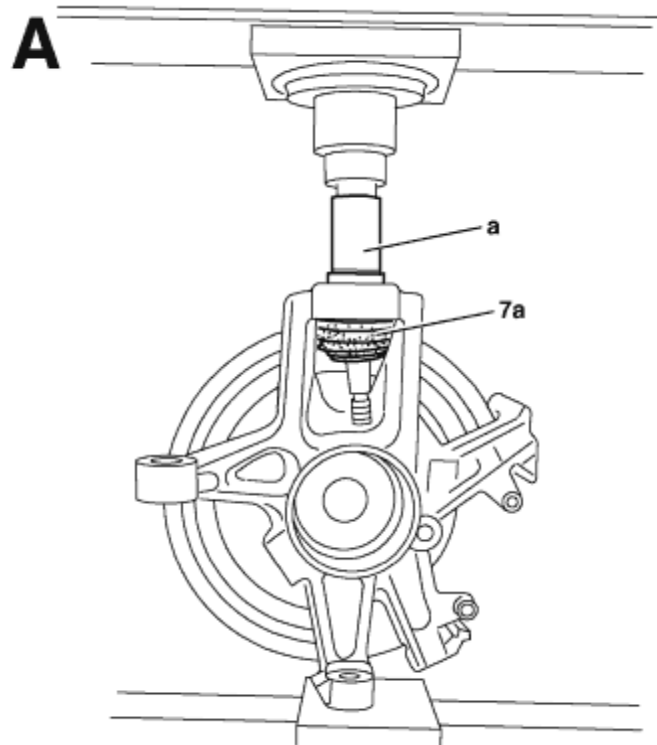

OTC part # 7158
or
Powerbuilt 648477

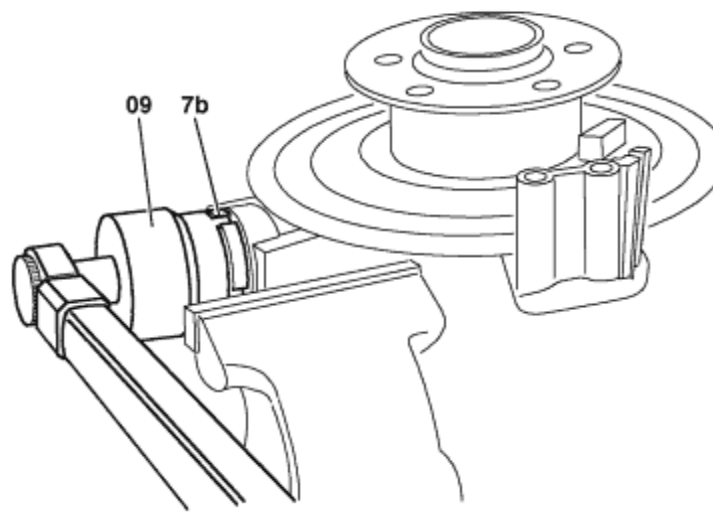

P35.20-0284-09

	Remove		
1	Remove wheel carrier		AR35.20-P-0115GH
2.1	Press out supporting joint (7a) on the press using a suitable drift punch (a)	When removing for the first time (A).	
2.2	Unscrew locking slotted round nut (7b)		

	using claw-type wrench (09)	i When supporting joint has been replaced (B).	
		S Claw-type wrench	385 589 00 07 00
⊠	Install		
3	Insert supporting joint (7a) and tighten locking slotted round nut (7b) using claw-type wrench (09)	i Observe accurate abutment. Once used, the locking slotted round nut must be replaced.	
		Nm	BA35.20-P-1005-07A
		S Claw-type wrench	385 589 00 07 00
4	Install wheel carrier		AR35.20-P-0115GH

Nm Wheel location

Number	Designation		Model Series 163
BA35.20-P-1005-07A	Locking slotted round nut, supporting joint to wheel carrier (replacement part)	NM	300 = 221 ft. lbs.



385 589 00 07 00

Prong wrench