

**Chassis and Drivetrain**

35

**Rear Axle****System Description**

The open rear differential is a typical ring and pinion design. The housing is mounted in the rear subframe and supported by rubber mounts. The final drive ratio of the rear axle is 3.70:1.

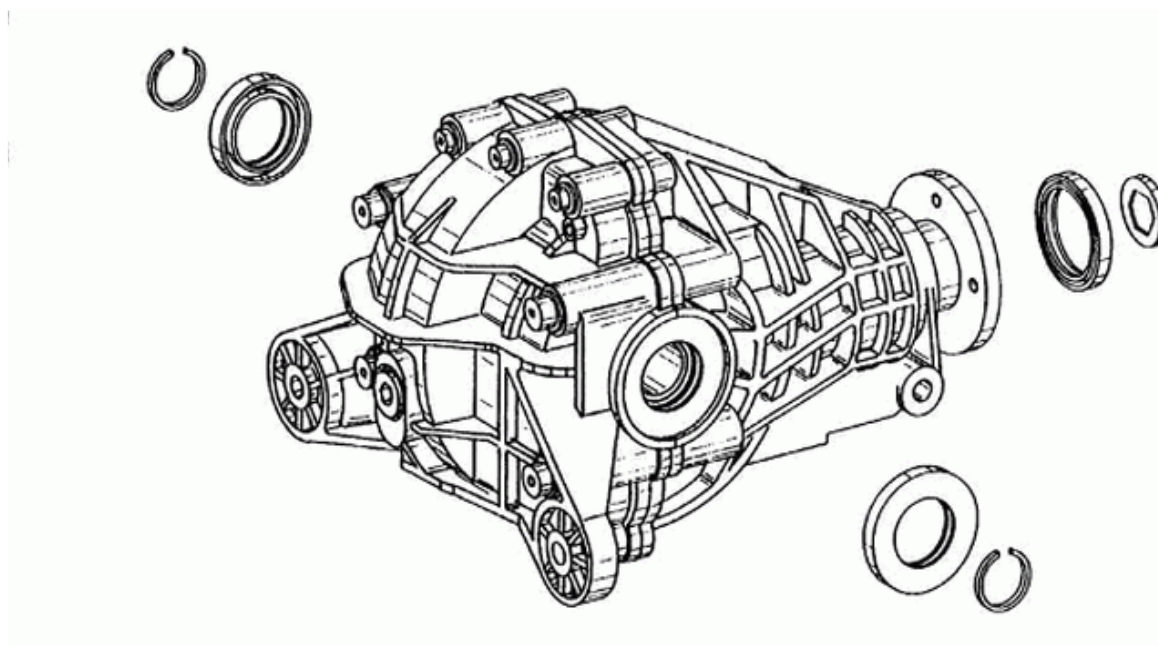

MBSI.35-0001

**Component Description****Rear Differential/Axle Assembly**

The aluminum rear axle carrier contains equal length drive axles. The articulated half shafts use the same type of constant velocity joints at the carrier housing as the front axle.

**Axle Shafts (half shafts)**

The design is the same as the front half shafts. See description in Group 33.

**Service Tips**

The rear axle holds 1.6 quarts of hypoid gear oil. SAE 90 - 85W/90