

16 Side step bar

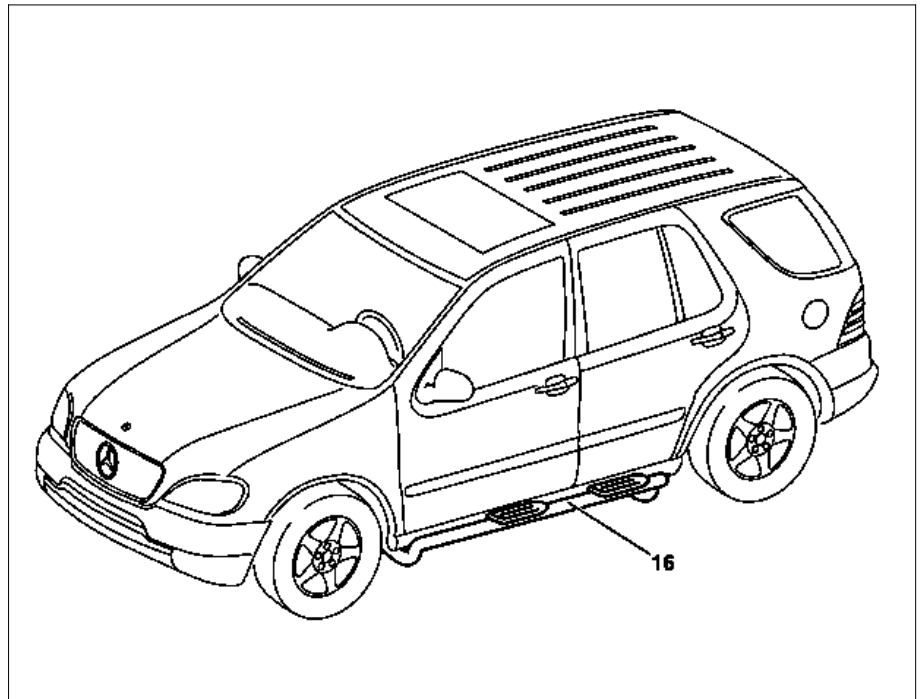

P88.30-2172-06

- 1 Side step bar bracket, front
- 2 Body mount bracket
- 3 Screw
- 4 Washer
- 5 Spacer
- 6 Screw
- 7 Washer
- 8 Side step bar bracket, rear
- 9 Body mount bracket
- 10 Screw
- 11 Washer
- 12 Screw
- 13 Washer
- 14 Tab
- 15 Slot
- 16 Side step bar
- 17 Screw
- 18 Washer
- 19 Angled support bracket

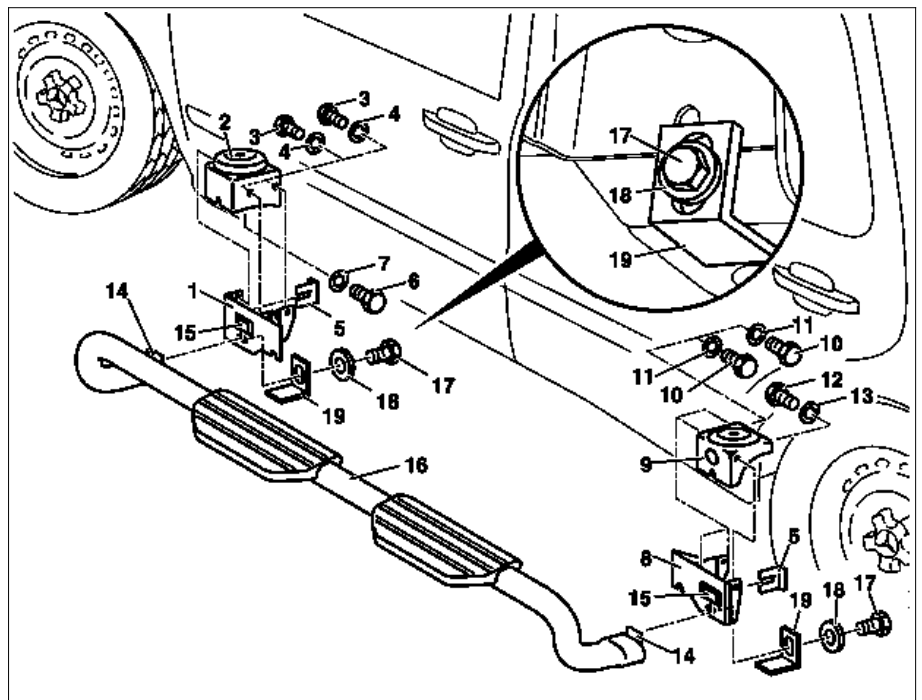

P88.30-2173-06

☒	Remove		
⚠ Danger!	Lethal injuries are possible if vehicle slips off of lifting platform	Align vehicle between lifting platform columns and position the four hoisting plates beneath the lifting platform mounting points specified by the vehicle manufacturer.	AS00.00-Z-0010-01A
1 ➡ AR	Place vehicle on lift		AR00.60-P-1000GH
2	Remove front and rear underride stone shields		
	Modify		
3	Modify rear underride stone shields		AZ88.30-P-0006-01GH
☒	Install		
4	Install front and rear underride stone shields		

5	Place side step bar front bracket (1) into position over body mount bracket (2)	i Bracket stamped with 3600.	
6	Secure side step bar front bracket (1) to body mount bracket (2) with bolts (3) and washers (4)	i Only on rear side of bracket (1). Nm	*BA88.30-P-1017-01A
7	Insert spacer plate (5) between side step bar front bracket (1) and body mount bracket (2)	i Only if gap present between side step bar bracket and body mount bracket. Nm	
8	Secure side step bar front bracket (1) to body mount bracket (2) with bolt (6) and washer (7)	Nm	*BA88.30-P-1017-01A
9	Place side step bar rear bracket (8) into position over body mount bracket (9)	i Bracket stamped with 3700.	
10	Secure side step bar rear bracket (8) to body mount bracket (9) with bolts (10) and washers (11)	i Only on front side of bracket (8). Nm	*BA88.30-P-1017-01A
11	Insert spacer plate (5) between side step bar rear bracket (8) and body mount bracket (9)	i Only if gap present between side step bar bracket and body mount bracket. Nm	
12	Secure side step bar rear bracket (8) to body mount bracket (9) with bolt (12) and washer (13)	Nm	*BA88.30-P-1017-01A
13	Insert tabs (14) on side step bar front and rear attachment points into slots (15) in front and rear mounting brackets (1, 8)		
14	Align side step bar (16) evenly with rocker panel		
15	Secure side step bar (16) to mounting brackets (1, 8) with bolt (17) and washer (18)	i Insert angled support bracket (19) between mounting brackets (1, 8) and washers (18). Ensure angled support bracket (19) is flush against mounting brackets and bottom of side step bar. Nm	*BA88.30-P-1018-01A
16	Repeat for opposite side		

Nm Detachable body components, underride guard

Number	Designation		Model 163 up to 31.8.01	Model 163 as of 1.9.01
BA88.30-P-1017-01A	Bolt, side bar bracket with/without step to body support	Nm	65	65
BA88.30-P-1018-01A	Bolt, side bar with/without step to mounting plate	Nm	38	38

Parts ordering notes

Part no.	Designation	Quantity
B6 688 0201	Side step bars, polished (USA, CDN)	1
B6 688 0202	Side step bars, black (USA, CDN)	1
B6 688 0204	Side step bars, polished (ECE)	1