

AR30.10-P-1010GJ

Adjust throttle control

27.2.97

ENGINE 112.942 #2 in MODEL 163.154

ENGINE 112.970 #2 in MODEL 163.157

ENGINE 113.942 #2 in MODEL 163.172

ENGINE 113.981 #2 in MODEL 163.174

ENGINE 113.965 #2 in MODEL 163.175

Shown on Engine 112.942 in Model 163.154

24 Accelerator pedal

31/1 Relay lever position sensor

32 Control cable

32/2 Adjusting bolt

32/3 Adjusting bolt

A Idle speed



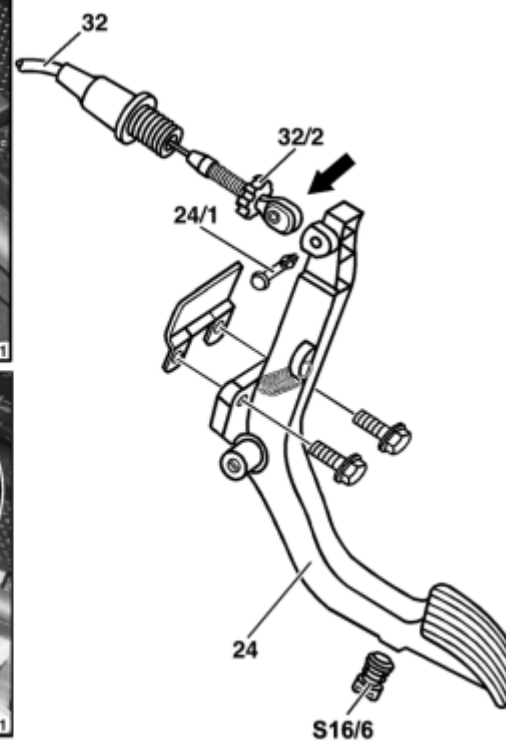
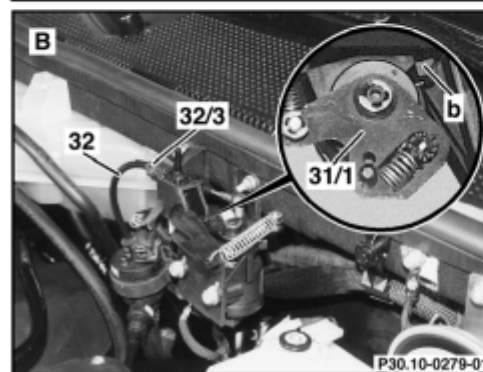
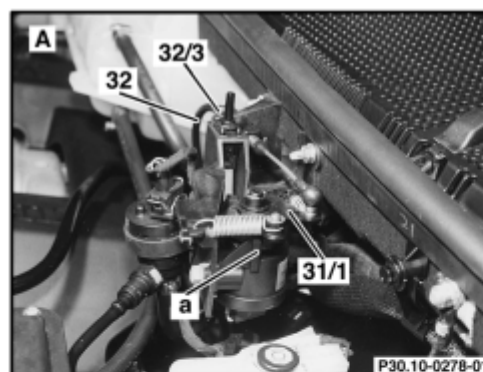

B Full throttle

S16/6 Kickdown switch

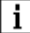

P30.10-0286-06

	Inspection		
1	Check ease of movement and condition	 Replace parts if necessary.	

	of relay lever position sensor (31/1) and control cable (32)		
	Setting		
2	Depress accelerator (24) until it rests against the kickdown switch (S16/6)	<p> Full throttle position.</p> <p> Do not operate kickdown switch (S16/6)!</p>	
3	Twist adjusting screw (32/3) until relay lever position sensor (31/1) rests against full throttle stop (b)	 Do not overstretch control cable (32).	
4	The relay lever position sensor (31/1) must rest against the closed throttle stop (a) when the accelerator pedal is relieved	 Closed throttle position.	
5	Twist adjusting nut (32/2) until relay lever position sensor (31/1) rests against closed throttle stop (a) or until there is no more accelerator pedal free travel		
	Inspection		
6	Check full throttle and closed throttle positions		